



**CATALOGUS: FREROX**

**PLASTIC PARTS FOR ELECTRICAL EQUIPMENT**

**FREROX ELECTRONICS**

**12**

**SPECIAL VALUE**



**PLUG-LOCKER**

**SWPL-1**

MATERIAL: NYLON 66 (UL)  
 FLAME CLASS: 94V-2  
 COLOR: BLACK  
 UNIT: mm

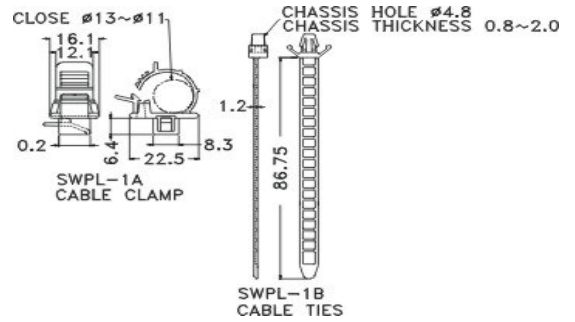

PARTNO	PACKAGE
SWPL-1	200



**STRAP TIE ELASTIC VERSION**

**ST-6**

MATERIAL: T.P.E  
 COLOR: BLUE  
 UNIT: mm

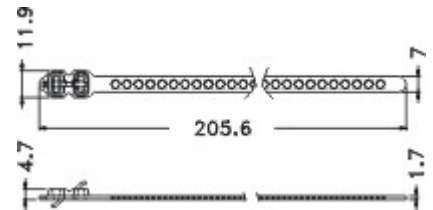

PARTNO	PACKAGE
ST-6	500



**MAGNET**

**MGFF-1**

METAL COVER MATERIAL: STEEL  
 MAGNET COLOR: BLACK  
 UNIT: mm

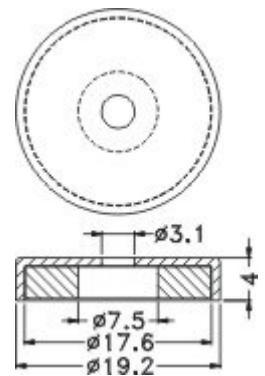

PARTNO	PACKAGE
MGFF-1	500



**LINEAR DAMPER**

**DP009A**

GEAR MATERIAL:P.O.M(UL)94HB  
 BODY MATERIAL:NYLON 66 UL94V-2  
 COLOR:BLACK  
 UNIT:mm

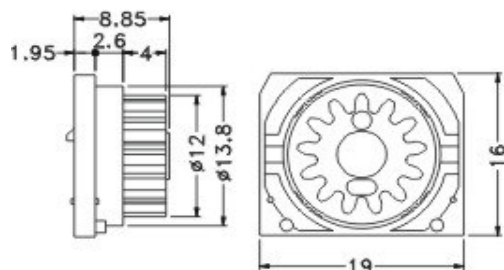

PART NO	PACKAGE
DP009A	500

MODULE	0.8
PITCH CIRCLE DIAMETER	∅10.4
TOOTH NUMBER	13
PRESSURE ANGLE	20°

**LINEAR DAMPER**

**DP008A**

GEAR MATERIAL:P.O.M(UL)94HB  
 BODY MATERIAL:A.B.S(UL)94HB  
 COLOR:BLACK  
 UNIT:mm

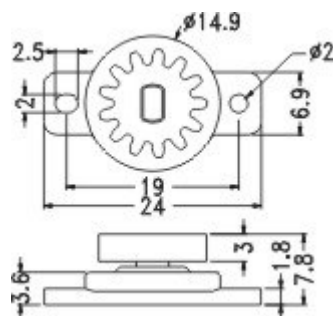

PART NO	PACKAGE
DP008A	500

MODULE	0.8
PITCH CIRCLE DIAMETER	∅10.4
TOOTH NUMBER	13
PRESSURE ANGLE	20°

**COVER**

**PLC-1**

MATERIAL:PE+EVA  
 COLOR:YELLOW  
 UNIT:mm

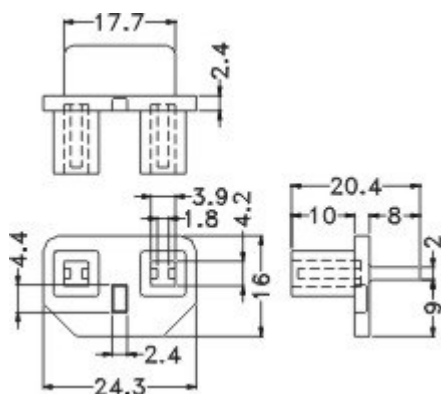

PART NO	PACKAGE
PLC-1	500



**LINEAR DAMPER**

**DP003A**

GEAR MATERIAL:P.O.M(UL)94HB  
 BODY MATERIAL:A.B.S(UL)94HB  
 COLOR:BLACK  
 UNIT:mm

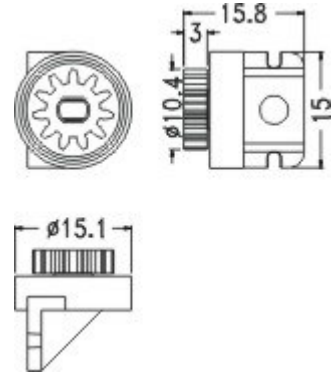

PART NO	PACKAGE
DP003A	500

MODULE	0.8
PITCH CIRCLE DIAMETER	ø8.8
TOOTH NUMBER	11
PRESSURE ANGLE	20°



**LINEAR DAMPER**

**DP002A**

GEAR MATERIAL:P.O.M(UL)94HB  
 BODY MATERIAL:A.B.S(UL)94HB  
 COLOR:BLACK  
 UNIT:mm

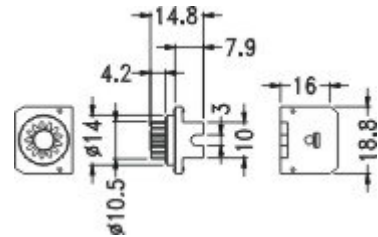

PART NO	PACKAGE
DP002A	500

MODULE	0.7
PITCH CIRCLE DIAMETER	ø9.1
TOOTH NUMBER	13
PRESSURE ANGLE	20°

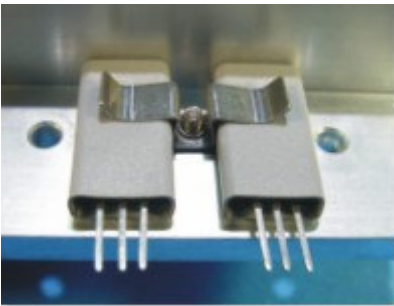

**TRANSISTOR CLIP**

**TRK-10**

MATERIAL:STEEL  
 UNIT:mm

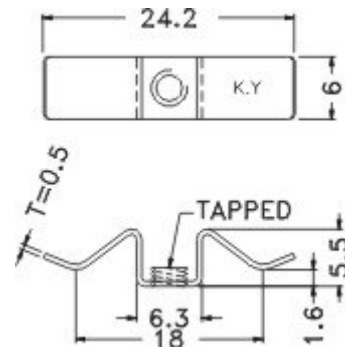

PART NO.	TAPPED	PACKAGE
TRK-10	M3X0.5	1000
TRK-10(632)	6-32 UNC	

**LINEAR DAMPER****DP007A**

GEAR MATERIAL:P.O.M(UL)94HB

BODY MATERIAL:A.B.S(UL)94HB

COLOR:BLACK

UNIT:mm

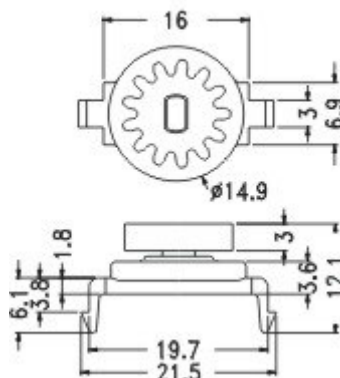

PART NO	PACKAGE
DP007A	500

MODULE	0.8
PITCH CIRCLE DIAMETER	∅10.4
TOOTHNUMBER	13
PRESSURE ANGLE	20°

**LINEAR DAMPER****DP006A**

GEAR MATERIAL:P.O.M(UL)94HB

BODY MATERIAL:A.B.S(UL)94HB

COLOR:BLACK

UNIT:mm

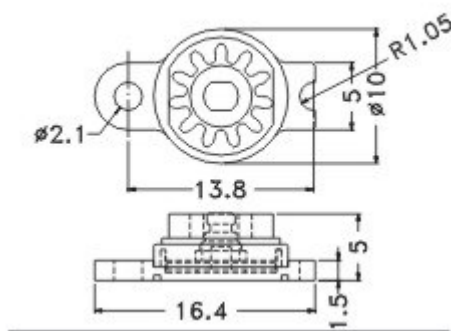

PART NO	PACKAGE
DP006A	500

MODULE	0.6
PITCH CIRCLE DIAMETER	∅6.6
TOOTHNUMBER	11
PRESSURE ANGLE	20°

**LINEAR DAMPER****DP004A**

GEAR MATERIAL:P.O.M(UL)94HB

BODY MATERIAL:PC

COLOR:BLACK

UNIT:mm

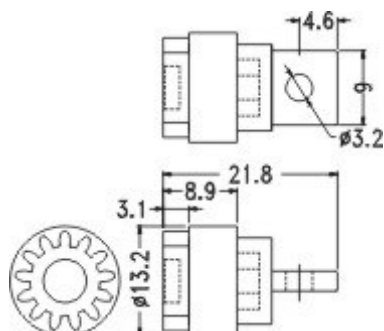

PARTNO	PACKAGE
DP004A	500

MODULE	0.8
PITCH CIRCLE DIAMETER	∅10.4
TOOTHNUMBER	13
PRESSURE ANGLE	20°



**FINGER SCREW**

**GPE4-8**

HEAD MATERIAL:ABS(UL)  
 COLOR:NATURAL  
 UNIT:mm

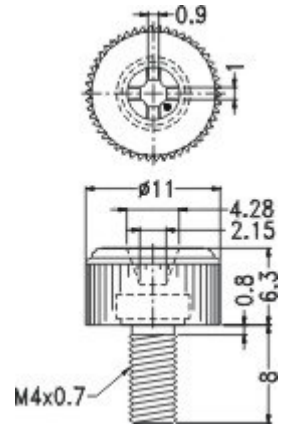

PART NO	PACKAGE
GPE4-8	1000



**SHOLDER SCREW**

**TGM**

MATERIAL:STEEL  
 FINISH:NICKEL-PLATING  
 UNIT:mm

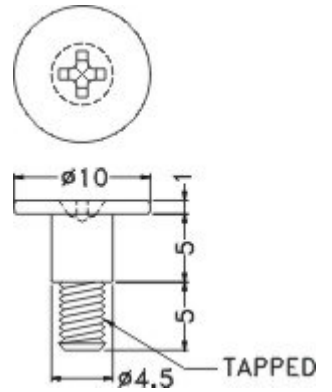

PART NO.	TAPPED	PACKAGE
TGM3-10	M3	1000
TGM632-10	6-32 UNC	



**SHOLDER SCREW**

**TGM-13SW**

MATERIAL:STEEL  
 FINISH:NICKEL-PLATING  
 UNIT:mm

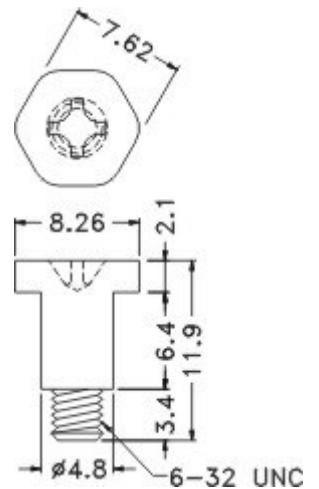

PARTNO	PACKAGE
TGM-13SW	1000

**SHOLDER SCREW**

**TGM-10SW**

MATERIAL:STEEL  
FINISH:NICKEL-PLATING  
UNIT:mm

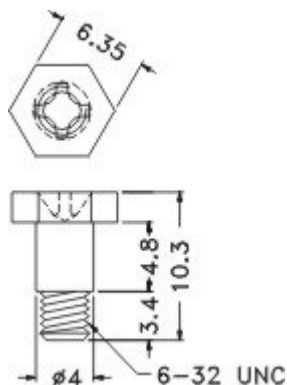

PARTNO	PACKAGE
TGM-10SW	1000

**SPIRAL TUBE**

**SWB**

MATERIAL:PE  
COLOR:NATURAL  
UNIT:mm

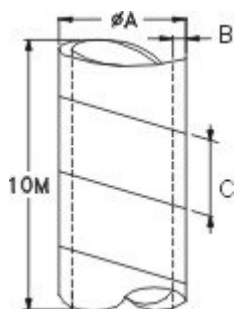

PARTNO	A	B	C	PACKAGE
SWB-4S	5.0	0.5	5.5	10M
SWB-4	6.0	0.6	8.0	
SWB-6	8.0	0.6	10.0	
SWB-7.5	10.0	0.7	12.0	
SWB-9	12.0	0.7	15.0	
SWB-12	15.0	0.8	18.0	
SWB-16	19.0	1.0	21.0	
SWB-20	24.0	1.2	24.0	

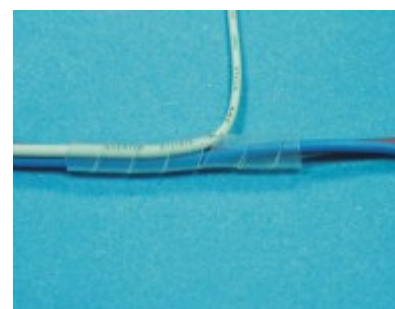

**TRANSISTOR CLIP**

**TO-220ST**

MATERIAL:SUS304  
FLAME CLASS:SILVER  
UNIT:mm

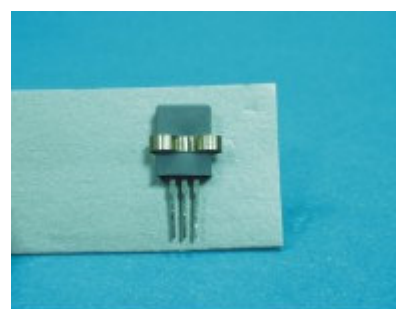
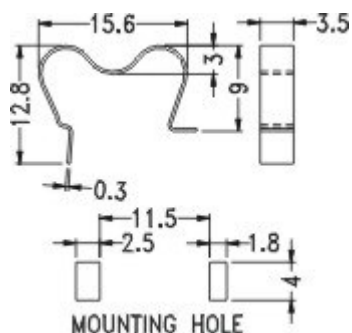

PARTNO	PACKAGE
TO-220ST	1000