



**CATALOGUS: FREROX**

**PLASTIC PARTS FOR ELECTRONICAL EQUIPMENT**

**FREROX ELECTRONICS**

**11**

**ANTI NOISE AND VIBRATION**

**PARTS**

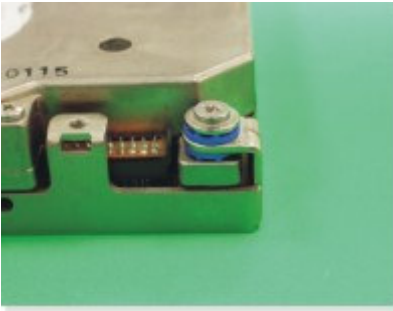

**HDD DAMPER (NOISE- AND VIBRATION DAMPER)**

**SYD 1031**

MATERIAL:TPE  
 COLOR:BLUE/YELLOW/PURPLE  
 UNIT:mm

HARDNESS SHORE : 45–55–65 A

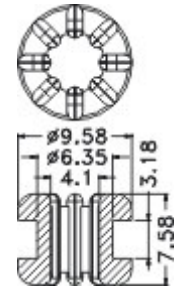

PARTNO	PACKAGE
SYD 1031	1000

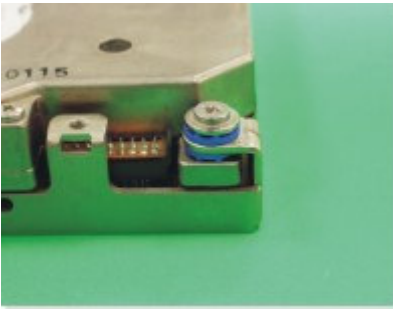

**MINI HDD DAMPER (NOISE- AND VIBRATION DAMPER)**

**SYD 0515**

MATERIAL:TPE  
 COLOR:BLUE/YELLOW/PURPLE  
 UNIT:mm

HARDNESS SHORE : 45–55–65 A

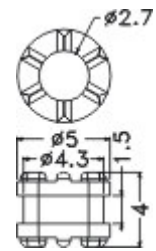

PARTNO	PACKAGE
SYD 0515	1000

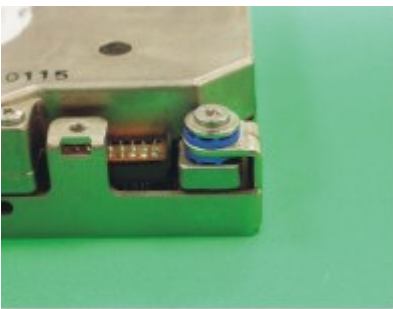

**HDD DAMPER (NOISE- AND VIBRATION DAMPER)**

**SYD 1416 (HEAVY LOAD)**

MATERIAL:TPE  
 COLOR:BLUE/YELLOW/PURPLE  
 UNIT:mm

HARDNESS SHORE : 45–55–65 A

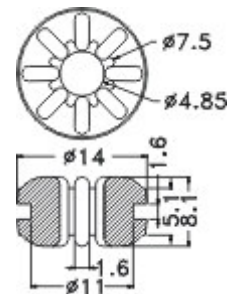

PARTNO	PACKAGE
SYD 1416	1000

**HDD DAMPER ( NOISE- AND VIBRATION DAMPER )**

**SYD 1416**

MATERIAL:TPE  
 COLOR:BLUE/YELLOW/PURPLE  
 UNIT:mm

HARDNESS SHORE : 45–55–65 A

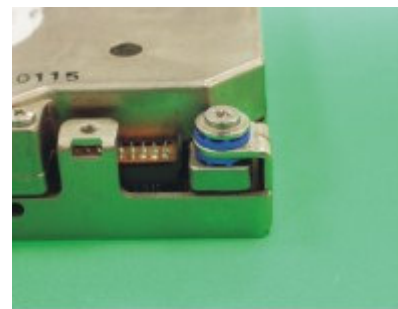
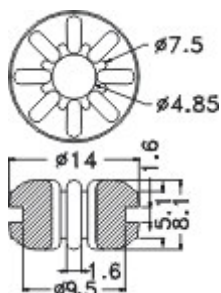

PARTNO	PACKAGE
SYD 1416	1000

**HDD DAMPER ( NOISE- AND VIBRATION DAMPER )**

**SYD 1015**

MATERIAL:TPE  
 COLOR:BLUE/YELLOW/PURPLE  
 UNIT:mm

HARDNESS SHORE : 45–55–65 A

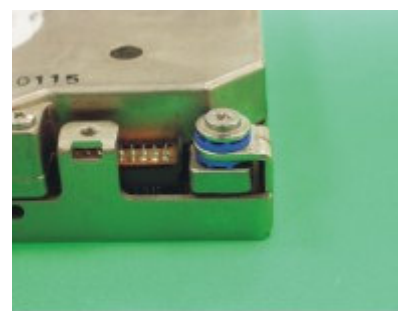
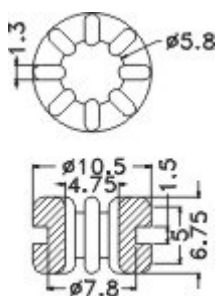

PARTNO	PACKAGE
SYD 1015	1000

**HDD DAMPER ( NOISE- AND VIBRATION DAMPER )**

**SYD 1108**

MATERIAL:TPE  
 COLOR:BLUE/YELLOW/PURPLE  
 UNIT:mm

HARDNESS SHORE : 45–55–65 A

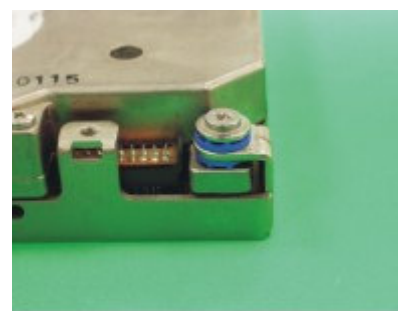
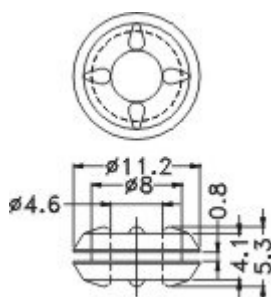

PARTNO	PACKAGE
SYD 1108	1000





**HDD DAMPER (NOISE- AND VIBRATION DAMPER)**

**SYD 1016**

MATERIAL:TPE  
 COLOR:BLUE/YELLOW/PURPLE  
 UNIT:mm

HARDNESS SHORE : 45–55–65 A

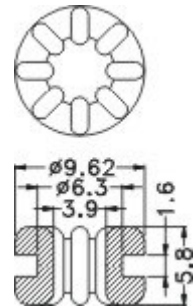

PARTNO	PACKAGE
SYD 1016	1000

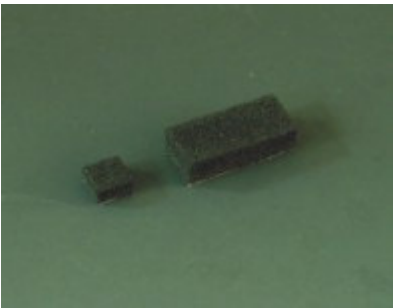

**EVA FOAM**

**EVA120430**

MATERIAL:EVA  
 COLOR:BLACK  
 UNIT:mm

NOISE ABSORBTION

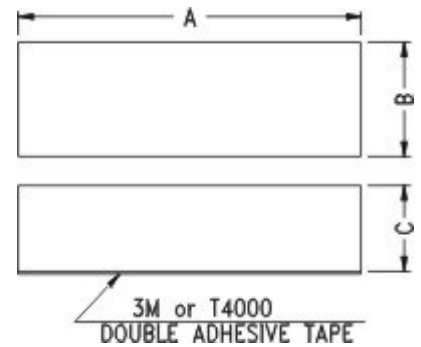

PART NO.	A	B	C
EVA120430	12	4.0	3.0



**PUSH RIVET**

**FSP-4**

PIN MATERIAL:NYLON 66(UL)94V-2  
 BODYMATERIAL:T.P.E  
 COLOR:BLACK  
 UNIT:mm

NOISE REDUCING

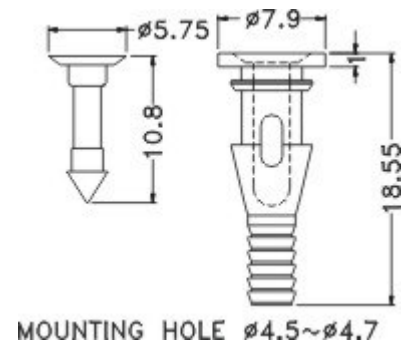

PARTNO	PACKAGE
FSP-4	1000



**PUSH RIVET**

**FSP-3**

MATERIAL:NYLON 66(UL)94V-2  
 BODYMATERIAL:T.P.E  
 COLOR:BLACK  
 UNIT:mm

NOISE REDUCING

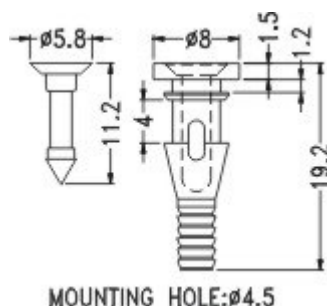

PARTNO	PACKAGE
FSP-3	1000

**PUSH RIVET**

**FSP-2**

MATERIAL:NYLON 66(UL)94V-2  
 BODYMATERIAL:T.P.E  
 COLOR:BLACK  
 UNIT:mm

NOISE REDUCING

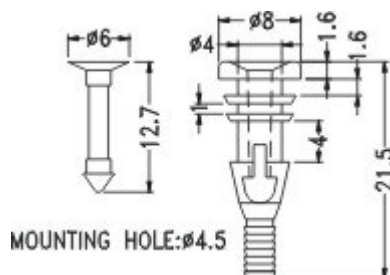

PARTNO	PACKAGE
FSP-2	1000

**PUSH RIVET**

**FSP-1**

PIN MATERIAL:NYLON 66(UL)94V-2  
 BODYMATERIAL:T.P.E  
 COLOR:BLACK  
 UNIT:mm

NOISE REDUCING

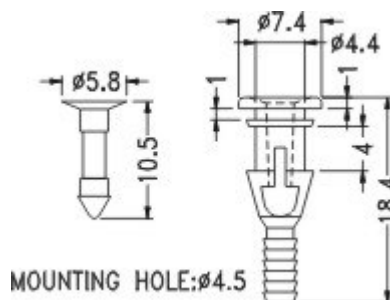

PARTNO	PACKAGE
FSP-1	1000

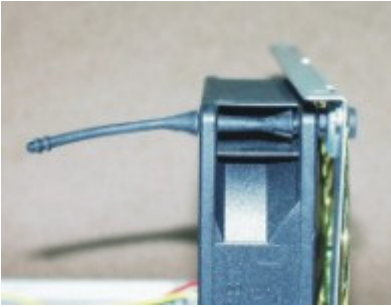

**FAN MOUNT**

**FM-72**

MATERIAL:T.P.E  
 COLOR:BLACK  
 UNIT:mm

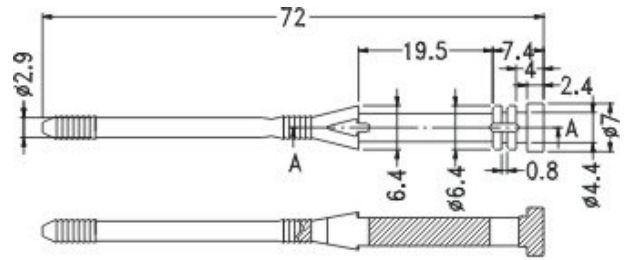

SECTION A-A  
 FANS MOUNTING HOLE  $\phi 4.3$   
 CHASSIS MOUNTING HOLE  $\phi 4.3$

PART NO	PACKAGE
FM -72	500

- LESS NOISE VIBRATION
- EASY FAST MOUNTING

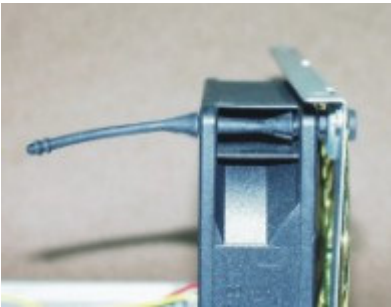

**FAN MOUNT**

**FM-32**

MATERIAL:T.P.E  
 COLOR:BLACK  
 UNIT:mm

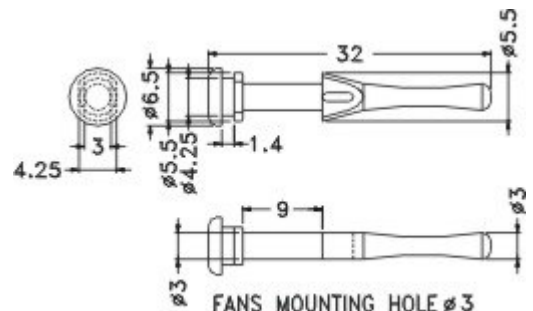

FANS MOUNTING HOLE  $\phi 3$   
 CHASSIS MOUNTING HOLE  $\phi 4.2$

PART NO	PACKAGE
FM -32	500

- LESS NOISE VIBRATION
- EASY FAST MOUNTING

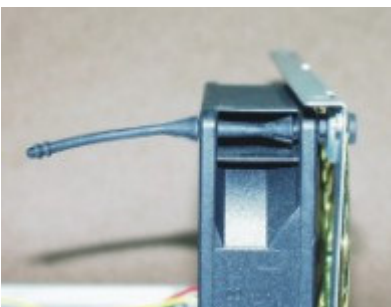

**FAN MOUNT**

**FM-23**

MATERIAL:T.P.E  
 COLOR:BLACK  
 UNIT:mm

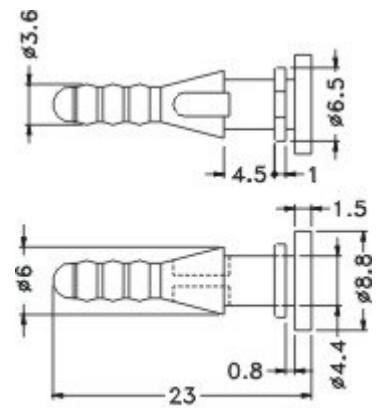

FANS MOUNTING HOLE  $\phi 4.3$   
 CHASSIS MOUNTING HOLE  $\phi 4.3$

PART NO	PACKAGE
FM -23	500

- LESS NOISE VIBRATION
- EASY FAST MOUNTING



**FAN MOUNT**

**FM-71**

MATERIAL:T.P.E  
 COLOR:BLACK  
 UNIT:mm

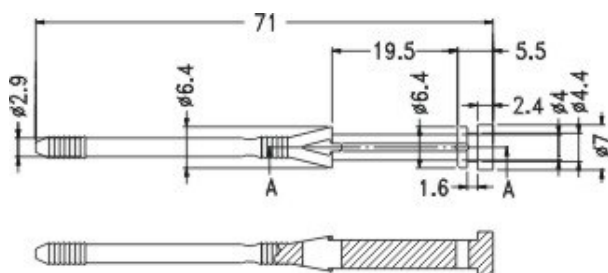

SECTION A-A  
 FANS MOUNTING HOLE  $\phi 4.2$   
 CHASSIS MOUNTING HOLE  $\phi 4.2$

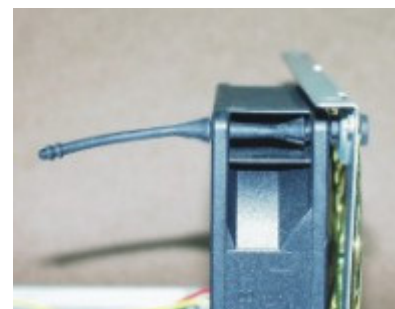

PART NO	PACKAGE
FM -71	500

- LESS NOISE VIBRATION
- EASY FAST MOUNTING

**FAN MOUNT**

**FM-68**

MATERIAL:T.P.E  
 COLOR:BLACK  
 UNIT:mm

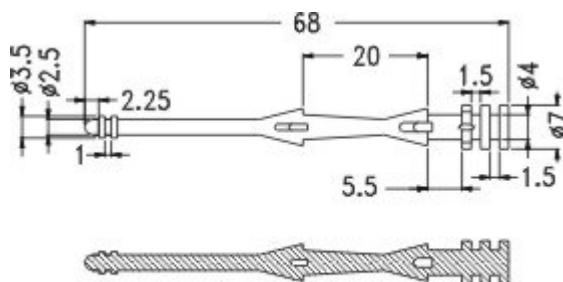

FANS MOUNTING HOLE  $\phi 4$   
 CHASSIS MOUNTING HOLE  $\phi 4$

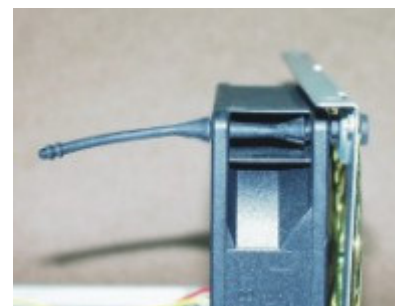

PART NO	PACKAGE
FM - 68	500

- LESS NOISE VIBRATION
- EASY FAST MOUNTING

**FAN MOUNT**

**FM-54**

MATERIAL:T.P.E  
 COLOR:BLACK  
 UNIT:mm

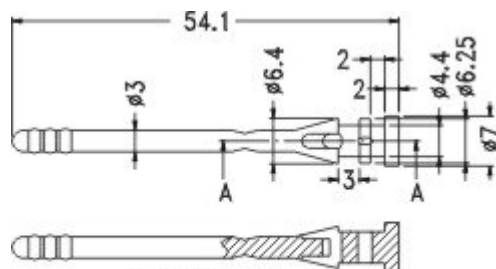

SFCTION A-A  
 FANS MOUNTING HOLE  $\phi 4.3$   
 CHASSIS MOUNTING HOLE  $\phi 4.3$

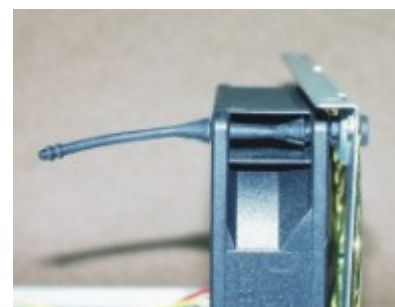

PART NO	PACKAGE
FM - 54	500

- LESS NOISE VIBRATION
- EASY FAST MOUNTING

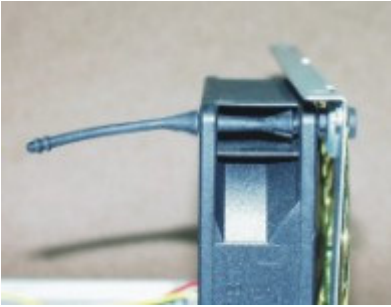

**FAN MOUNT**

**FM-53**

MATERIAL:T.P.E  
 COLOR:BLACK  
 UNIT:mm

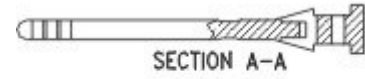
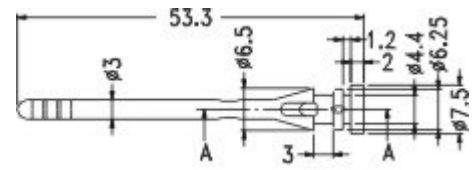

FANS MOUNTING HOLE  $\phi$ 4.3  
 CHASSIS MOUNTING HOLE  $\phi$ 4.3

PART NO	PACKAGE
FM - 53	500

- LESS NOISE VIBRATION
- EASY FAST MOUNTING

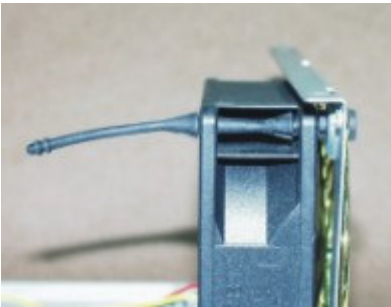

**FAN MOUNT**

**FM-65**

MATERIAL:T.P.E  
 COLOR:BLACK  
 UNIT:mm

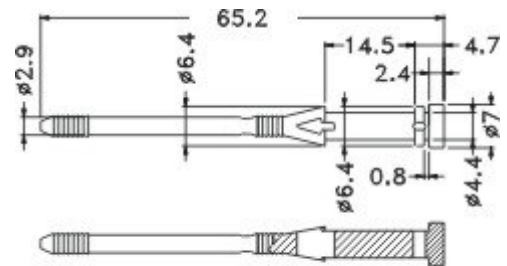

FANS MOUNTING HOLE  $\phi$ 4.3  
 CHASSIS MOUNTING HOLE  $\phi$ 4.3

PART NO	PACKAGE
FM - 65	500

- LESS NOISE VIBRATION
- EASY FAST MOUNTING

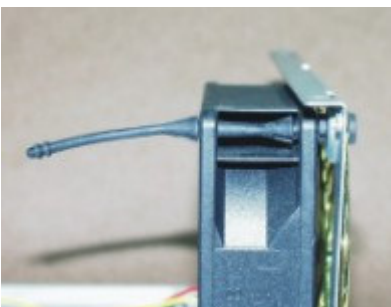

**FAN MOUNT**

**FM-35**

MATERIAL:T.P.E  
 COLOR:BLACK  
 UNIT:mm

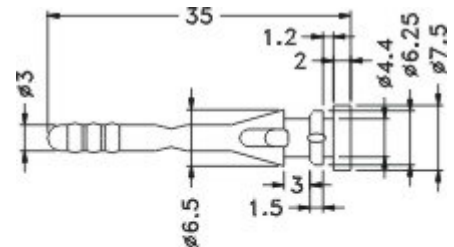

FANS MOUNTING HOLE  $\phi$ 4.3  
 CHASSIS MOUNTING HOLE  $\phi$ 4.3

PART NO	PACKAGE
FM - 35	500

- LESS NOISE VIBRATION
- EASY FAST MOUNTING





**FAN MOUNT**

**FM-20**

MATERIAL:T.P.E  
 COLOR:BLACK  
 UNIT:mm

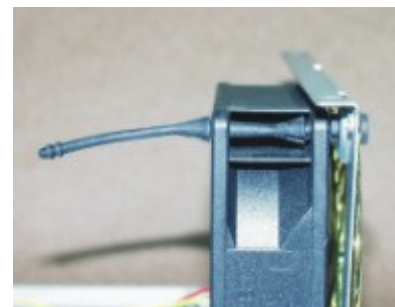
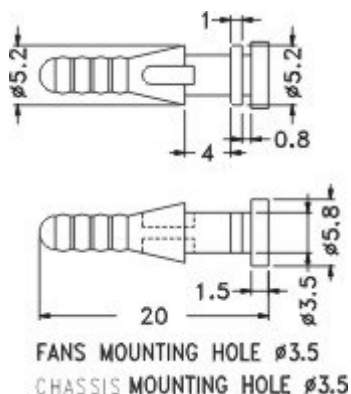

PARTNO	PACKAGE
FM - 20	500

- LESS NOISE VIBRATION
- EASY FAST MOUNTING

**MICROCELL MOUNTING**

**MIC-10**

MATERIAL:SILICON RUBBER  
 COLOR:BLACK  
 UNIT:mm

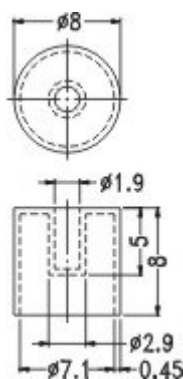

PARTNO	PACKAGE
MIC-10	2000

**MICROCELL MOUNTING**

**MIC-6**

MATERIAL:RUBBER  
 COLOR:BLACK  
 UNIT:mm

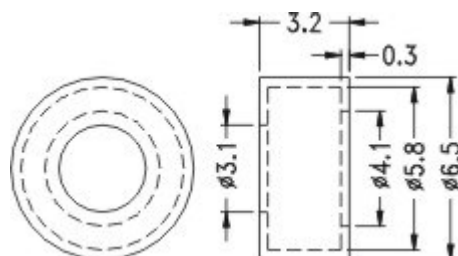

PARTNO	PACKAGE
MIC-6	2000



**MICROCELL MOUNTING**

**MIC-5**

MATERIAL:RUBBER  
 COLOR:BLACK  
 UNIT:mm

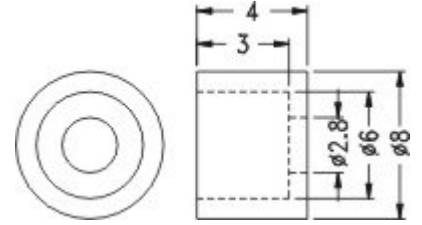

PARTNO	PACKAGE
MIC-5	2000

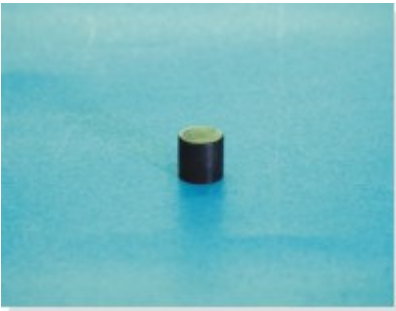

**MICROCELL MOUNTING**

**MIC-3**

MATERIAL:RUBBER  
 COLOR:BLACK  
 UNIT:mm

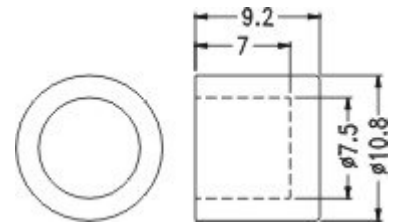

PARTNO	PACKAGE
MIC-3	1000

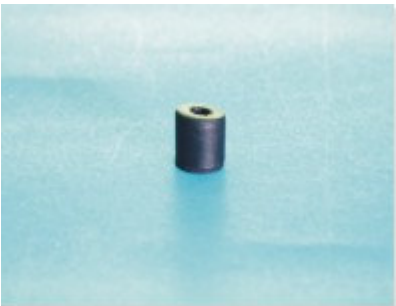

**MICROCELL MOUNTING**

**MIC-2**

MATERIAL:RUBBER  
 COLOR:BLACK  
 UNIT:mm

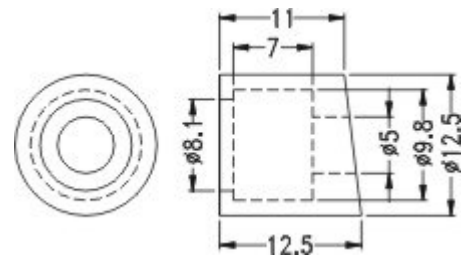

PARTNO	PACKAGE
MIC-2	1000



**MICROCELL MOUNTING**

**MIC**

MATERIAL:RUBBER  
 COLOR:BLACK  
 UNIT:mm

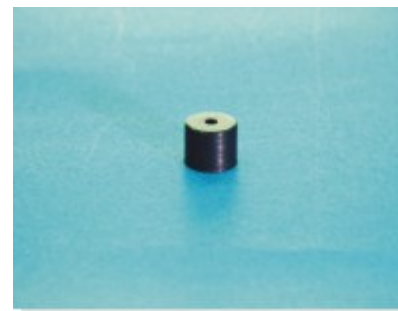
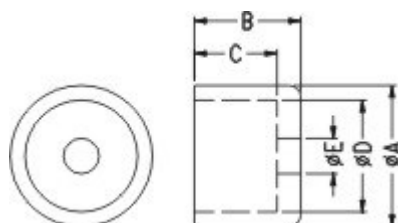

PARTNO	A	B	C	D	E	PACKAGE
MIC-1	12.0	8.6	7.0	9.5	3.0	1000
MIC-1A	12.5	9.0	7.0	9.5	3.0	
MIC-4	8.0	6.0	5.0	5.8	3.0	2000
MIC-9	7.1	3.3	2.5	6.0	4.0	

**RING SEALING**

**OR**

MATERIAL:RUBBER  
 COLOR:BLACK  
 UNIT:mm

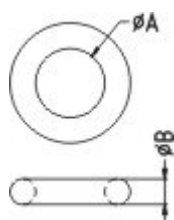

PARTNO.	A	B	PACKAGE
OR-2	2.0	1.0	2000
OR-2.7	2.75	0.6	
OR-2.8	2.8	0.5	
OR-3.6	3.6	1.78	
OR-4	4.0	2.0	
OR-4.6	4.6	1.78	
OR-5	5.0	1.0	
OR-5.8	5.8	1.9	
OR-6	6.02	2.6	
OR-7.6	7.65	1.78	
OR-7.9	7.9	1.0	
OR-8	8.0	1.0	
OR-9.8	9.8	2.4	
OR-11	11.0	2.0	
OR-21.3	21.3	3.0	
OR-25.2	25.2	3.5	
OR-84.4	84.4	3.1	



**FOOT**

**SF141410**

MATERIAL:RUBBER  
 COLOR:BLACK  
 UNIT:mm

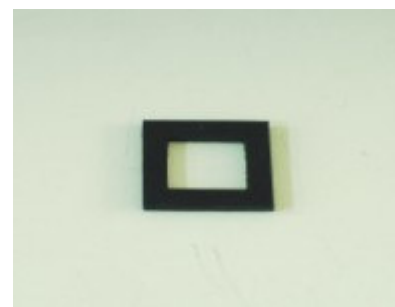
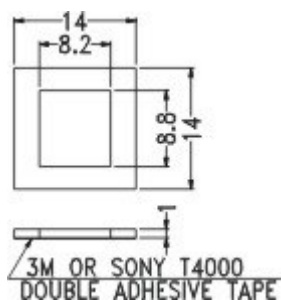

PARTNO  
 SF141410

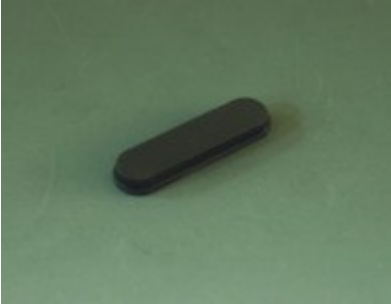

**FOOT**

**PT005**

MATERIAL:RUBBER  
 COLOR:BLACK/GRAY/COMPUTER  
 UNIT:mm  
 OTHER MATERIALS  
 AVAILABLE:EPDM,SILICON,...

PARTNO	A	B	C
PT005	26.8	7.2	3.8
PT100612	10.5	6.0	1.2
PT-1762	17.5	6.5	2.0
PT200612	20.5	6.2	1.2
PT360712	36.0	7.0	1.2
PT080210	8.0	2.0	1.0
PT100614	10.5	6.0	1.4
PT160915	16.0	9.5	1.5
PT200617I	20.5	6.2	1.7
PT270720I	26.8	7.2	2.0
PT360712I	36.0	7.0	1.2
PT690920	69.6	9.8	2.0

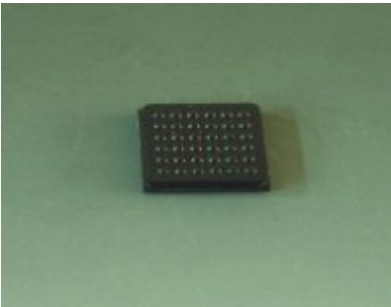
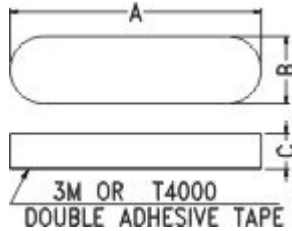

**FOOT**

**P004**

MATERIAL:RUBBER  
 COLOR:BLACK  
 UNIT:mm

PARTNO	A	B	C	D
P004	14.0	13.5	2.1	2.6
P005	15.0	14.5	2.6	3.1

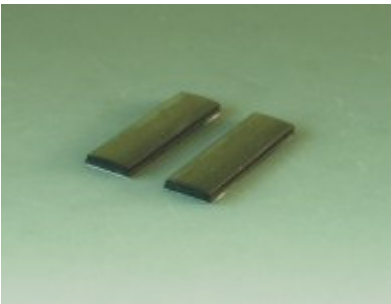
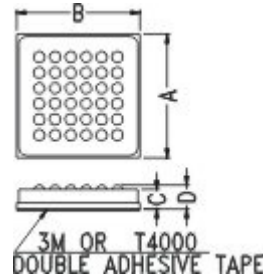

**FOOT**

**SF14722**

MATERIAL:RUBBER  
 COLOR:BLACK/GRAY/COMPUTER  
 UNIT:mm  
 OTHER MATERIALS  
 AVAILABLE:EPDM,SILICON,...

PARTNO	A
SF14722	14.0
SF28722	27.8

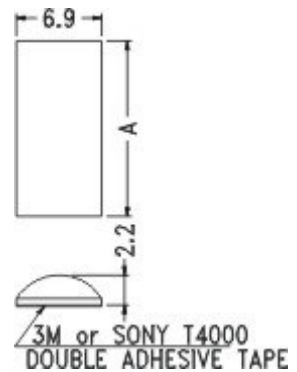



**FOOT BUMPER**

**SF340220**

MATERIAL: RUBBER  
 COLOR: BLACK/GRAY/COMPUTER  
 UNIT: mm  
 OTHER MATERIALS  
 AVAILABLE: EPDM, SILICON, ...  
 OPTIONAL THICKNESS  
 BETWEEN : 0.5~10mm

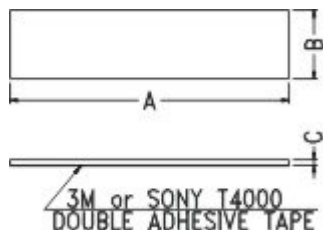

PART NO.	A	B	C
SF340220	34.0	2.0	2.0
SF340904	34.6	9.5	0.4
SF-340901	34.7	9.7	1.0
SF351001	35.0	10.0	1.0
SF351580	35.0	15.0	8.0
SF352508	35.0	25.0	0.8
SF361810	36.0	18.0	1.0
SF361820	36.0	18.0	2.0
SF400509	39.5	5.0	0.9
SF-4009	40.0	9.0	1.5
SF400924	40.0	9.0	2.4
SF400930	40.0	9.0	3.0
SF401040	40.0	10.5	4.0
SF401235	40.0	12.0	3.5
SF401240	40.0	12.0	4.0
SF401250	40.0	12.0	5.0
SF401715	40.0	17.5	1.5
SF442010	44.5	20.0	10.0
SF451020	45.0	10.0	2.0
SF473530	47.5	3.5	3.0
SF481040	48.0	10.0	4.0
SF484410	48.0	44.0	1.0
SF491210	49.0	12.0	1.0
SF500620	50.0	6.0	2.0
SF501038	50.0	10.0	3.8
SF155030	50.0	15.0	3.0
SF541010	54.0	10.0	1.0
SF550515	55.0	5.0	1.5
SF582508	58.0	25.0	0.8
SF582514	58.0	25.0	1.4
SF582516	58.0	25.0	1.6
SF600610	60.0	6.0	1.0
SF600613	60.0	6.0	1.3
SF600625	60.0	6.0	2.5
SF-6064	60.0	6.0	4.0
SF600907	60.0	9.0	0.7
SF601010	60.0	10.0	1.0
SF601025	60.0	10.0	2.5
SF6017530	60.0	17.5	3.0
SF602010	60.0	20.0	10.0
SF652020	65.0	20.0	2.0
SF654030	65.0	40.0	3.0

PART NO.	A	B	C
SF700525	70.0	5.0	2.5
SF70182	70.0	18.0	2.0
SF702010	70.0	20.0	1.0
SF764005	76.0	40.0	0.5
SF-801004	80.0	10.0	0.5
SF845208	84.6	52.6	0.8
SF880810	88.0	8.0	1.0
SF951232	95.0	12.0	3.2
SF980830	98.0	8.0	3.0
SF993555	99.0	3.5	5.5
SF990915	99.0	9.9	1.5
LSF-002	100.0	12.0	3.5
SF107581	107.0	58.0	1.5
SF1100540	110.0	5.6	4.0
SF1101010	110.0	10.0	1.0
SF1111009	111.0	10.0	0.9
SF1200310	120.0	3.0	1.0
SF1254620	125.0	46.0	2.0
SF1302030	130.0	20.0	3.0
SF1302020	130.0	20.0	2.0
SF1340220	134.0	2.0	2.0
SF1400520	140.0	5.0	2.0
SF140101	140.0	10.0	1.0
SF140251	140.0	25.0	1.0
SF14510520	145.0	105.0	2.0
SF1461010	146.0	10.0	1.0
SF1500712	150.0	7.0	1.2
SF-1501004	150.0	10.0	0.5
SF1501515	150.0	15.0	1.5
SF1600610	160.0	6.0	1.0
SF1664930	166.5	49.0	3.0
SF2500515	250.0	5.0	1.5
SF2506520	250.0	65.0	2.0
SF2701655	270.0	165.0	0.5
SF2581420	258.0	14.5	2.0
SF3101150	310.0	11.6	5.0
SF3101250	310.0	12.0	5.0
SF5400208	540.0	2.9	0.8

PART NO	A	B	C
SF050435	5.0	4.5	3.5
SF062313	6.0	2.3	1.3
SF060425	6.0	4.0	2.5
SF652840	6.5	2.8	4.0
SF652850	6.5	2.8	5.0
SF070215	7.0	2.0	1.5
SF070216	7.0	2.0	1.6
SF070304	7.0	3.0	0.4
SF073512	7.0	3.5	1.2
SF070420	7.0	4.0	2.0
SF070620	7.0	6.0	2.0
SF080625	8.0	6.0	2.5
SF852530	8.5	2.5	3.0
SF853520	8.5	3.5	2.0
SF853525	8.5	3.5	2.5
SF80452	8.0	4.5	2.0
SF090855	9.6	8.0	5.5
SF100616	9.9	6.6	1.6
SF100119	10.0	1.9	1.9
SF103512	10.0	3.5	1.2
SF100409	10.0	4.0	0.9
SF100510	10.0	5.0	1.0
SF100520	10.0	5.0	2.0
SF100712	10.0	7.0	1.2
SF100825	10.0	8.0	2.5
SF100850	10.0	8.0	5.0
SF100730	10.5	7.2	3.0
SF110830	11.5	8.0	3.0
SF118781	11.8	7.8	1.0
SF120565	12.0	5.0	6.5
SF120810	12.0	8.5	1.0
SF129515	12.0	9.5	1.5
SF121530	12.0	15.0	3.0
SF1256535	12.5	6.5	3.5
SF1251008	12.5	10.0	0.8
SF-1251015	12.5	10.0	1.5
SF130620	13.0	6.0	2.0
SF130630	13.0	6.0	3.0
SF130735	13.0	7.0	3.5
SF130740	13.0	7.0	4.0
SF130855	13.5	8.0	5.5
SF132525	13.0	2.5	2.5

PART NO	A	B	C
SF14043	14.0	4.0	3.0
SF140440	14.0	4.0	4.0
SF150320	15.0	3.2	2.0
SF150610	15.0	6.0	1.0
SF151016	15.0	10.0	1.6
SF151930	15.0	1.9	3.0
SF1585601	15.8	5.6	1.0
SF151025	15.8	10.0	2.5
SF-163530	16.0	3.5	3.0
SF160536	16.0	5.0	3.6
SF170525	17.0	5.0	2.5
SF1724330	17.2	4.3	3.0
SF180930	18.0	9.0	3.0
SF181010	18.0	10.0	1.0
SF181020	18.0	10.0	2.0
SF195640	19.0	5.6	4.0
SF1905720	19.0	5.7	2.0
SF197774	19.7	7.7	4.0
SF197760	19.7	7.7	6.0
SF190814	19.7	8.0	1.4
SF190815	19.7	8.0	1.5
SF1979723	19.7	9.7	2.3
SF1979723	19.7	9.7	2.3
SF1979723	19.7	9.7	2.3
SF1979725	19.7	9.7	2.5
SF1979730	19.7	9.7	3.0
SF-1972015	19.7	20.0	1.5
SF202515	20.0	2.5	1.5
SF200410	20.0	4.0	1.0
SF200420	20.0	4.0	2.0
SF200510	20.0	5.0	1.0
SF200515	20.0	5.0	1.5
SF200563	20.0	5.0	6.3
SF200568	20.0	5.0	6.8
SF200725	20.0	7.0	2.5
SF201010	20.0	10.0	1.0
SF201015	20.0	10.0	1.5
SF201020	20.0	10.0	2.0
SF201035	20.0	10.0	3.5
SF201056	20.0	10.0	5.6
SF201465	20.0	14.0	6.5
SF201515	20.0	15.0	1.5

PART NO.	A	B	C
SF200612	20.5	6.0	1.2
SF210804	21.5	8.6	0.4
SF-221615	22.0	16.0	1.5
SF227640	22.6	7.6	4.0
SF237640	23.0	7.6	4.0
SF230610	23.7	6.5	1.0
SF246011	24.8	6.0	1.1
SF250535	25.0	5.0	3.5
SF250550	25.0	5.0	5.0
SF250760	25.0	7.0	6.0
SF250810	25.0	8.0	1.0
SF250815	25.0	8.0	1.5
SF250820	25.0	8.0	2.0
SF251235	25.0	12.0	3.5
SF152530	25.0	15.0	3.0
SF251224	25.4	12.7	2.4
SF251232	25.4	12.7	3.2
SF260510	26.8	5.5	1.0
SF270830	27.0	8.0	3.0
SF271810	27.0	18.0	1.0
SF271820	27.0	18.0	2.0
SF279032	27.5	9.0	3.2
SF-3064	30.0	6.0	4.0
SF303555	30.0	3.5	5.5
SF30709	30.0	7.0	0.9
SF3038	30.0	8.0	3.8
SF-301120	30.0	11.0	2.0
SF-301140	30.0	11.0	4.0
SF301230	30.0	12.0	3.0
SF301250	30.0	12.0	5.0
SF301525	30.0	15.0	2.5
SF302055	30.0	20.0	5.5
SF302501	30.0	25.0	1.0
SF-30511	30.5	11.0	7.0
SF311510	31.5	15.5	1.0
SF311515	31.5	15.5	1.5
SF3267225	32.0	6.7	2.25
SF321720	32.0	17.0	2.0
SF321725	32.0	17.0	2.5
SF332055	33.0	20.0	5.5
SF323285	33.3	23.3	8.5
SF331125	33.5	11.5	2.5

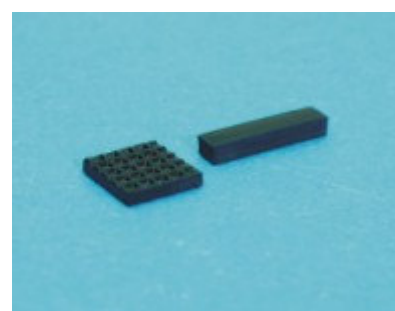

**FOOT BUMPER**

**SF050435**

MATERIAL: RUBBER  
 COLOR: BLACK/GRAY/COMPUTER  
 UNIT: mm  
 OTHER MATERIALS AVAILABLE: EPDM, SILICON, ...  
 OPTIONAL THICKNESS IS BETWEEN : 0.5~10mm

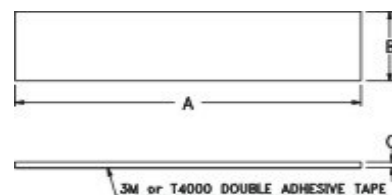

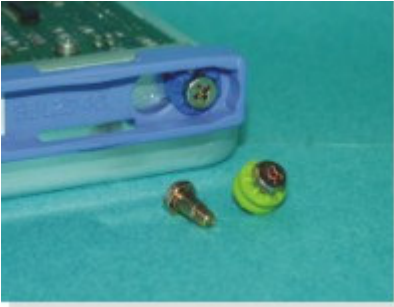

**SHOLDER SCREW**

**TGM**

MATERIAL:STEEL  
FINISH:NICKEL-PLATING  
UNIT:mm

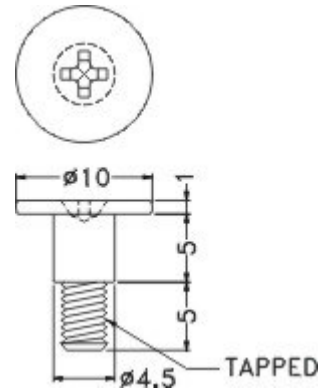

PART NO.	TAPPED	PACKAGE
TGM3-10	M3	1000
TGM632-10	6-32 UNC	



**SHOLDER SCREW**

**TGM-13SW**

MATERIAL:STEEL  
FINISH:NICKEL-PLATING  
UNIT:mm

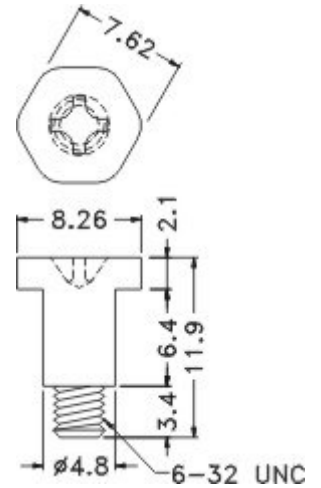

PARTNO	PACKAGE
TGM-13SW	1000



**SHOLDER SCREW**

**TGM-10SW**

MATERIAL:STEEL  
FINISH:NICKEL-PLATING  
UNIT:mm

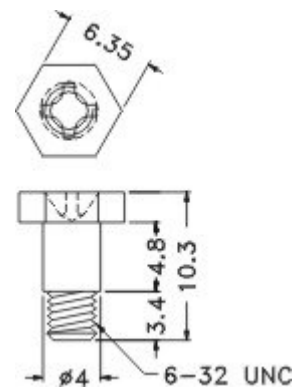

PARTNO	PACKAGE
TGM-10SW	1000





**VIBRATION ABSORPTION SPACER**

**SITP-15.5**

TERMINAL MAT'L:EL(YELLOW ZINC PLATED)  
 FLAME CLASS:SILICON UL94HB  
 COLOR:GRAY  
 UNIT:mm

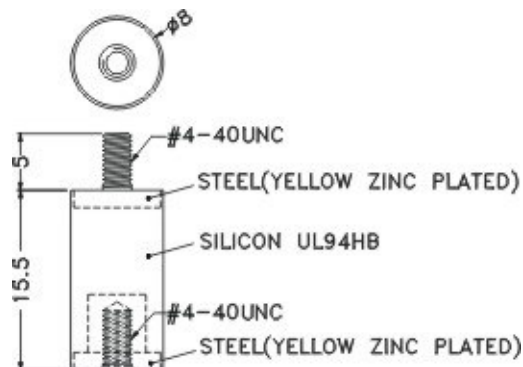

PARTNO	PACKAGE
SITP-15.5	1000

**ANTI VIBRATION MOUNTING**

**WSQ4-2**

MATERIAL:TPE  
 COLOR:RED  
 UNIT:mm

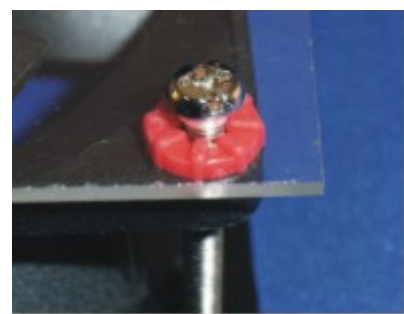
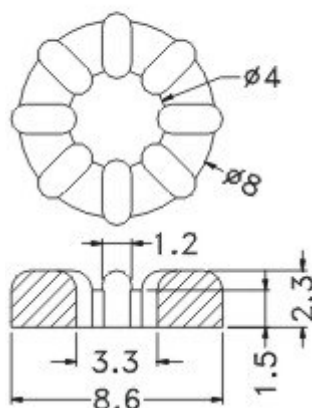

PARTNO	PACKAGE
WSQ4-2	2000

**HARD DISK SLEEVES**

**HDM**

MATERIAL:TPE UL94-V-0  
 COLOR:BLACK  
 UNIT:mm



Part Nr.	A	B	C	D	E	F	G	H	S	Housing / Plate Thickness
HDM-25-095-10	73.4 *	12.5	9.5	5.0	1.5	16.0	10.0	3.5	1.0	0.75~1.25
HDM-25-095-20	73.4 *	12.5	9.5	5.0	1.5	16.0	10.0	4.5	2.0	1.5~2.5
HDM-35-254-10	106.1 *	29.4	25.4	6.0	2.0	23.0	15.0	3.5	1.0	0.75~1.25
HDM-35-254-20	106.1 *	29.4	25.4	6.0	2.0	23.0	15.0	4.5	2.0	1.5~2.5