



CATALOGUS: FREROX

PLASTIC PARTS FOR ELECTRICAL EQUIPMENT

FREROX ELECTRONICS

8

PCB GUIDES

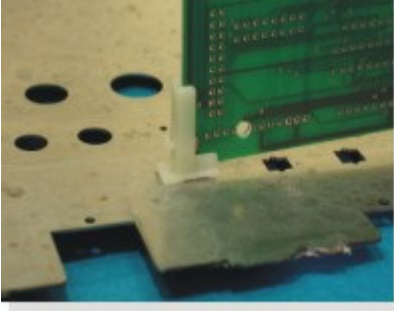

MINI CARD HOLDER

CGH-1

MATERIAL:NTLON 66(UL)
 FLAME CLASS:94V-2
 COLOR:NATURAL
 UNIT:mm

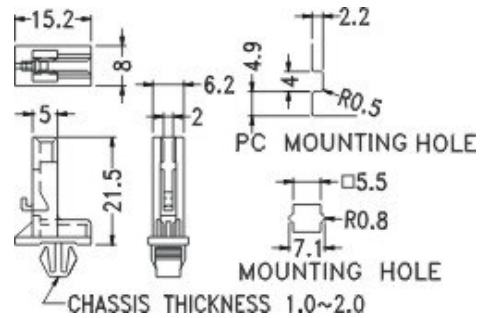

| PARTNO | PACKAGE |
|--------|---------|
| CGH-1 | 500 |

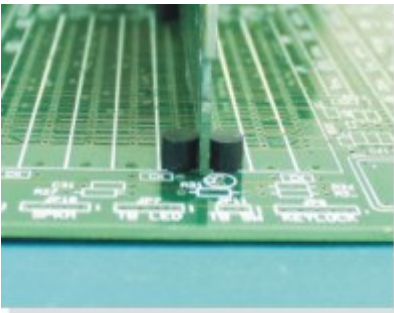

CARD HOLDER

CGB-6

MATERIAL:NYLON 66(UL)
 FLAME CLASS:94V-2
 COLOR:BLACK
 UNIT:mm

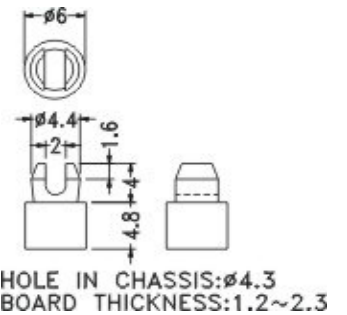

| PARTNO | PACKAGE |
|--------|---------|
| CGB-6 | 2000 |



CARD HOLDER

CGA-217

MATERIAL:NYLON 66(UL)
 FLAME CLASS:94V-2
 COLOR:NATURAL
 UNIT:mm

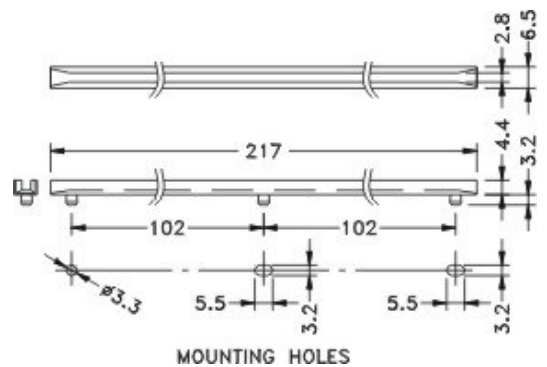

| PARTNO | PACKAGE |
|---------|---------|
| CGA-217 | 250 |

CARD HOLDER

CGH-130

MATERIAL: NYLON 66(UL)
 FLAME CLASS: 94V-2
 COLOR: NATURAL
 UNIT: mm

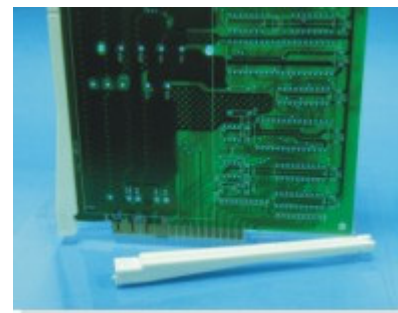
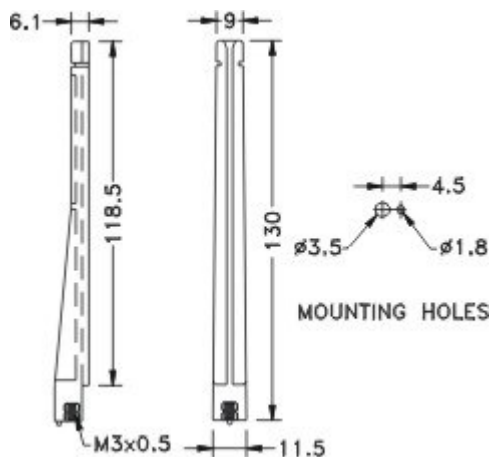

| PARTNO | PACKAGE |
|---------|---------|
| CGH-130 | 500 |

CARD HOLDER

CGH-90

MATERIAL: NYLON 66(UL)
 FLAME CLASS: 94V-2
 COLOR: NATURAL

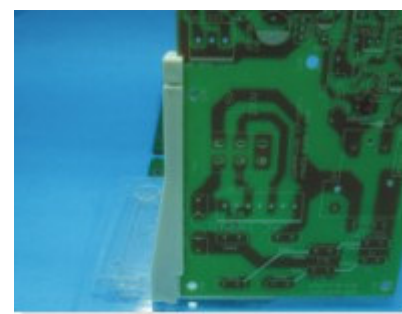
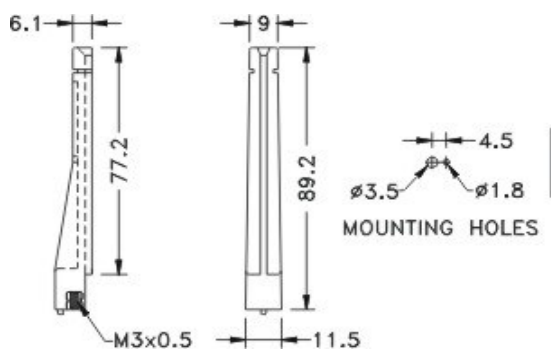

6.

| PARTNO | PACKAGE |
|--------|---------|
| CGH-90 | 500 |

CARD HOLDER

CGA-178

MATERIAL: NYLON 66(UL)
 FLAME CLASS: 94V-2
 COLOR: NATURAL/BLACK
 UNIT: mm

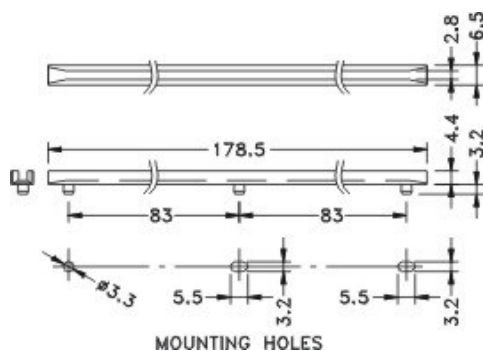

| PARTNO | PACKAGE |
|---------|---------|
| CGA-178 | 250 |

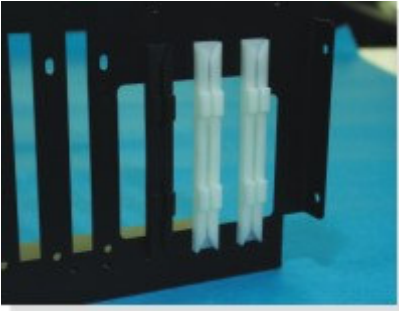

CARD HOLDER

CG-9AL

MATERIAL:NYLON66(UL)
 FLAME CLASS:94V-2
 COLOR:NATURAL/BLACK
 UNIT:mm

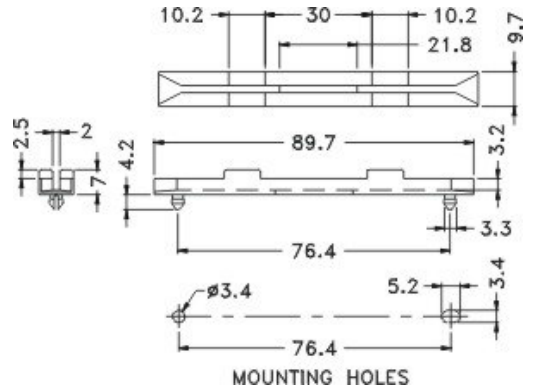

| PARTNO | PACKAGE |
|--------|---------|
| CG-9AL | 250 |

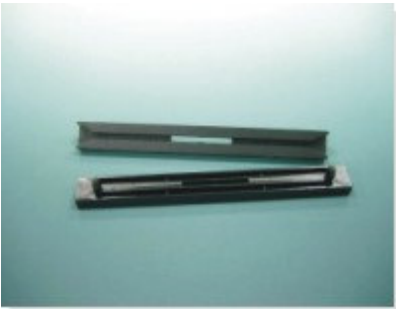

CARD HOLDER

CG-GB

MATERIAL:NYLON66(UL)
 FLAME CLASS:94V-2
 COLOR:NATURAL/BLACK
 UNIT:mm

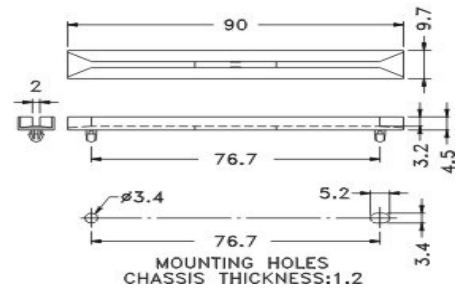

| PARTNO | PACKAGE |
|--------|---------|
| CG-9B | 250 |

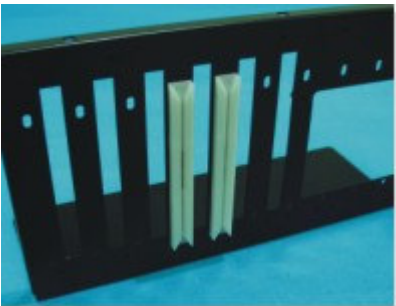

CARD HOLDER

CG-9A

MATERIAL:NYLON66(UL)
 FLAME CLASS:94V-2
 COLOR:NATURAL/BLACK
 UNIT:mm

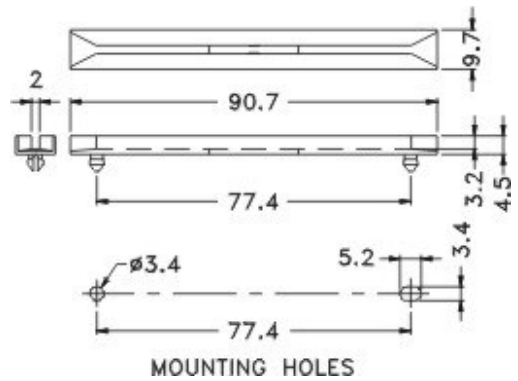

| PARTNO | PACKAGE |
|--------|---------|
| CG-9A | 250 |

CARD HOLDER

CGA-102

MATERIAL: NYLON66(UL)
 FLAME CLASS: 94V-2
 COLOR: NATURAL
 UNIT: mm

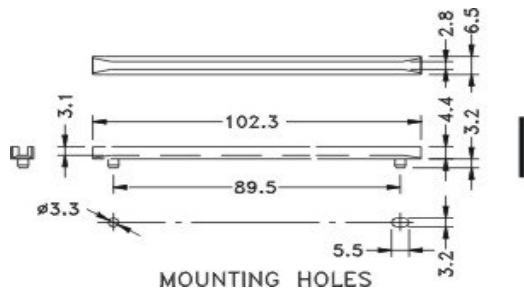

| PARTNO | PACKAGE |
|---------|---------|
| CGA-102 | 250 |

CARD HOLDER

CGA-10A(B)

MATERIAL: NYLON66(UL)
 FLAME CLASS: 94V-2
 COLOR: BLACK
 UNIT: mm

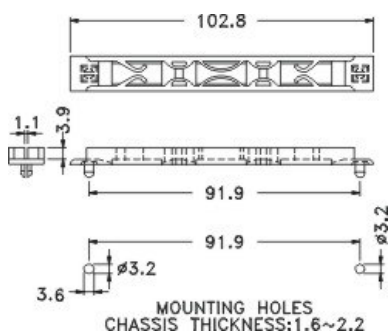

| PARTNO | PACKAGE |
|-----------|---------|
| CG-10A(B) | 250 |

ALSO AVAILABLE IN ELECTRIC CONDUCTIF NYLON

CARD EJECTOR

CP-35

MATERIAL: NYLON 66(UL)
 FLAME CLASS: 94V-2
 COLOR: NATURAL
 UNIT: mm

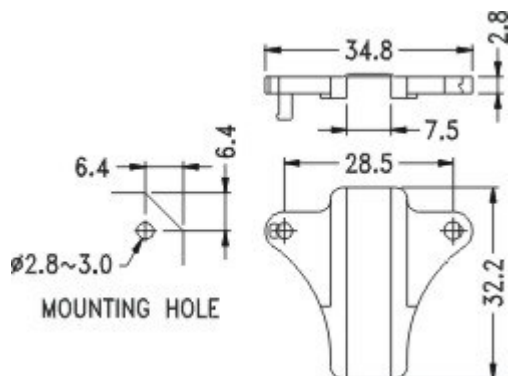

| PARTNO | PACKAGE |
|--------|---------|
| CP-35 | 500 |



CARD HOLDER

CG-218

MATERIAL:NYLON66(UL)
 FLAME CLASS:94V-2
 COLOR:NATURAL
 UNIT:mm

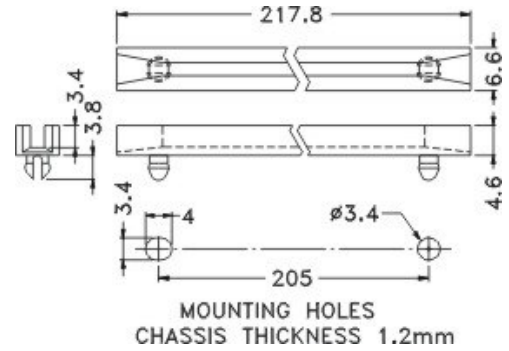

| PARTNO | PACKAGE |
|--------|---------|
| CG-218 | 100 |



CARD HOLDER

CG-203

MATERIAL:NYLON66(UL)
 FLAME CLASS:94V-2
 COLOR:NATURAL
 UNIT:mm

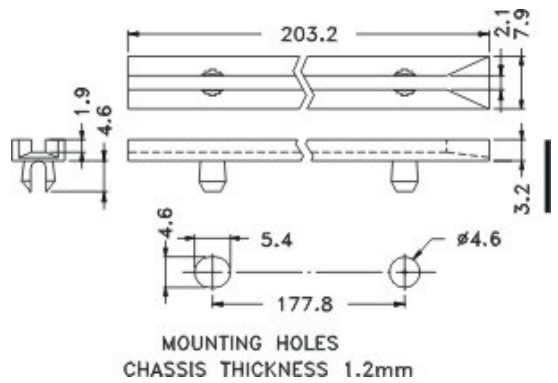

| PARTNO | PACKAGE |
|--------|---------|
| CG-203 | 100 |

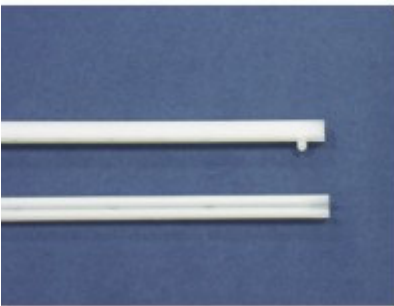

CARD HOLDER

CG-191

MATERIAL:NYLON66(UL)
 FLAME CLASS:94V-2
 COLOR:NATURAL
 UNIT:mm

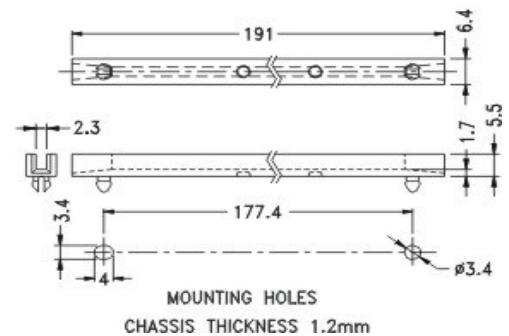

| PARTNO | PACKAGE |
|--------|---------|
| CG-191 | 100 |

CARD HOLDER**CGF-218**

MATERIAL: NYLON66(UL)
 FLAME CLASS: 94V-2
 COLOR: BLACK
 UNIT: mm

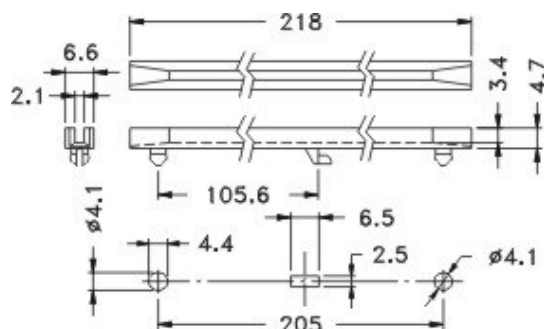

MOUNTING HOLES
 CHASSIS THICKNESS: 1.2



| PARTNO | PACKAGE |
|---------|---------|
| CGF-218 | 100 |

CARD HOLDER**CGS-280**

MATERIAL: NYLON66(UL)
 FLAME CLASS: 94V-2
 COLOR: BLACK
 UNIT: mm

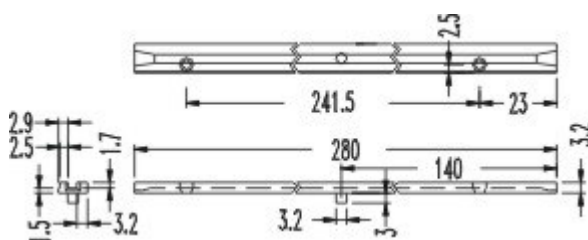

| PARTNO | PACKAGE |
|---------|---------|
| CGS-280 | 100 |

CARD HOLDER**CG-280**

MATERIAL: NYLON66(UL)
 FLAME CLASS: 94V-2
 COLOR: BLACK
 UNIT: mm

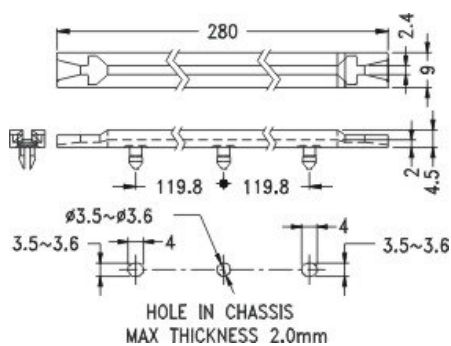

| PARTNO | PACKAGE |
|--------|---------|
| CG-280 | 100 |



| PARTNO | PACKAGE |
|--------|---------|
| CGLC-8 | 500 |

CARD HOLDER

CGLC-8

MATERIAL: NYLON66(UL)
 FLAME CLASS: 94V-2
 COLOR: NATURAL
 UNIT: mm

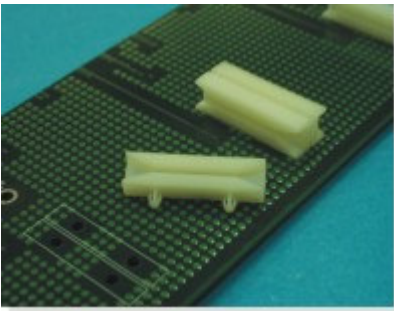
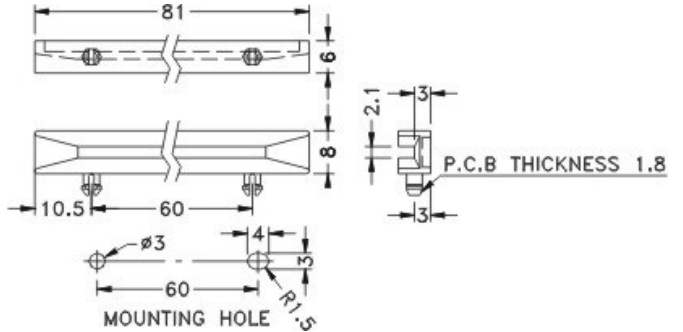

CARD HOLDER

CGLA

MATERIAL: NYLON 66(UL)
 FLAME CLASS: 94V-2
 COLOR: NATURAL
 UNIT: mm

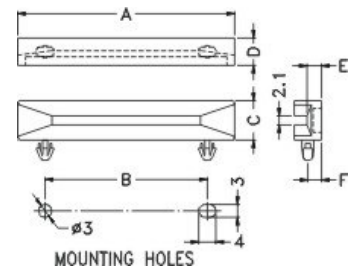

| | A | B | C | D | E | F | P.C.B THICKNESS | PACKAGE |
|------------|------|------|-----|-----|-----|-----|-----------------|---------|
| CGLA-4 | | | | | | | 1.6~1.7 | 500 |
| CGLA-4(1) | 38.4 | 20.0 | 9.2 | 6.4 | 3.4 | 3.2 | 1.0 | |
| CGLA-4(2) | | | 8.0 | 6.0 | 3.0 | 3.0 | 2.0 | |
| CGLA-4S | 40.0 | | | | | | 1.6 | |
| CGLA-6 | 51.0 | 38.2 | 9.2 | 6.4 | 3.4 | 3.2 | 1.6~1.7 | 250 |
| CGLA-8 | | | | | | | 1.6~1.8 | |
| CGLA-8(2) | 81.0 | 60.0 | | | | | 1.8~2.1 | |
| CGLA-8(8) | | | 8.0 | 6.0 | 3.0 | 3.0 | 1.8 | |
| CGLA-8(25) | | | | | | | | |
| CGLA-9(1) | 91.5 | 71.0 | | | | | 1.6~1.8 | |
| CGLA-9(2) | | | | | | | 1.8~2.1 | |



| PARTNO | PACKAGE |
|--------|---------|
| FR-250 | 500 |

CARD HOLDER

FR-250

MATERIAL: NYLON 66(UL)
 FLAME CLASS: 94V-2
 COLOR: RED
 UNIT: mm

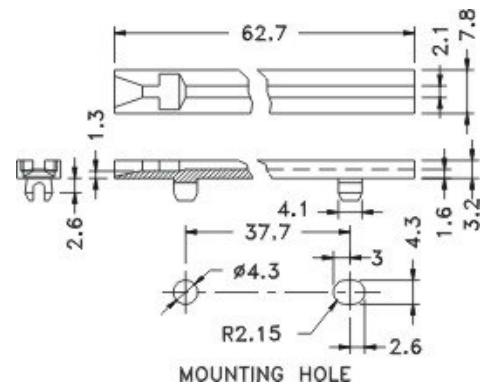

CARD HOLDER

CG-153

MATERIAL: NYLON66(UL)
 FLAME CLASS: 94V-2
 COLOR: NATURAL
 UNIT: mm

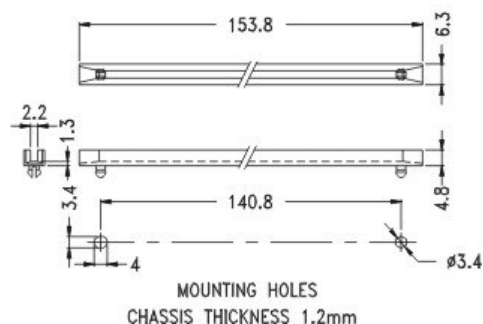

| PARTNO | PACKAGE |
|--------|---------|
| CG-153 | 100 |

CARD HOLDER

CG-650

MATERIAL: NYLON66(UL)
 FLAME CLASS: 94V-2
 COLOR: NATURAL/BLACK
 UNIT: mm

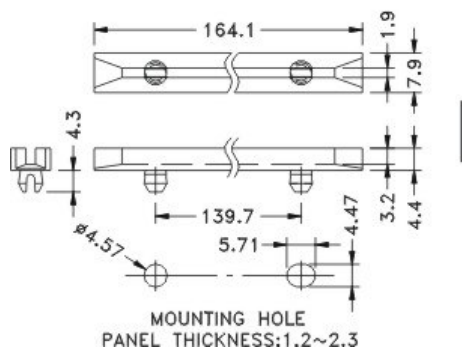

| PARTNO | PACKAGE |
|--------|---------|
| CG-650 | 500 |

CARD HOLDER

CG

MATERIAL: NYLON66(UL)
 FLAME CLASS: 94V-2
 COLOR: NATURAL/BLACK
 UNIT: mm

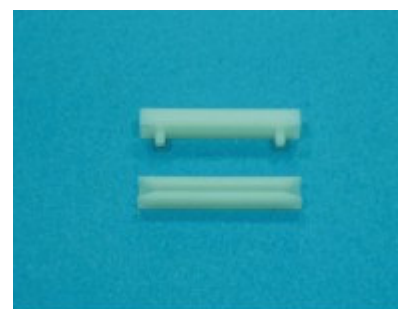
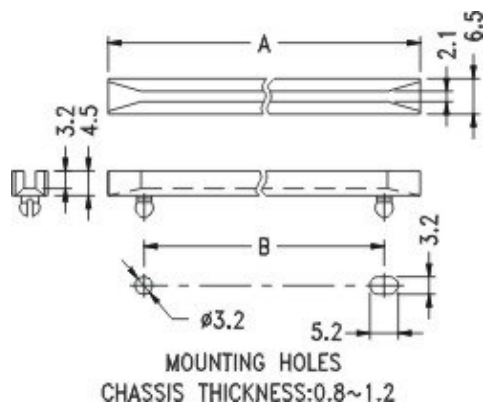

| PART NO | A | B | PACKAGE |
|---------|-------|-------|---------|
| CG-250 | 63.5 | 50.8 | 500 |
| CG-300 | 76.2 | 63.5 | |
| CG-350 | 88.9 | 76.2 | 250 |
| CG-400 | 101.6 | 88.9 | |
| CG-450 | 114.3 | 101.6 | 200 |
| CG-500 | 127.0 | 114.3 | |
| CG-550 | 139.7 | 127.0 | |
| CG-600 | 152.4 | 139.7 | |

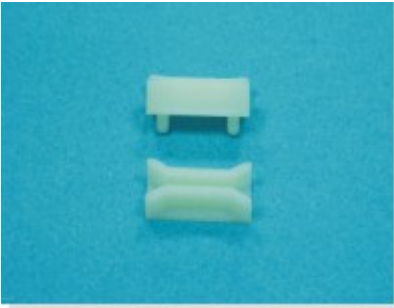

CARD HOLDER

CG-26

MATERIAL:NYLON 66(UL)
 FLAME CLASS:94V-2
 COLOR:NATURAL
 UNIT:mm

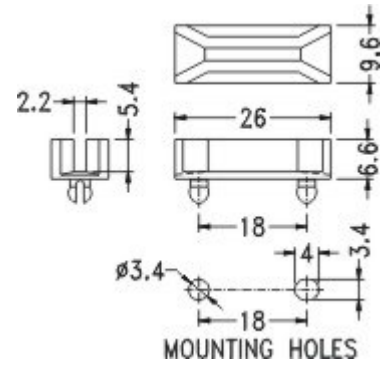

| PARTNO | PACKAGE |
|--------|---------|
| CG-26 | 500 |

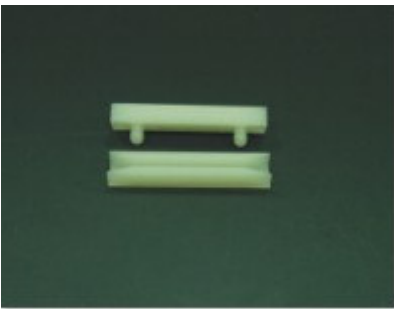

CARD HOLDER

CG-38L

MATERIAL:NYLON(UL)
 FLAME CLASS:94V-2
 COLOR:NATURAL
 UNIT:mm

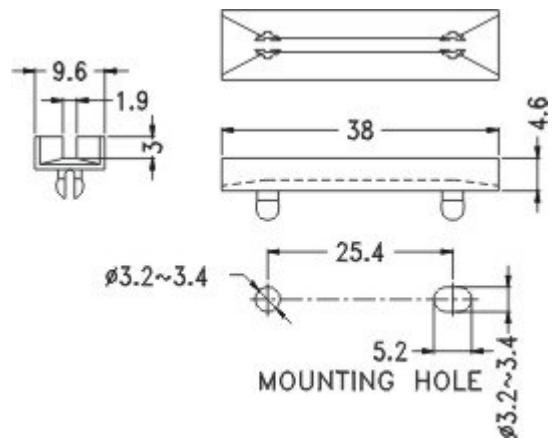

| PARTNO | PACKAGE |
|--------|---------|
| CG-38L | 500 |

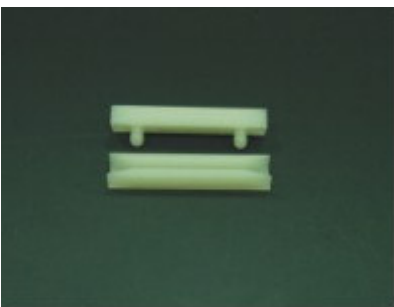

CARD HOLDER

CG

MATERIAL:NYLON(UL)
 FLAME CLASS:94V-2
 COLOR:NATURAL
 UNIT:mm

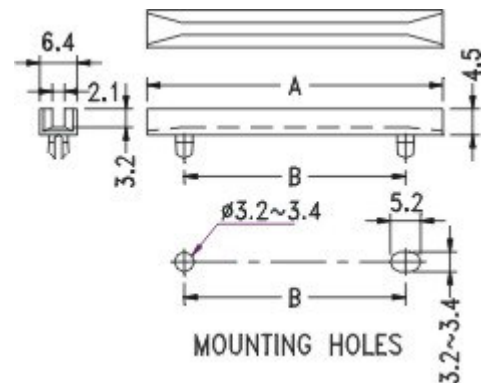

| PART NO | A | B | PACKAGE |
|---------|------|------|---------|
| CG-38 | 38.0 | 25.4 | 500 |
| CG-50 | 50.8 | 38.0 | |



CARD HOLDER

FR-1300

MATERIAL:NYLON 66(UL)
 FLAME CLASS:94V-2
 COLOR:RED
 UNIT:mm

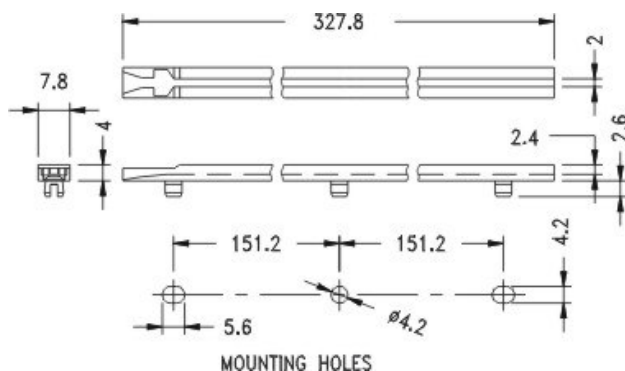

| PARTNO | PACKAGE |
|---------|---------|
| FR-1300 | 100 |

CARD HOLDER

BCG-250

MATERIAL:NYLON 66(UL)
 FLAME CLASS:94V-2/94V-0
 COLOR:BLACK/WHITE
 UNIT:mm

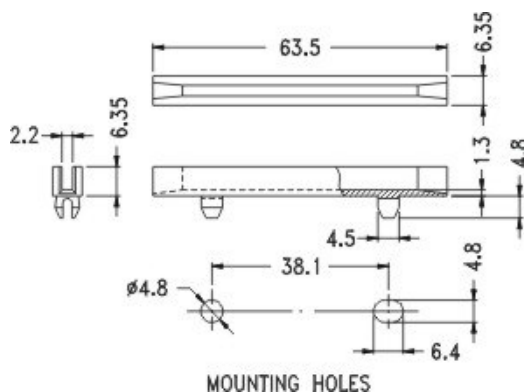

| PARTNO | PACKAGE |
|---------|---------|
| BCG-250 | 500 |

CARD HOLDER

CGL

MATERIAL:NYLON 66(UL)
 FLAME CLASS:94V-2
 COLOR:NATURAL
 UNIT:mm

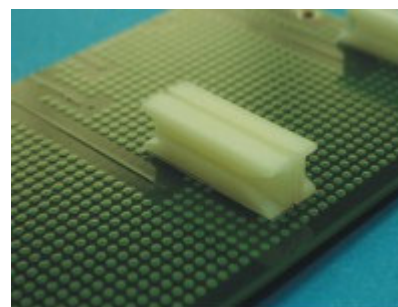
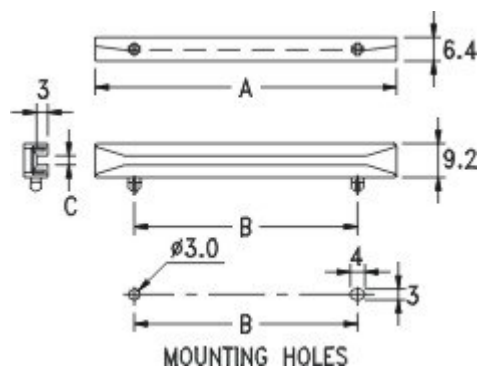

| PARTNO | A | B | C | PACKAGE |
|--------|------|------|-----|---------|
| CGL-4 | 38.4 | 20.0 | 2.0 | 500 |
| CGL-8 | 81.0 | 60.0 | 2.5 | 250 |