



CATALOGUS: FREROX

PLASTIC PARTS FOR ELECTRICAL EQUIPMENT

FREROX ELECTRONICS

1

CABLEHOLDERS

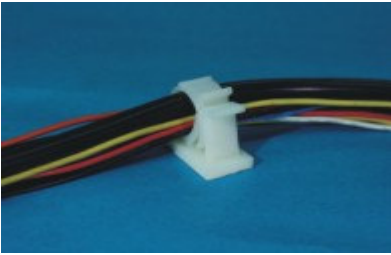

CABLE LOCKER-TAPE VERSION

AWC

MATERIAL:NYLON 66 (UL)
 FLAME CLASS:94V-2
 COLOR:NATURAL/BLACK
 UNIT:mm

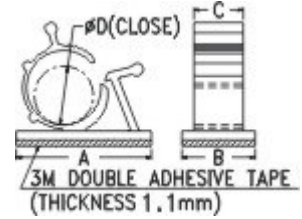

| PART NO | A | B | C | D | PACKAGE |
|---------|------|------|------|-----------|---------|
| AWC-1 | 24.8 | 18.8 | 10.2 | 7.9~10.3 | 250 |
| AWC-2 | 25.4 | 15.0 | 10.0 | 11.9~14.3 | |
| AWC-2A | 30.2 | 15.0 | 10.0 | 11.9~14.3 | |
| AWC-3 | 34.4 | 18.8 | 12.7 | 14.7~19.1 | 100 |
| AWC-4 | 36.0 | 19.0 | 12.7 | 18.0~22.0 | |
| AWC-5 | 39.8 | 19.8 | 13.0 | 22.0~26.5 | |



CABLE CLIP

OCCB-15

MATERIAL:NYLON 66 (UL)
 FLAME CLASS:94V-2
 COLOR:BLACK

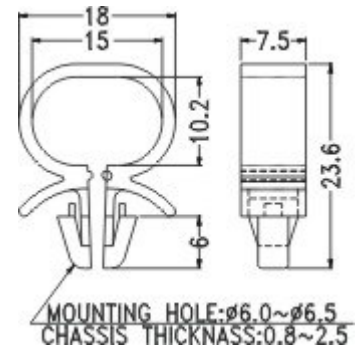

| PART NO | PACKAGE |
|---------|---------|
| OCCB-15 | 500 |



CABLE HOLDER

MWS

MATERIAL:NYLON 66 (UL)
 FLAME CLASS:94V-2
 COLOR:NATURAL
 UNIT:mm

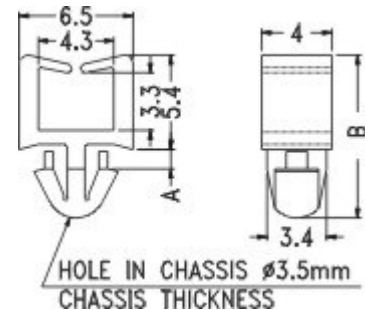

| PART NO. | A | B | CHASSIS THICKNESS |
|----------|-----|------|-------------------|
| MWS-13 | 1.1 | 9.3 | 1.0 mm |
| MWS-14 | 4.1 | 12.3 | 4.0 mm |

CABLE HOLDER

MWS-11

MATERIAL: NYLON 66 (UL)
 FLAME CLASS: 94V-2
 COLOR: NATURAL
 UNIT: mm

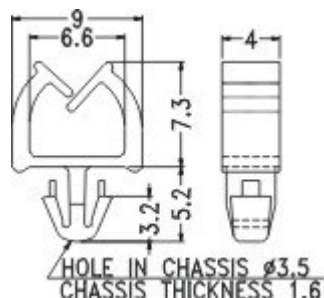

| PARTNO | PACKAGE |
|--------|---------|
| MWS-11 | 1000 |

CABLE HOLDER

MWS-10

MATERIAL: NYLON 66 (UL)
 FLAME CLASS: 94V-2
 COLOR: BLACK
 UNIT: mm

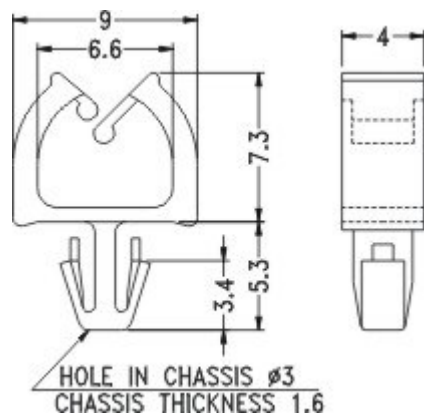

| PARTNO | PACKAGE |
|--------|---------|
| MWS-10 | 1000 |

WIRE SADDLE

MWS-12

MATERIAL: NYLON 66 (UL)
 FLAME CLASS: 94V-2
 COLOR: NATURAL
 UNIT: mm

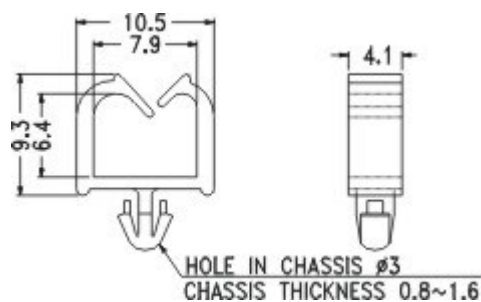

| PARTNO | PACKAGE |
|--------|---------|
| MWS-12 | 1000 |

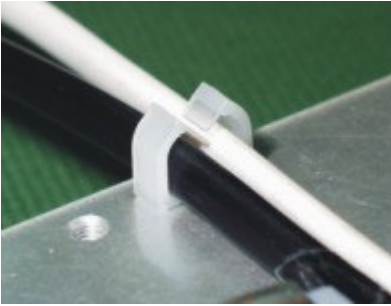

WIRE SADDLE

MWS-15

MATERIAL: NYLON 66 (UL)
 FLAME CLASS: 94V-2
 COLOR: NATURAL
 UNIT: mm

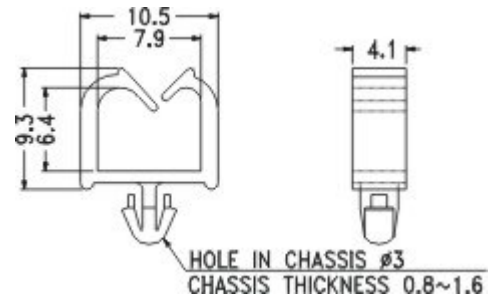

| PARTNO | PACKAGE |
|--------|---------|
| MWS-15 | 1000 |

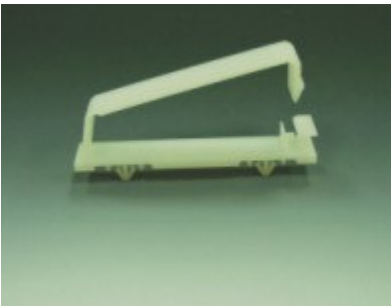

FLAT CABLE CLAMP

FCT-4

MATERIAL: NYLON 66 (UL)
 FLAME CLASS: 94V-2
 COLOR: NATURAL
 UNIT: mm

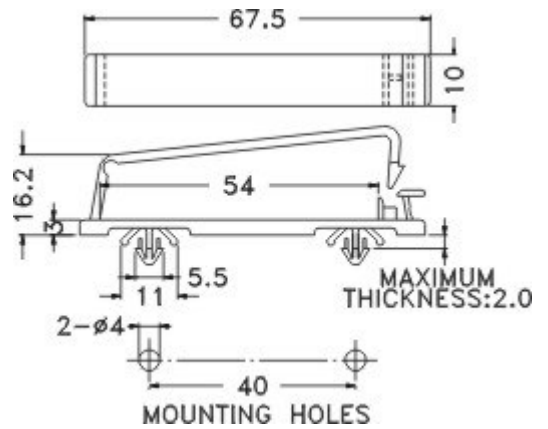

| PARTNO | PACKAGE |
|--------|---------|
| FCT-4 | 100 |



FLAT CABLE CLAMP

FCT

MATERIAL: NYLON 66 (UL)
 FLAME CLASS: 94V-2
 COLOR: NATURAL
 UNIT: mm

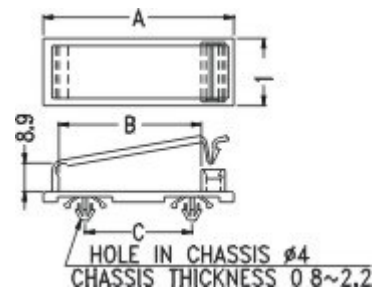

| PARTNO | A | B | C | PACKAGE |
|--------|------|------|------|---------|
| FCT-2 | 53.5 | 40.0 | 30.0 | 50 |
| FCT-3 | 45.5 | 32.0 | 25.0 | |

CABLE CLAMP WITH ANTI-VIBRATION

CHN

MATERIAL: NYLON 66 (UL)
 FLAME CLASS: 94V-2
 COLOR: NATURAL
 UNIT: mm

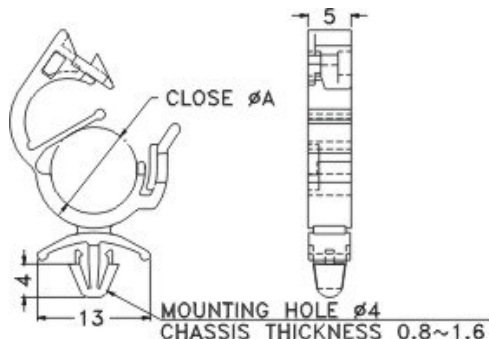

| PART NO. | CLOSE | PACKAGE |
|----------|-------|---------|
| CHN-7.6 | 7.6 | 500 |
| CHN-10 | 10.0 | |
| CHN-12 | 12.0 | |

CABLE CLAMP WITH ANTI-VIBRATION

WLO-2-2.5

MATERIAL: NYLON 66 (UL)
 FLAME CLASS: 94V-2
 COLOR: NATURAL
 UNIT: mm

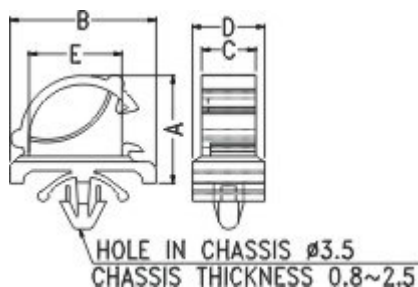

| PARTNO | PACKAGE |
|-----------|---------|
| WLO-2-2.5 | 1000 |

CABLE CLAMP WITH ANTI-VIBRATION

WLO-3

MATERIAL: NYLON 66 (UL)
 FLAME CLASS: 94V-2
 COLOR: NATURAL
 UNIT: mm

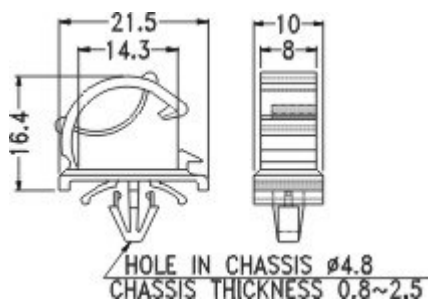

| PARTNO | PACKAGE |
|--------|---------|
| WLO-3 | 500 |

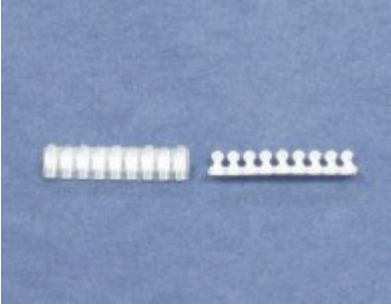

CABLE HOLDER TAPE

MU-01-8NT

MATERIAL: NYLON 66 (UL)
 FLAME CLASS: 94V-2
 COLOR: NATURAL
 UNIT: mm

| PARTNO | PACKAGE |
|-----------|---------|
| MU-01-8NT | 500 |

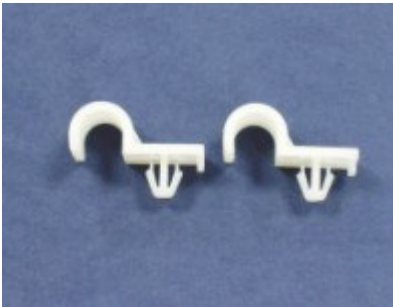
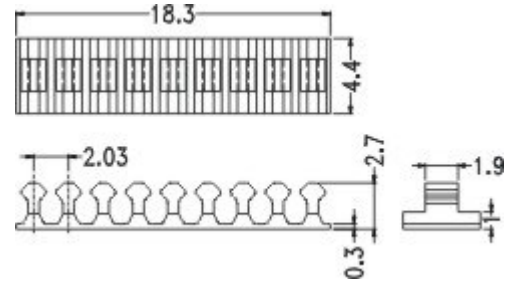

CABLE HOLDER

CLH-6

MATERIAL: NYLON 66(UL)
 FLAME CLASS: 94V-2
 COLOR: NATURAL
 UNIT: mm

| PARTNO | PACKAGE |
|--------|---------|
| CLH-6 | 500 |

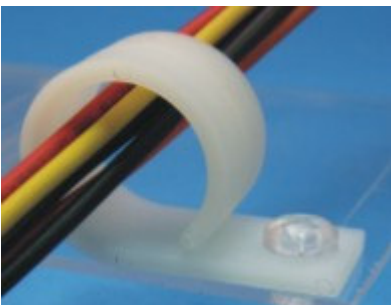
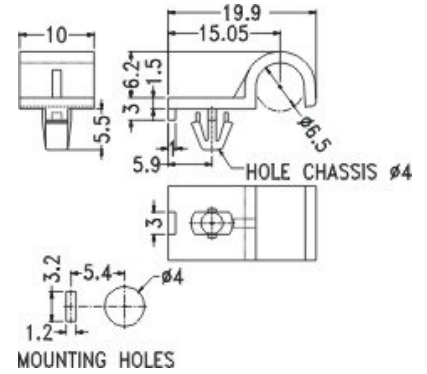

CABLE HOLDER

CD-16

MATERIAL: NYLON 66 (UL)
 FLAME CLASS: 94V-2
 COLOR: NATURAL
 UNIT: mm

| PARTNO | PACKAGE |
|--------|---------|
| CD-16 | 500 |

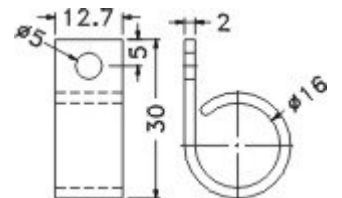

CABLE HOLDER

CD-5

MATERIAL: NYLON 66 (UL)
 FLAME CLASS: 94V-2
 COLOR: NATURAL
 UNIT: mm

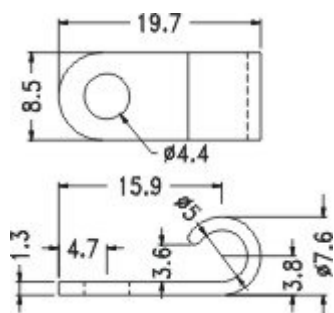

| PARTNO | PACKAGE |
|--------|---------|
| CD-5 | 500 |

CABLE HOLDER

CD-9.2

MATERIAL: NYLON 66 (UL)
 FLAME CLASS: 94V-2
 COLOR: NATURAL
 UNIT: mm

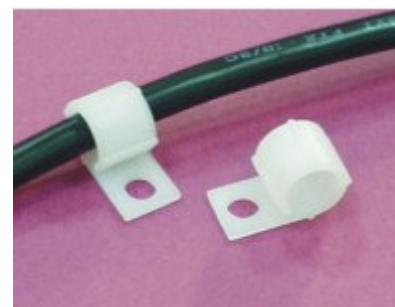
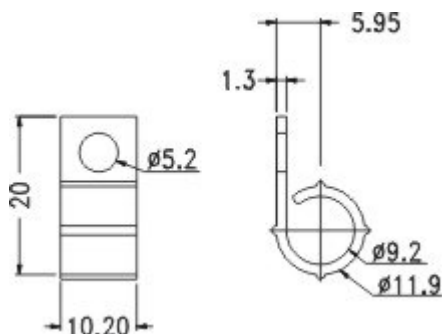

| PARTNO | PACKAGE |
|--------|---------|
| CD-9.2 | 500 |

CABLE HOLDER

CC

MATERIAL: NYLON 66 (UL)
 FLAME CLASS: 94V-2
 COLOR: NATURA/BLACK
 UNIT: mm

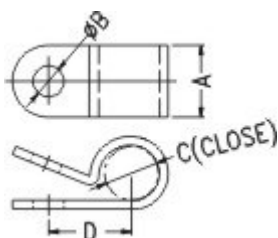

| PARTNO | A | B | C | | D | PACKAGE |
|--------|------|-----|-------|-------|------|---------|
| | | | mm | inch | | |
| CC-1SS | 6.5 | 3.8 | 3.0 | 1/8 | 6.8 | 1000 |
| CC-1S | 9.2 | 5.4 | 3.0 | 1/8 | 8.2 | |
| CC-1 | 13.2 | 5.4 | 3.0 | 1/8 | 8.9 | |
| CC-2 | 10.0 | 5.4 | 4.5 | 3/16 | 10.2 | |
| CC-3 | 9.3 | 5.0 | 6.2 | 1/4 | 10.2 | |
| CC-4 | 9.5 | 5.0 | 7.6 | 5/16 | 10.5 | |
| CC-5 | 9.5 | 4.9 | 9.0 | 3/8 | 12.5 | |
| CC-5L | 12.3 | 5.4 | 9.0 | 3/8 | 13.2 | |
| CC-6 | 12.5 | 4.9 | 11.5 | 1/2 | 14.8 | |
| CC-7 | 12.9 | 5.4 | 12.8 | 9/16 | 16.0 | |
| CC-7S | 12.9 | 4.8 | 15.5 | 5/8 | 17.1 | 200 |
| CC-8 | 12.9 | 5.4 | 17.0 | 3/4 | 20.2 | |
| CC-9 | 12.9 | 5.4 | 20.0 | 7/8 | 21.2 | 100 |
| CC-10 | 12.9 | 5.4 | 24~27 | 1-1/8 | 14.8 | |
| ★CC-12 | 9.9 | 4.4 | 3.0 | 1/8 | 8.5 | 1000 |
| ★CC-13 | 9.5 | 3.2 | 8.3 | 5/16 | 12.0 | |
| ★CC-14 | 6.3 | 3.7 | 3.5 | 1/7 | 6.4 | |



ALSO AVAILABLE IN ELECTRICAL CONDUCTIF POLYAMIDE



WIRE SADDLE TAPE

WLF-1

MATERIAL: NYLON 66 (UL)
 FLAME CLASS: 94V-2
 COLOR: NATURAL

UNIT: mm

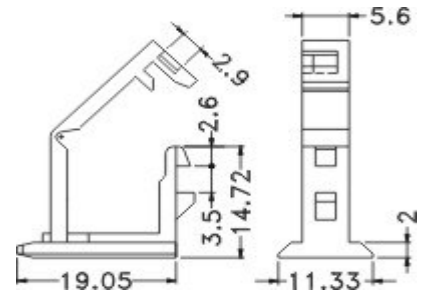

| PARTNO | PACKAGE |
|--------|---------|
| WLF-1 | 500 |



WIRE SADDLE TAPE

WLN-1

MATERIAL: NYLON 66 (UL)
 FLAME CLASS: 94V-2
 COLOR: NATURAL

UNIT: mm

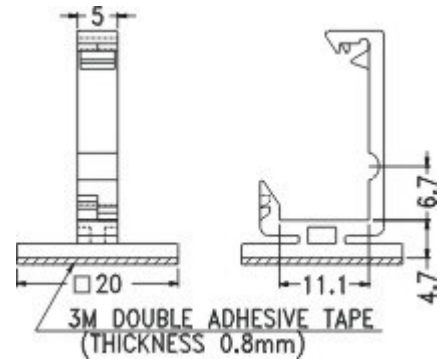

| PARTNO | PACKAGE |
|--------|---------|
| WLN-1 | 500 |

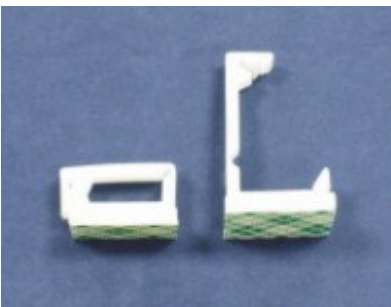

WIRE SADDLE TAPE

WLN-1S

MATERIAL: NYLON 66 (UL)
 FLAME CLASS: 94V-2
 COLOR: NATURAL

UNIT: mm

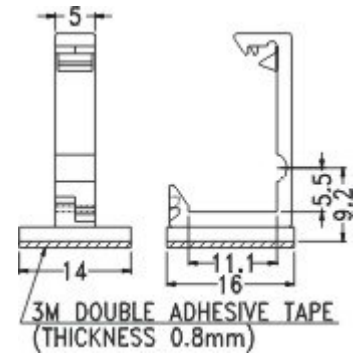

| PARTNO | PACKAGE |
|--------|---------|
| WLN-1S | 500 |

WIRE SADDLE TAPE

WLM-1

MATERIAL: NYLON 66 (UL)
 FLAME CLASS: 94V-2
 COLOR: NATURAL
 UNIT: mm

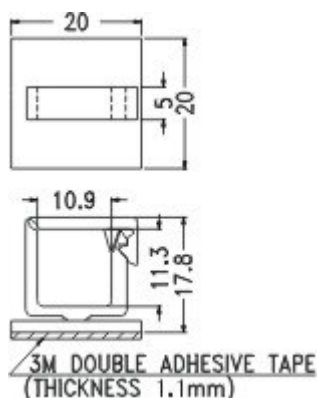

| PARTNO | PACKAGE |
|--------|---------|
| WLM-1 | 500 |

WIRE SADDLE

CHU-1

MATERIAL: NYLON 66 (UL)
 FLAME CLASS: 94V-2
 COLOR: NATURAL
 UNIT: mm

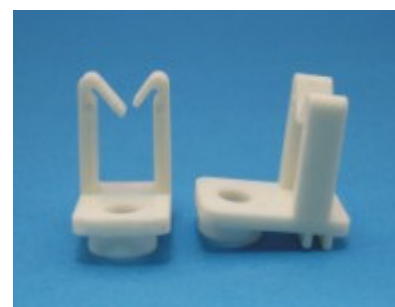
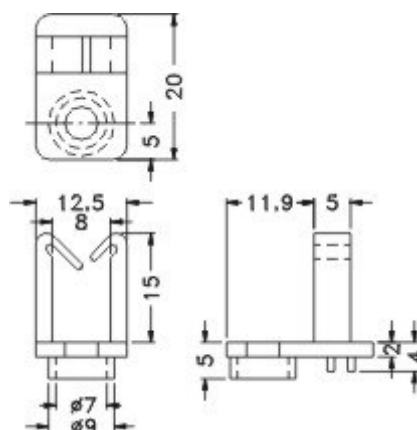

| PARTNO | PACKAGE |
|--------|---------|
| CHU-1 | 1000 |

WIRE SADDLE

IMN-1

MATERIAL: NYLON 66 (UL)
 FLAME CLASS: 94V-2
 COLOR: NATURAL
 UNIT: mm

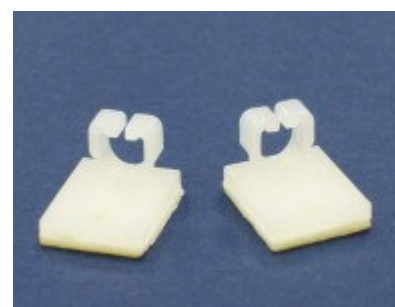
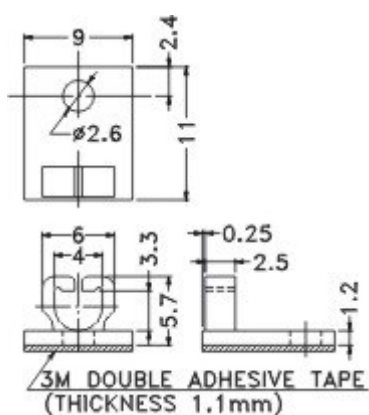

| PARTNO | PACKAGE |
|--------|---------|
| IMN-1 | 1000 |

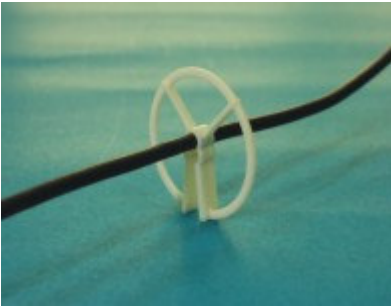

H.V. CABLE HOLDER

FBT

MATERIAL: NYLON 66(UL)
 FLAME CLASS: 94V-2
 COLOR: NATURAL
 UNIT: mm

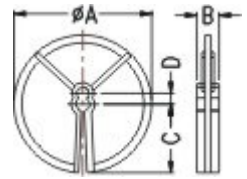

| PART NO | A | B | C | D | FIT CABLE | PACKAGE |
|---------|------|-----|------|-----|-----------------------|---------|
| FBT-1 | 49.5 | 7.8 | 22.0 | 5.0 | 4.5~5.3 | 100 |
| FBT-2 | 49.2 | 7.8 | 22.0 | 5.0 | 3.5~4.5 | |
| FBT-3 | 50.2 | 7.4 | 23.0 | 5.0 | 2.5~3.5 | |
| FBT-4 | 49.5 | 8.0 | 22.7 | 5.0 | 4.0~5.0 or 5.0~5.5 | |
| FBT-5 | 49.2 | 7.0 | 22.0 | 4.7 | 3.7~4.2 or 4.5~5.2 | |



WIRE CLAMP

SQG-1

MATERIAL: NYLON 66(UL)
 FLAME CLASS: 94V-2
 COLOR: NATURAL
 UNIT: mm

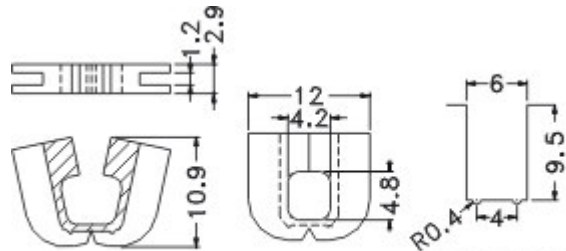

MOUNTING HOLE
 MAXIMUM THICKNESS: 0.8~1.0

| PARTNO | PACKAGE |
|--------|---------|
| SQG-1 | 500 |

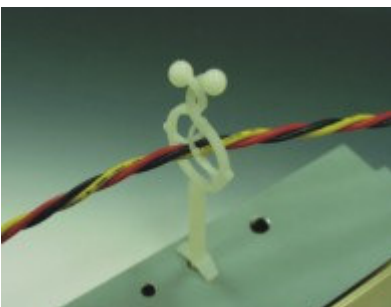

HV WIRE SPACER

THF-1

MATERIAL: NYLON 66 (UL)
 FLAME CLASS: 94V-0
 COLOR: NATURAL
 UNIT: mm

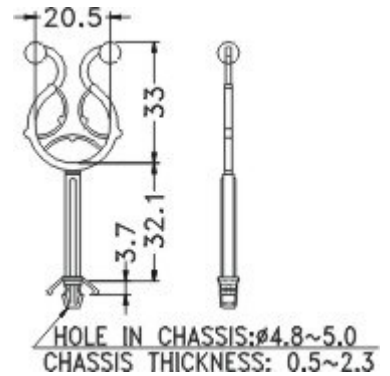

| PARTNO | PACKAGE |
|--------|---------|
| THF-1 | 500 |

FLAT CABLE CLAMP

FCT-1

MATERIAL: NYLON 66 (UL)
 FLAME CLASS: 94V-2
 COLOR: NATURAL
 UNIT: mm

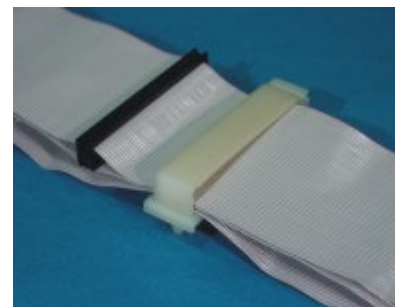
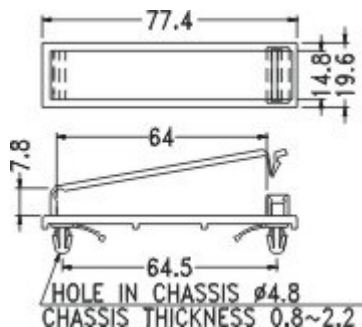

| PARTNO | PACKAGE |
|--------|---------|
| FCT-1 | 50 |

TY-WRAP HOLDER

ASUS-1

MATERIAL: NYLON 66
 FLAME CLASS: UL94V-2
 COLOR: BLACK
 UNIT: mm

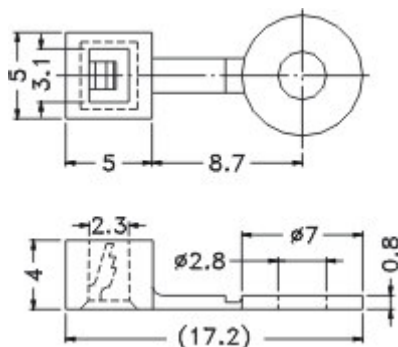

| PARTNO | PACKAGE |
|--------|---------|
| ASUS-1 | 1000 |

TY WRAP HOLDER

CCMW-1

MATERIAL: NYLON (UL)
 FLAME CLASS: 94V-2
 COLOR: NATURAL
 UNIT: mm

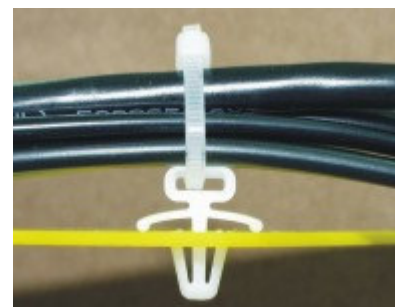
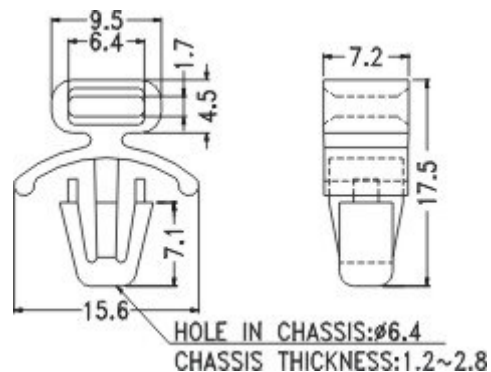

| PARTNO | PACKAGE |
|--------|---------|
| CCMW-1 | 1000 |



SPIRAL TUBE

KYST

SPIRAL WRAP MATERIAL:PE
 SPIRAL WRAP COLOR:NATURAL
 CLAMP MATERIAL:ABS
 UNIT:mm

| PART NO | INTERNAL øD (mm) | MAX DIA (mm) | PITCH P (mm) | THICKNESS T (mm) | LENGTH (M) |
|---------|---------------------|-----------------|-----------------|---------------------|---------------|
| KYST-8 | 8.0 | 10.0 | 10.0 | 0.8 | 5 |
| KYST-15 | 15.0 | 16.0 | 14.0 | 0.8 | 5 |
| KYST-20 | 20.0 | 23.0 | 17.0 | 0.9 | 5 |
| KYST-25 | 25.0 | 29.0 | 20.0 | 1.0 | 5 |

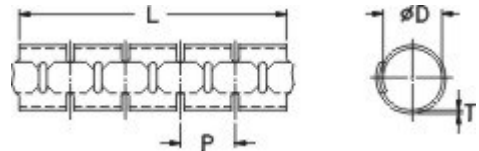

SPIRAL TUBE TOOL

KST

SPIRAL WRAP MATERIAL:PE
 SPIRAL WRAP COLOR:NATURAL
 CLAMP MATERIAL:ABS
 UNIT:mm

| PART NO | THE SUITABLE FOR FAST SPIRAL WRAPPING BAND |
|---------|--|
| KST-08 | KYST-8 |
| KST-15 | KYST-15 |
| KST-20 | KYST-20 |
| KST-25 | KYST-25 |

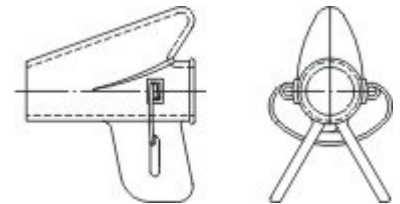

FIBER-ROLLER

FSB-2

MATERIAL:NYLON(UL)
 FLAME CLASS:94V-2
 COLOR:NATURAL
 UNIT:mm

| PARTNO | PACKAGE |
|--------|---------|
| FSB-2 | 50 |

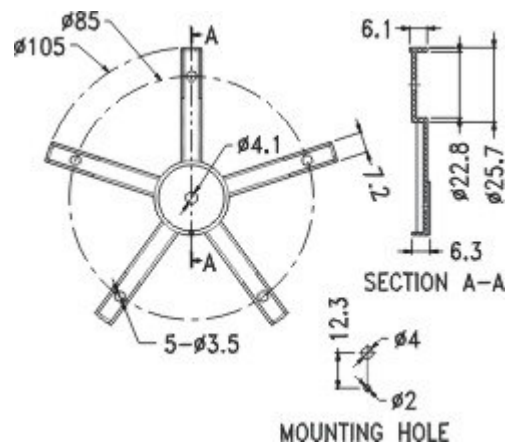

FIBER-ROLLER

FSB

MATERIAL: NYLON(UL)
 FLAME CLASS: 94V-2
 COLOR: NATURAL
 UNIT: mm

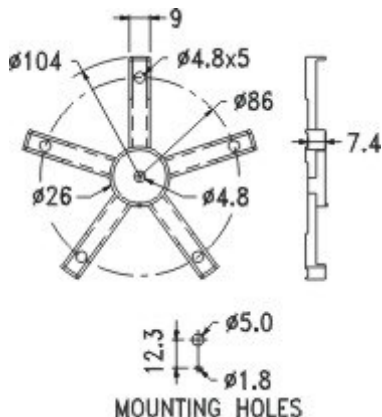

| PARTNO | FITTING | PACKAGE |
|--------|----------|---------|
| FSB-1 | Screw | 50 |
| FSB-1A | Adhesive | |

FLAT CABLE CLIP

FCG-15

MATERIAL: NYLON 66 (UL)
 FLAME CLASS: 94V-2
 COLOR: NATURAL/GRAY
 UNIT: mm

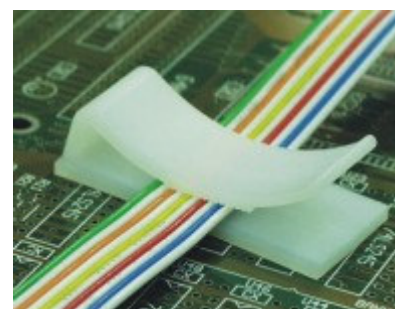
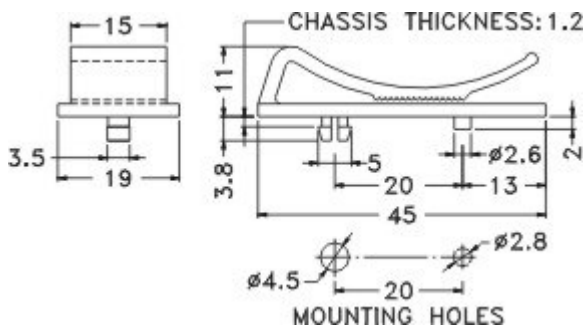

| PARTNO | PACKAGE |
|--------|---------|
| FCG-15 | 1000 |

FLAT CABLE CLIP

FCCT-12

MATERIAL: NYLON 66 (UL)
 FLAME CLASS: 94V-2
 COLOR: NATURAL
 UNIT: mm

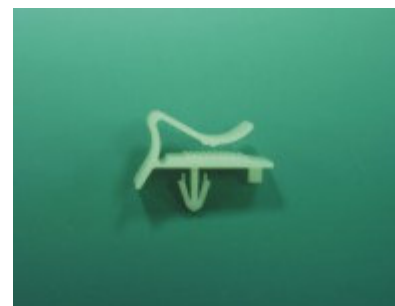
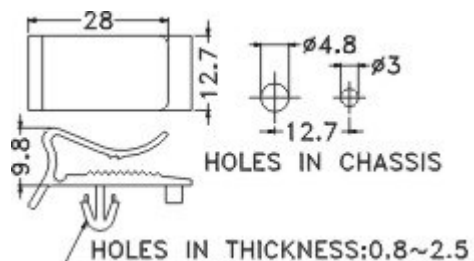

| PARTNO | PACKAGE |
|---------|---------|
| FCCT-12 | 500 |

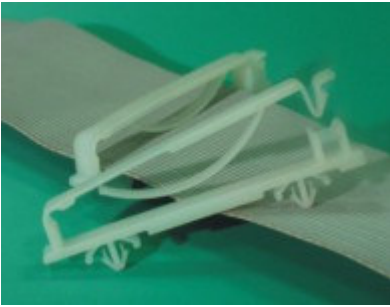

| PARTNO | PACKAGE |
|--------|---------|
| FDT-4 | 100 |

FLAT CABLE CLIP

FDT-4

MATERIAL:NYLON 66 (UL)
 FLAME CLASS:94V-2
 COLOR:NATURAL
 UNIT:mm

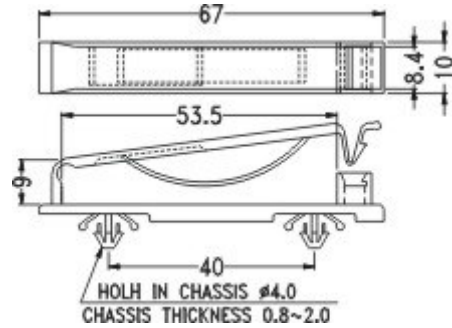

| PARTNO | PACKAGE |
|--------|---------|
| FCD-1 | 50 |

FLAT CABLE CLIP

FCD-1

MATERIAL:NYLON 66 (UL)
 FLAME CLASS:94V-2
 COLOR:NATURAL
 UNIT:mm

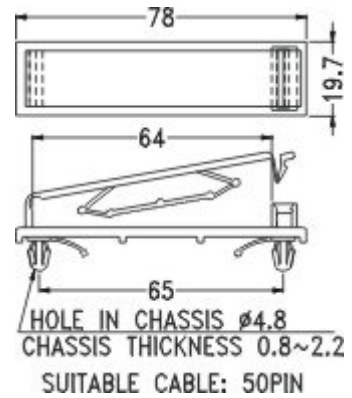

FLAT CABLE CLIP

FCD

MATERIAL:NYLON 66 (UL)
 FLAME CLASS:94V-2
 COLOR:NATURAL
 UNIT:mm

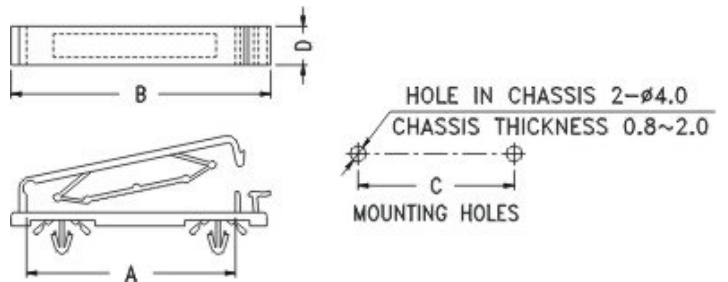

| PARTNO | A | B | C | D | SUITABLE CABLE | PACKAGE |
|--------|------|------|------|------|----------------|---------|
| FCD-40 | 54.1 | 65.6 | 40.0 | 10.2 | 40 PIN | 100 |
| FCD-50 | 64.3 | 77.0 | 49.7 | 10.0 | 50 PIN | |

FLAT CABLE CLIP

FCH

MATERIAL: NYLON 66 (UL)
 FLAME CLASS: 94V-2
 COLOR: GRAY
 UNIT: mm

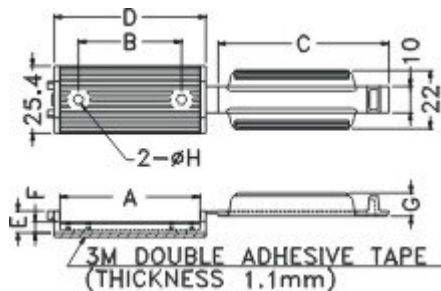

| PART NO. | A | B | C | D | E | F | G | H | PACKAGE |
|----------|-------|------|------|------|------|-----|-----|-----|---------|
| FCH-50 | 53.0 | 39.0 | 64.6 | 57.3 | 8.3 | 4.1 | 8.8 | 3.7 | 50 |
| FCH-80 | 78.93 | 38.7 | 90.6 | 82.3 | 12.3 | 6.3 | 7.6 | 3.8 | 50 |

FLAT CABLE CLIP

FCH-30

MATERIAL: NYLON 66 (UL)
 FLAME CLASS: 94V-2
 COLOR: GRAY
 UNIT: mm

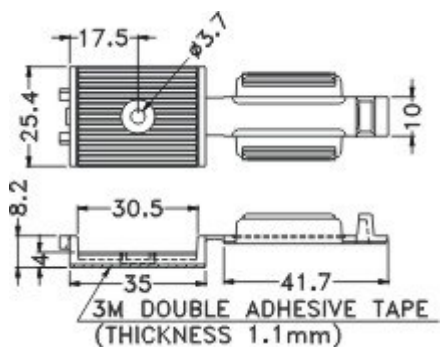

| PARTNO | PACKAGE |
|--------|---------|
| FCH-30 | 100 |

FLAT CABLE CLIP

FCL-33

MATERIAL: NYLON 66 (UL)
 FLAME CLASS: 94V-2
 COLOR: NATURAL
 UNIT: mm

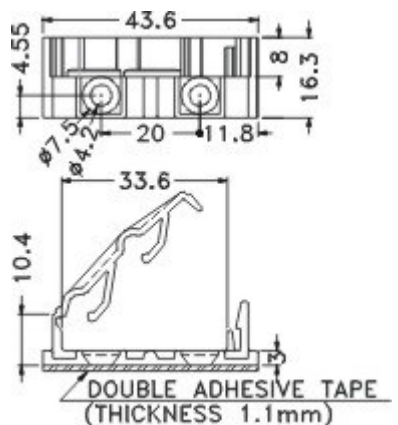

| PARTNO | PACKAGE |
|--------|---------|
| FCL-33 | 100 |

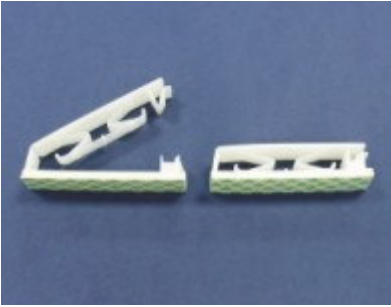

FLAT CABLE CLIP

FCK-50

MATERIAL: NYLON 66 (UL)
 FLAME CLASS: 94V-2
 COLOR: NATURAL
 UNIT: mm

| PARTNO | PACKAGE |
|--------|---------|
| FCK-50 | 100 |

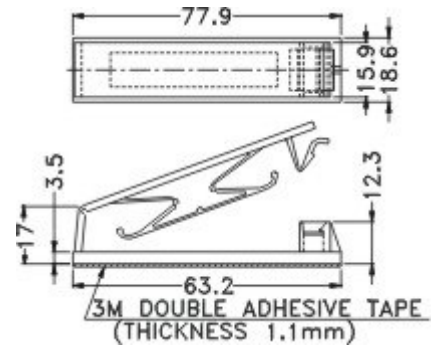

FLAT CABLE CLIP

FCE-3

MATERIAL: NYLON 66 (UL)
 FLAME CLASS: 94V-2
 COLOR: NATURAL
 UNIT: mm

| PARTNO | PACKAGE |
|--------|---------|
| FCE-3 | 100 |

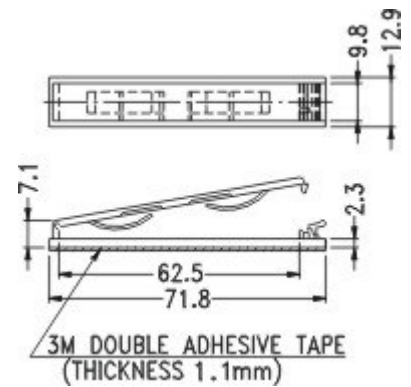

FLAT CABLE CLIP

FCJ-40

MATERIAL: NYLON 66 (UL)
 FLAME CLASS: 94V-2
 COLOR: NATURAL
 UNIT: mm

| PARTNO | PACKAGE |
|--------|---------|
| FCJ-40 | 100 |

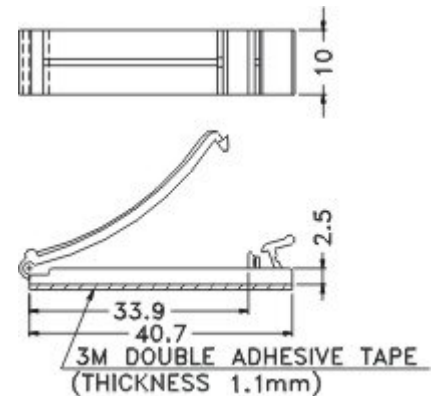

FLAT CABLE CLIP

FCE

MATERIAL: NYLON 66 (UL)
 FLAME CLASS: 94V-2
 COLOR: NATURAL
 UNIT: mm

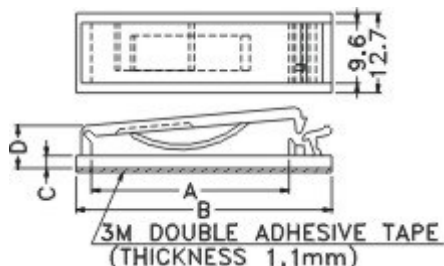

| PART NO. | A | B | C | D | PACKAGE |
|----------|------|------|-----|-----|---------|
| FCE-1 | 31.5 | 40.7 | 2.0 | 6.8 | 200 |
| FCE-2 | 52.0 | 61.2 | 2.1 | 6.9 | 100 |

FLAT CABLE CLIP

FCI-2

MATERIAL: NYLON 66 (UL)
 FLAME CLASS: 94V-2
 COLOR: NATURAL
 UNIT: mm

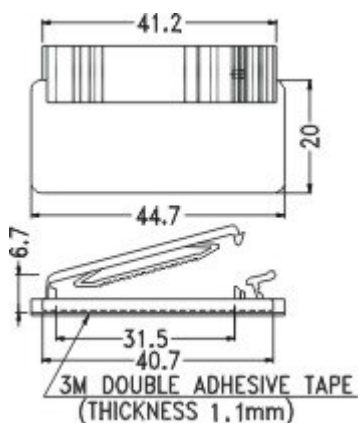
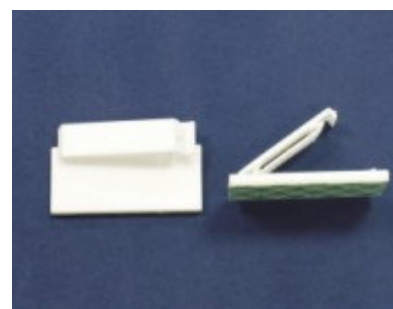

| PARTNO | PACKAGE |
|--------|---------|
| FCI-2 | 100 |

FLAT CABLE CLIP

FCI-1

MATERIAL: NYLON 66 (UL)
 FLAME CLASS: 94V-2
 COLOR: NATURAL
 UNIT: mm

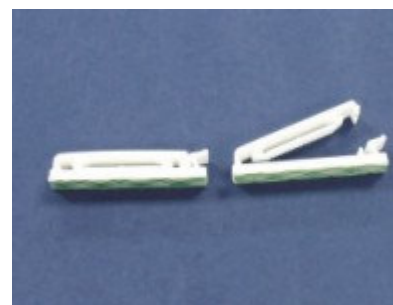

| PARTNO | PACKAGE |
|--------|---------|
| FCI-1 | 200 |



FLAT CABLE CLIP

FCB-40MT

MATERIAL:NYLON 66 (UL)
 FLAME CLASS:94V-2
 COLOR:NATURAL
 UNIT:mm

| PARTNO | PACKAGE |
|----------|---------|
| FCB-40MT | 100 |

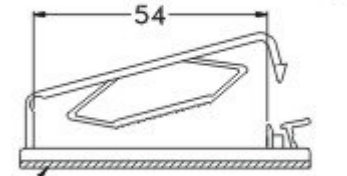
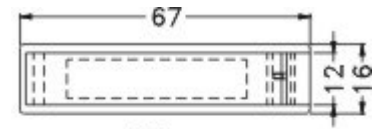

3M DOUBLE ADHESIVE TYPE
 (THICKNESS 1.1mm)
 SUITABLE CABLE: 40 PIN

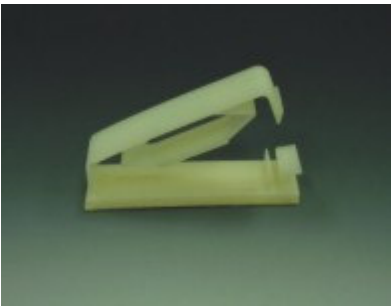

FLAT CABLE CLIP

FCB-40M

MATERIAL:NYLON 66 (UL)
 FLAME CLASS:94V-2
 COLOR:NATURAL
 UNIT:mm

| PARTNO | PACKAGE |
|---------|---------|
| FCB-40M | 100 |

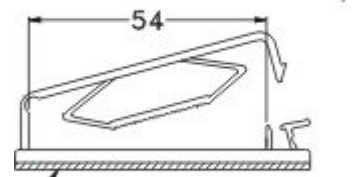
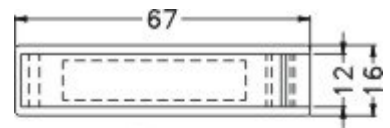

3M DOUBLE ADHESIVE TYPE
 (THICKNESS 1.1mm)
 SUITABLE CABLE: 40 PIN



FLAT CABLE CLIP

FCB

MATERIAL:NYLON 66 (UL)
 FLAME CLASS:94V-2
 COLOR:NATURAL
 UNIT:mm

| PARTNO | A | B | C | SUITABLE CABLE | PACKAGE |
|--------|------|------|------|----------------|---------|
| FCB-40 | 53.8 | 65.0 | 10.2 | 40 PIN | 200 |
| FCB-50 | 64.5 | 76.5 | 10.0 | 50 PIN | 100 |

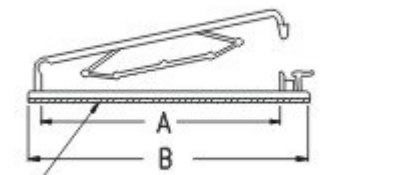
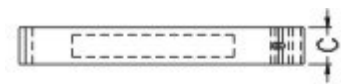

3M DOUBLE ADHESIVE TAPE
 (THICKNESS 1.1mm)

FLAT CABLE CLIP

FCB-1

MATERIAL: NYLON 66 (UL)
 FLAME CLASS: 94V-2
 COLOR: NATURAL
 UNIT: mm

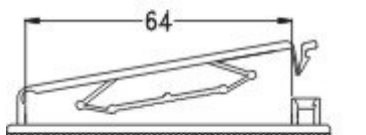
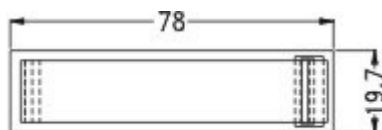

3M DOUBLE ADHESIVE TAPE
 (THICKNESS 1.1mm)
 SUITABLE CABLE: 50PIN



| PARTNO | PACKAGE |
|--------|---------|
| FCB-1 | 100 |

FLAT CABLE CLIP

FCA

MATERIAL: NYLON 66 (UL)
 FLAME CLASS: 94V-2
 COLOR: NATURAL
 UNIT: mm

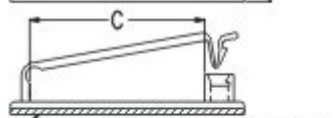
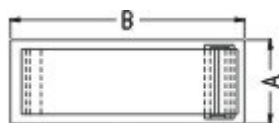

3M DOUBLE ADHESIVE TAPE
 (THICKNESS 1.1mm)

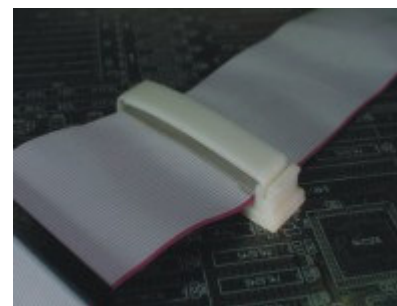

| PART NO. | A | B | C | PACKAGE |
|----------|------|------|------|---------|
| FCA-1 | 19.7 | 77.6 | 64.0 | 50 |
| FCA-2 | 19.0 | 53.5 | 40.0 | 100 |
| FCA-3 | 19.0 | 45.5 | 32.0 | 200 |
| FCA-5 | 19.8 | 45.4 | 31.8 | |

FLAT CABLE CLIP

FCE-30

MATERIAL: NYLON 66 (UL)
 FLAME CLASS: 94V-2
 COLOR: NATURAL
 UNIT: mm

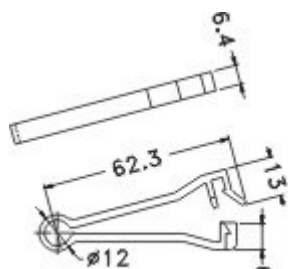

SUITABLE CABLE: 30 PIN

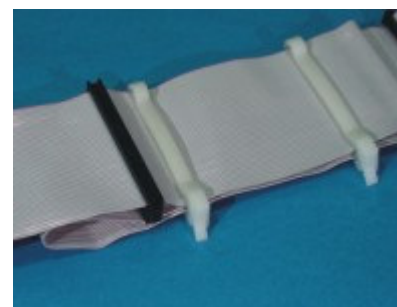

| PARTNO | PACKAGE |
|--------|---------|
| FCE-30 | 100 |

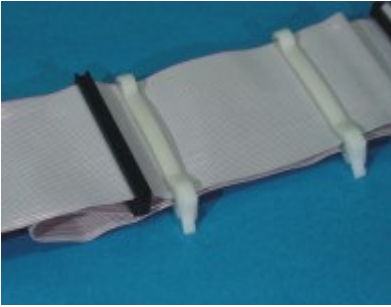

FLAT CABLE CLIP

FCE-40

MATERIAL:NYLON 66 (UL)
 FLAME CLASS:94V-2
 COLOR:NATURAL
 UNIT:mm

| PARTNO | PACKAGE |
|--------|---------|
| FCE-40 | 100 |

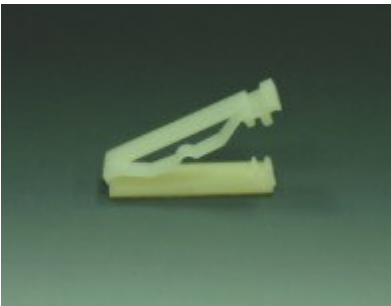
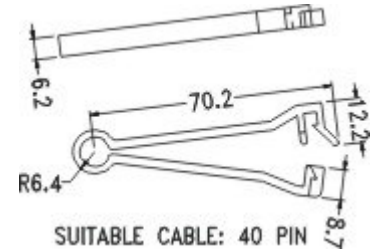

FLAT CABLE CLIP

FCS-20

MATERIAL:NYLON 66 (UL)
 FLAME CLASS:94V-2
 COLOR:NATURAL
 UNIT:mm

| PARTNO | PACKAGE |
|--------|---------|
| FCS-20 | 200 |

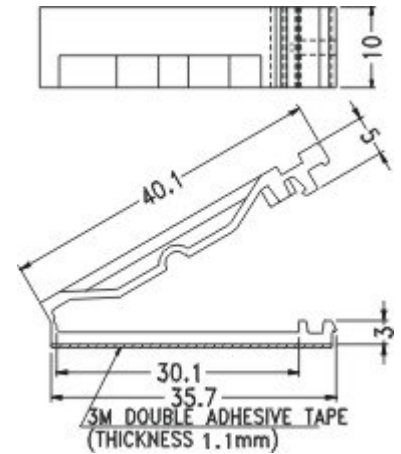

FLAT CABLE CLIP

FC-19L

MATERIAL:NYLON 66 (UL)
 FLAME CLASS:94V-2
 COLOR:NATURAL
 UNIT:mm

| PARTNO | PACKAGE |
|--------|---------|
| FC-19L | 500 |

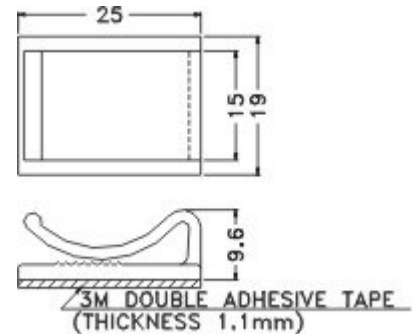

FLAT CABLE CLIP

FCN

MATERIAL: NYLON 66 (UL)
 FLAME CLASS: 94V-2
 COLOR: NATURAL
 UNIT: mm

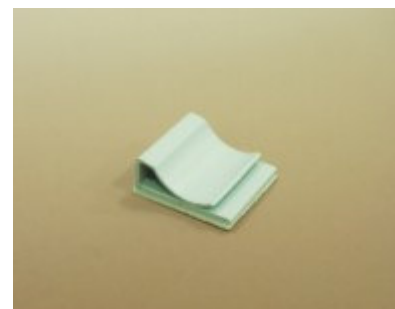
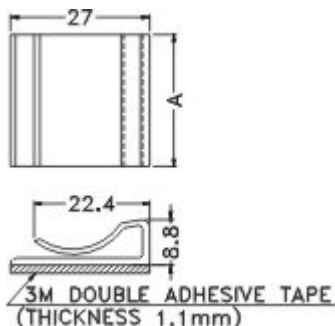

| PARTNO | A | PACKAGE |
|--------|------|---------|
| FCN-15 | 15.0 | 500 |
| FCN-20 | 20.0 | |
| FCN-25 | 25.0 | |

FLAT CABLE CLIP

FCC

MATERIAL: PVC
 COLOR: GRAY
 UNIT: mm

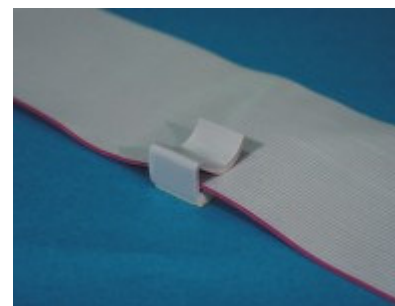
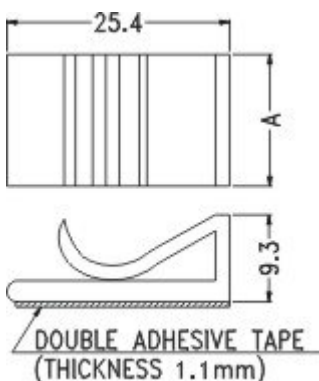

| PARTNO | A | PACKAGE |
|--------|------|---------|
| FCC-15 | 15.0 | 500 |
| FCC-20 | 20.0 | |
| FCC-25 | 25.0 | 250 |

FLAT CABLE CLIP

FC-19

MATERIAL: NYLON 66 (UL)
 FLAME CLASS: 94V-2
 COLOR: NATURAL
 UNIT: mm

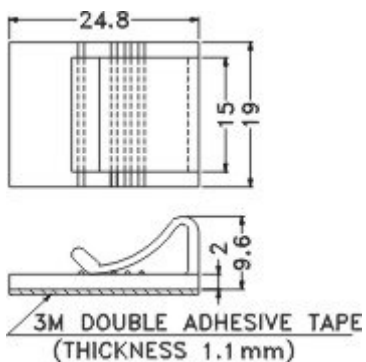

| PARTNO | PACKAGE |
|--------|---------|
| FC-19 | 500 |

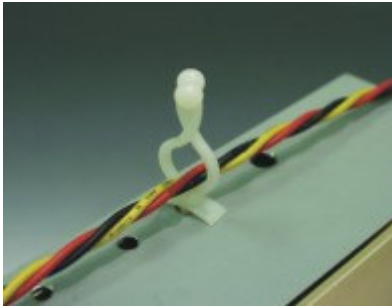

CABLE TWISTER

THI-4

MATERIAL:NYLON 66 (UL)
 FLAME CLASS:94V-2
 COLOR:NATURAL
 UNIT:mm

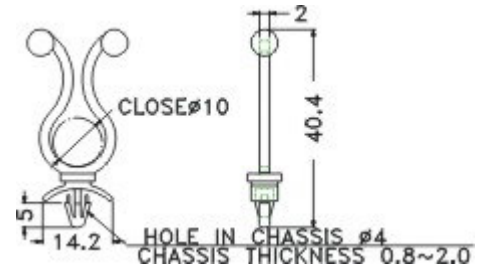

| PARTNO | PACKAGE |
|--------|---------|
| THI-4 | 500 |

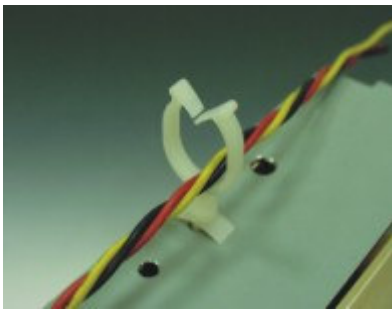

CABLE LOCKER

THE-9

MATERIAL:NYLON 66 (UL)
 FLAME CLASS:94V-2
 COLOR:NATURAL
 UNIT:mm

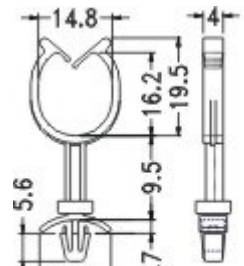

BOARD THICKNESS:0.5~2.3
 MOUNTING HOLE:Ø4.8~5.0

| PARTNO | PACKAGE |
|--------|---------|
| THE-9 | 500 |

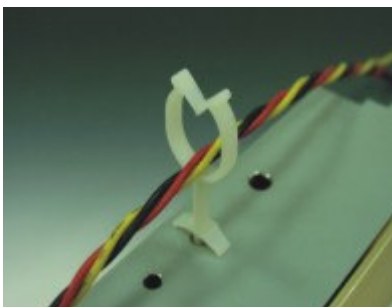

CABLE LOCKER

THE

MATERIAL:NYLON 66 (UL)
 FLAME CLASS:94V-2/94V-0
 COLOR:NATURAL
 UNIT:mm

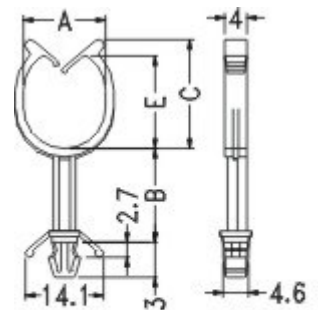

BOARD THICKNESS:D
 MOUNTING HOLE:Ø4.8~5.0

| PARTNO | A | B | C | D | E | PACKAGE |
|--------|------|------|------|---------|------|---------|
| THE-12 | 14.8 | 12.7 | 19.5 | 0.5~2.3 | 16.2 | 500 |
| THE-17 | 14.8 | 16.8 | 19.5 | 0.5~2.3 | 16.2 | |
| THE-25 | 14.8 | 25.0 | 19.5 | 0.5~2.3 | 16.2 | |
| THE-37 | 14.8 | 36.8 | 19.5 | 0.5~2.3 | 16.2 | |



CABLE SADDLE

CHD15-34

MATERIAL: NYLON 66(UL)
 FLAME CLASS: 94V-2
 COLOR: NATURAL
 UNIT: mm

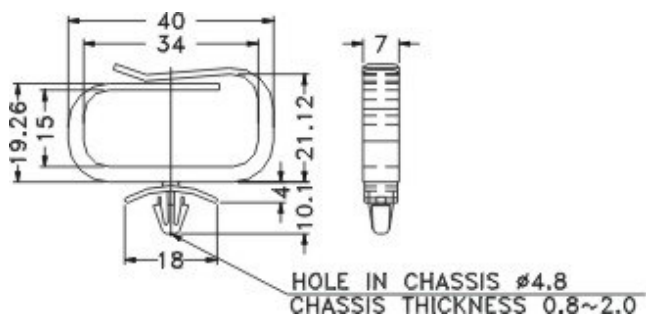

| PARTNO | PACKAGE |
|----------|---------|
| CHD15-34 | 250 |

CABLE SADDLE

CHF

MATERIAL: NYLON 66 (UL)
 FLAME CLASS: 94V-2
 COLOR: NATURAL
 UNIT: mm

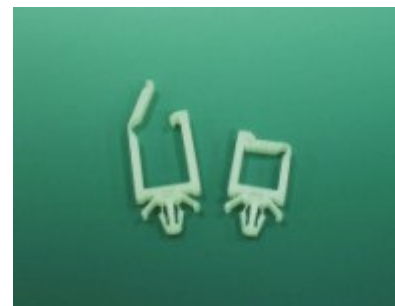
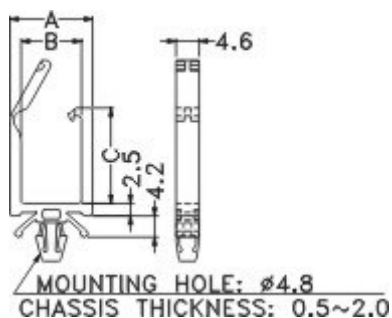

| PARTNO. | A | B | C | PACKAGE |
|---------|------|------|------|---------|
| CHF-1 | 16.4 | 12.0 | 19.0 | 500 |
| CHF-2 | 14.4 | 10.4 | 14.0 | |

CABLE TWISTER

THD

MATERIAL: NYLON 66 (UL)
 FLAME CLASS: 94V-2
 COLOR: NATURAL
 UNIT: mm

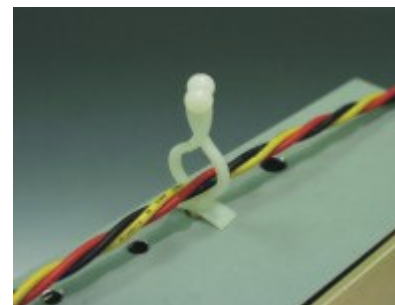
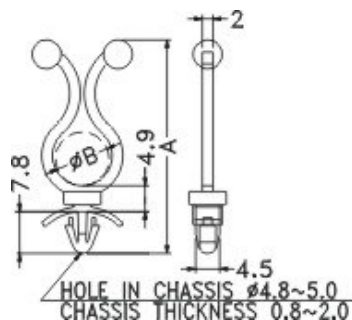

| PARTNO | A | B | CLOSE B | PACKAGE |
|--------|------|------|---------|---------|
| THD-1 | 40.2 | 10.8 | 9.8 | 500 |
| THD-2 | 49.4 | 18.7 | 17.1 | |

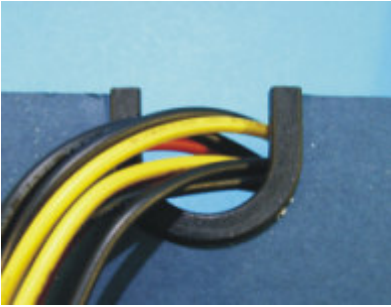

WIRE PROTECTOR

SQH

MATERIAL:NYLON 66(UL)
 FLAME CLASS:94V-2
 COLOR:BLACK
 UNIT:mm

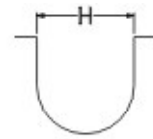
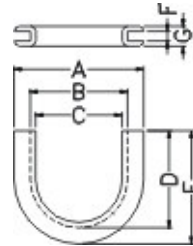

CHASSIS IS THICKNESS:1.7

| PART NO. | A | B | C | D | E | F | G | H | PACKAGE |
|----------|------|------|------|------|------|-----|-----|------|---------|
| SQH-1 | 24.0 | 18.0 | 16.0 | 18.0 | 21.0 | 1.8 | 3.7 | 18.0 | 500 |
| SQH-2 | 24.3 | 19.3 | 17.5 | 24.5 | 27.0 | 1.9 | 3.9 | 19.3 | |



WIRE SADDLE

SQF-1

MATERIAL:NYLON 66(UL)
 FLAME CLASS:94V-2
 COLOR:NATURAL/BLACK
 UNIT:mm

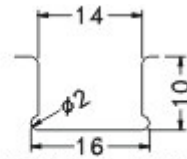
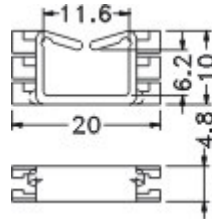

MOUNTING HOLE

CHASSIS THICKNESS:0.8~1.2

| PARTNO | PACKAGE |
|--------|---------|
| SQF-1 | 500 |



WIRE SADDLE

SQD-1

MATERIAL:NYLON 66(UL)
 FLAME CLASS:94V-2
 COLOR:NATURAL
 UNIT:mm

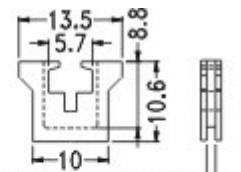

CHASSIS THICKNESS 0.8~2.0



MOUNTING HOLE

| PARTNO | PACKAGE |
|--------|---------|
| SQD-1 | 1000 |

WIRE SADDLE

SQE

MATERIAL: NYLON 66(UL)
 FLAME CLASS: 94V-2
 COLOR: NATURAL
 UNIT: mm

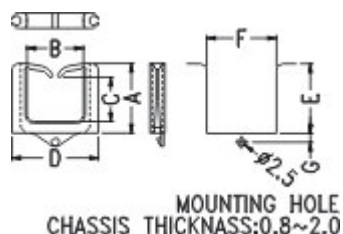
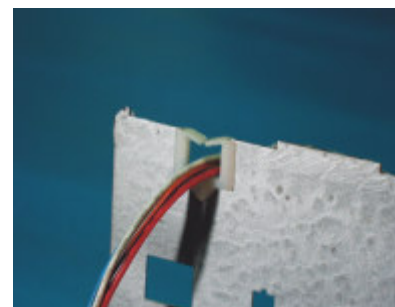

| PARTNO | A | B | C | D | E | F | G | PACKAGE |
|--------|------|------|------|------|------|------|-----|---------|
| SQE-1 | 12.1 | 11.5 | 7.3 | 19.8 | 12.3 | 14.0 | 2.8 | 1000 |
| SQE-2 | 21.0 | 17.0 | 14.0 | 26.0 | 21.0 | 21.0 | 2.7 | |
| SQE-3 | 28.8 | 22.7 | 22.4 | 33.2 | 29.0 | 27.0 | 2.8 | 500 |

WIRE SADDLE

SQB-5

MATERIAL: NYLON 66(UL)
 FLAME CLASS: 94V-2
 COLOR: BLACK
 UNIT: mm

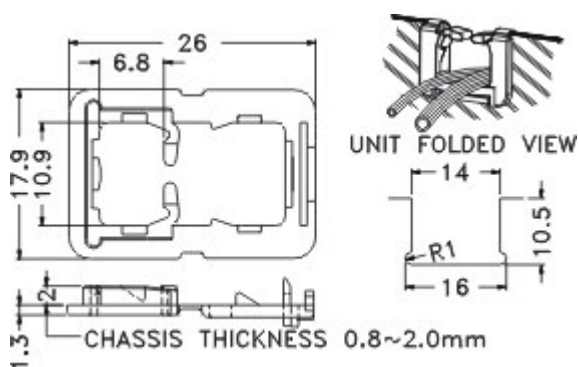

| PARTNO | PACKAGE |
|--------|---------|
| SQB-5 | 500 |

WIRE SADDLE

SQB-4

MATERIAL: NYLON 66(UL)
 FLAME CLASS: 94V-2
 COLOR: BLACK
 UNIT: mm

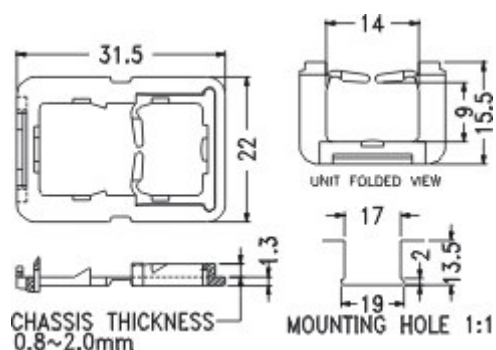

| PARTNO | PACKAGE |
|--------|---------|
| SQB-4 | 500 |



WIRE SADDLE

SQB-3

MATERIAL: NYLON 66(UL)
 FLAME CLASS: 94V-2
 COLOR: BLACK
 UNIT: mm

| PARTNO | PACKAGE |
|--------|---------|
| SQB-3 | 500 |

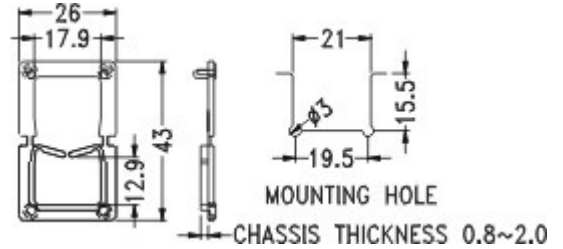

WIRE SADDLE

SQB-1

MATERIAL: NYLON 66(UL)
 FLAME CLASS: 94V-2
 COLOR: BLACK
 UNIT: mm

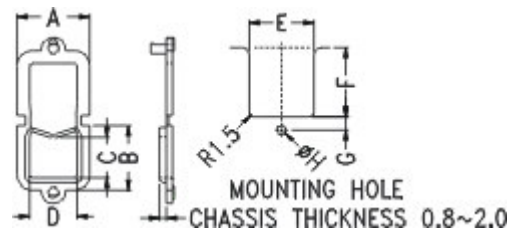

| PARTNO | A | B | C | D | E | F | G | H | PACKAGE |
|--------|------|------|------|------|------|------|-----|-----|---------|
| SQB-1 | 18.4 | 14.5 | 8.9 | 11.0 | 14.0 | 12.3 | 2.7 | 2.7 | 500 |
| SQB-2 | 21.4 | 18.7 | 12.0 | 14.0 | 17.2 | 18.5 | 3.5 | 3.0 | |



WIRE SADDLE

SB4F-4

MATERIAL: NYLON 66(UL)
 FLAME CLASS: 94V-2
 COLOR: BLACK
 UNIT: mm

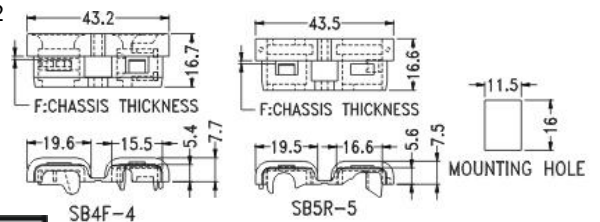

| PART NO | WILL FIT THESE CABLE | | CHASSIS THICKNESS | PACKAGE |
|---------|----------------------|-----------------|-------------------|---------|
| | UL/CSA DESCRIPTION | SIZE | | |
| SB4F-4 | SPT-1, SPT-2 | 3X5.6, 3.71X7.6 | 0.8~1.2 | 250 |
| SB5R-5 | SVT3C#18 | 6.6~7.2 | 0.8~1.2 | |

WIRE SADDLE

SB4F-6

MATERIAL: NYLON 66(UL)
 FLAME CLASS: 94V-2
 COLOR: BLACK
 UNIT: mm

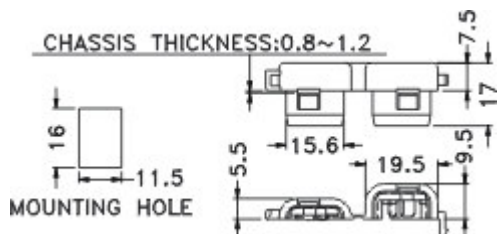

| PART NO | WILL FIT THESE CABLE | | PACKAGE |
|---------|----------------------|-----------------|---------|
| | UL/CSA DESCRIPTION | SIZE | |
| SB4F-6 | SPT-1, SPT-2 | 3X5.6, 3.71X7.6 | 200 |

WIRE IDENTIFICATION LABELS

LCB

MATERIAL: VINYL CHLORIDE
 IDENTICAL MARK: 0~9 A~Z
 UNIT: mm
 100PCS IN ONE SHEET OF 1 DIGIT

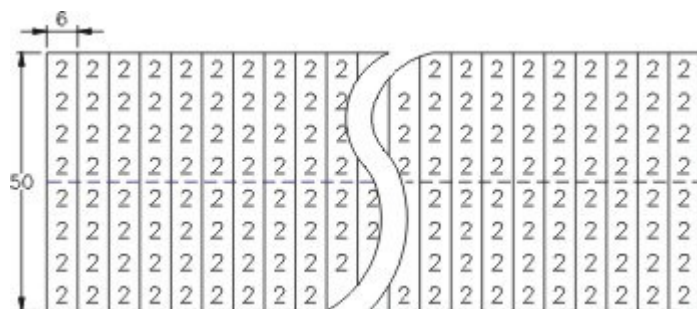
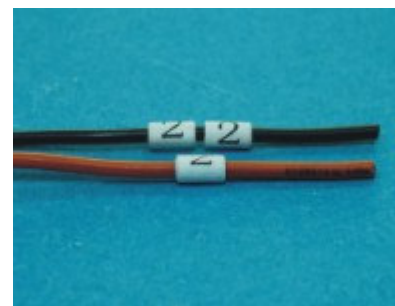

WIRE CLAMP

CLT-1

MATERIAL: ABS
 FLAME CLASS: 94V-HB/94V-2
 COLOR: GARY
 UNIT: mm

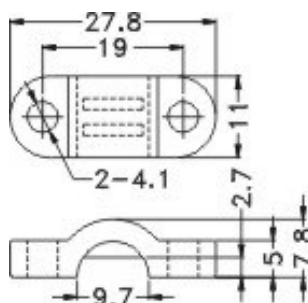

| PARTNO | PACKAGE |
|--------|---------|
| CLT-1 | 500 |

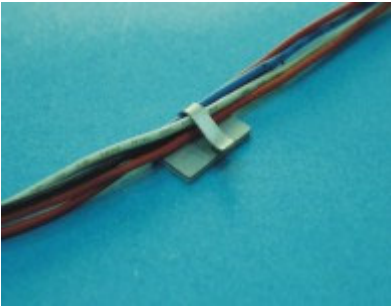

WIRE HOLDER METAL

WCM

MATERIAL:STEEL
UNIT:mm

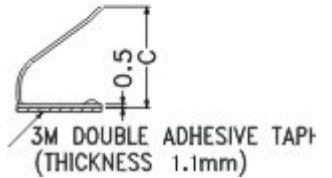
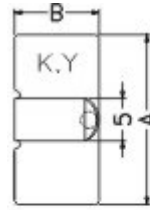

| PARTNO | A | B | C | PACKAGE |
|--------|------|------|------|---------|
| WCM-1 | 20.0 | 10.0 | 12.5 | 1000 |
| WCM-2 | 25.0 | 15.0 | 18.0 | 500 |



WIRE HOLDER

WCT

MATERIAL:NYLON 66 (UL)
FLAME CLASS:94V-2
COLOR:NATURAL
UNIT:mm

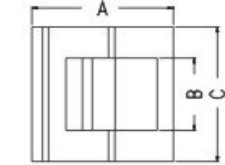

| PART NO. | A | B | C | D | E | F | G | PACKAGE |
|----------|------|------|------|-----|-----|------|-----|---------|
| WCT-4 | 15.9 | 9.7 | 15.9 | 8.0 | 4.0 | 1.5 | 5.7 | 500 |
| WCT-5 | 19.0 | 10.2 | 19.0 | 8.3 | 5.2 | 1.55 | 8.0 | |
| WCT-6 | 19.0 | 10.0 | 20.0 | 8.0 | 6.0 | 1.1 | 9.9 | |



WIRE HOLDER

WC-1

MATERIAL:NYLON 66 (UL)
FLAME CLASS:94V-2
COLOR:NATURAL
UNIT:mm

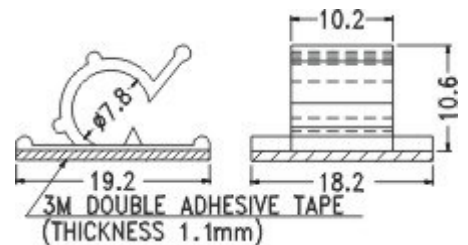

| PARTNO | PACKAGE |
|--------|---------|
| WC-1 | 500 |

METAL WIRE HOLDER

WL

MEATL MAT'L:STEEL
 PLACTIC MAT'L:SOFT PVC/PVC TUBE(UL/CSA)
 COLOR:BLACK
 UNIT:mm

| PARTNO | A | B | C | PACKAGE |
|---------|------|-----|------|---------|
| WL3-32T | 7.5 | 3.3 | 32.0 | 1000 |
| WL3-52T | 7.5 | 3.3 | 52.0 | |
| WL3-60T | 8.0 | 3.6 | 62.0 | |
| WL4-35T | 8.5 | 4.2 | 35.0 | |
| WL4-50T | 8.0 | 4.1 | 52.0 | |
| WL4-70T | 7.5 | 4.2 | 74.5 | |
| WL4-78T | 8.0 | 4.1 | 78.5 | 500 |
| WL5-70T | 8.4 | 5.1 | 60.8 | |
| WL6-78T | 10.0 | 6.0 | 78.0 | |

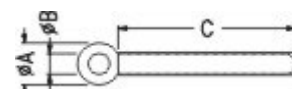
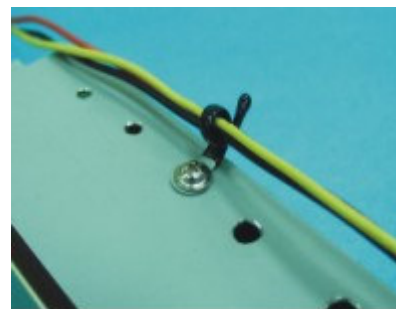

WIRE CLAMP

CLM-7.5

MATERIAL:NYLON 66(UL)
 FLAME CLASS:94V-2
 COLOR:NATURAL
 UNIT:mm

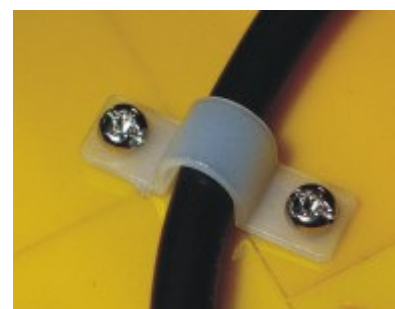
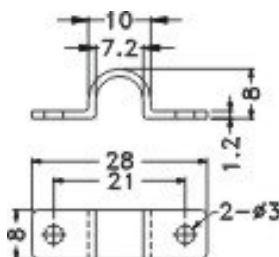

| PARTNO | PACKAGE |
|---------|---------|
| CLM-7.5 | 500 |

WIRE CLAMP

CLT-2

MATERIAL:ABS
 FLAME CLASS:94V-HB/94V-2
 COLOR:GARY
 UNIT:mm

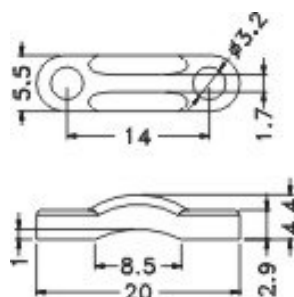

| PARTNO | PACKAGE |
|--------|---------|
| CLT-2 | 500 |



WIRE CLAMP WITH VIBRACLIP

CHO

MATERIAL: NYLON 66 (UL)
 FLAME CLASS: 94V-2
 COLOR: NATURAL
 UNIT: mm

| PART NO. | A | CLOSE | PACKAGE |
|----------|------|-------|---------|
| CHO-7.6 | 12.1 | 7.6 | 500 |
| CHO-10 | 15.0 | 10.0 | |
| CHO-12 | 20.0 | 12.0 | |

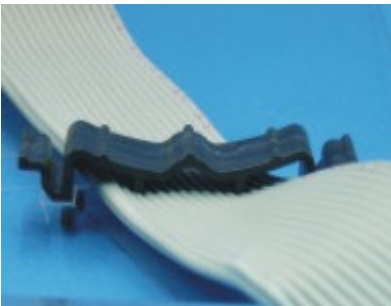
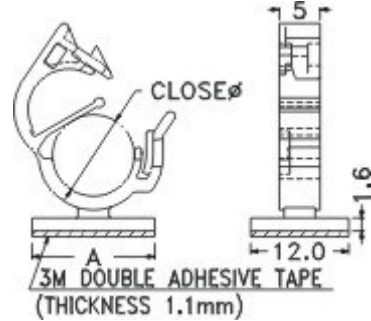

LOW COST CABLE CLAMP

CCMA-30

MATERIAL: NYLON 66 (UL)
 FLAME CLASS: 94V-2
 COLOR: NATURAL
 UNIT: mm

| PART NO. | A | PACKAGE |
|----------|------|---------|
| CCMA-30 | 30.0 | 1000 |

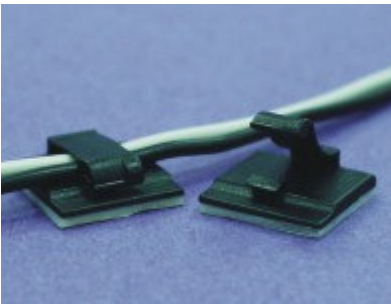
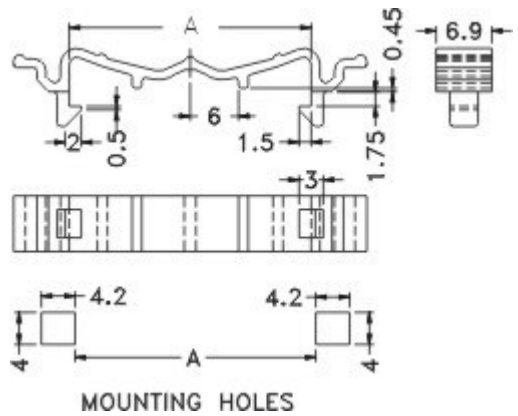

FLAT CABLE CLAMP

WDF-2

MATERIAL: NYLON 66 (UL)
 FLAME CLASS: 94V-2
 COLOR: BLACK
 UNIT: mm

| PARTNO | PACKAGE |
|--------|---------|
| WDF-2 | 1000 |

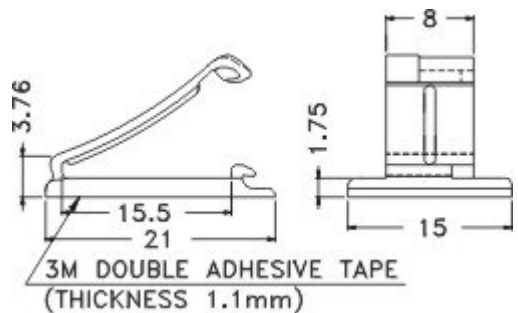

WIRE CLAMP

WDF-1

MATERIAL:NYLON 66 (UL)
 FLAME CLASS:94V-2
 COLOR:BLACK
 UNIT:mm

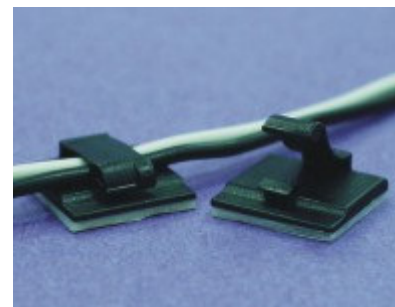

| PARTNO | PACKAGE |
|--------|---------|
| WDF-1 | 1000 |

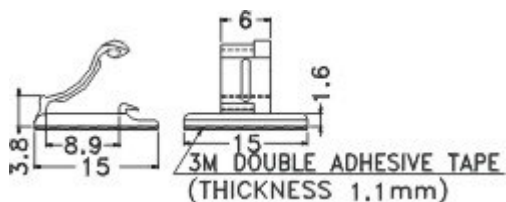

METAL WIRE HOLDER

WLD

METAL MATERIAL:STEEL
 METAL FINISH:TIN PLATED
 PLASTIC MAT'L:POLYOLFEIN(UL)CSA/PVC(UL)CSA
 COLOR:BLACK
 UNIT:mm

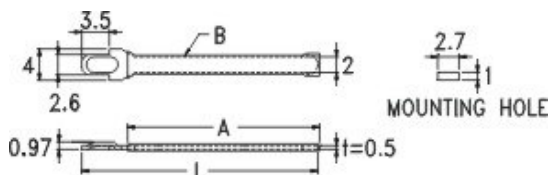
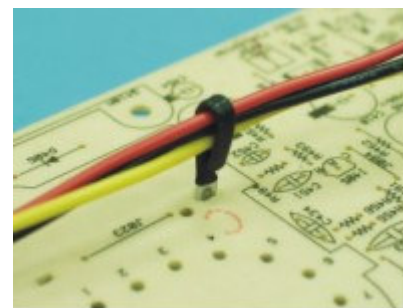

| PARTNO | L | A | B | PACKAGE |
|---------|------|------|--------------------|---------|
| WLD-30H | 30.0 | 24.0 | 1.5 HEAT SHRINKING | 1000 |
| WLD-50H | 50.0 | 47.0 | 1.5 HEAT SHRINKING | |
| WLD-30T | 30.0 | 22.0 | 1.93 PVC TUBE | |
| WLD-50T | 50.0 | 45.0 | 1.93 PVC TUBE | |

METAL WIRE HOLDER

WLC-1

METAL MAT'L:STEEL,PVC TUBE(UL/CSA)
 COLOR:BLACK
 UNIT:mm

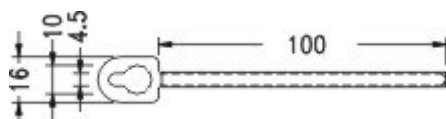
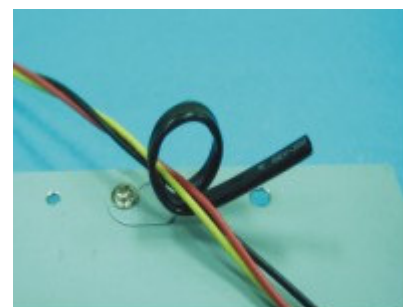

| PARTNO | PACKAGE |
|--------|---------|
| WLC-1 | 500 |

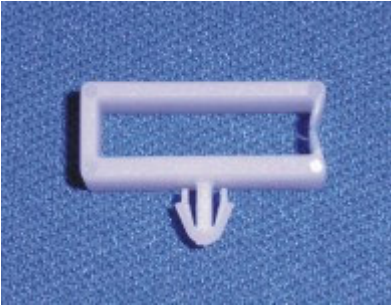

CABLE CLIP

MIS-5

MATERIAL: NYLON 66 (UL)
 FLAME CLASS: 94V-2
 COLOR: NATURAL
 UNIT: mm

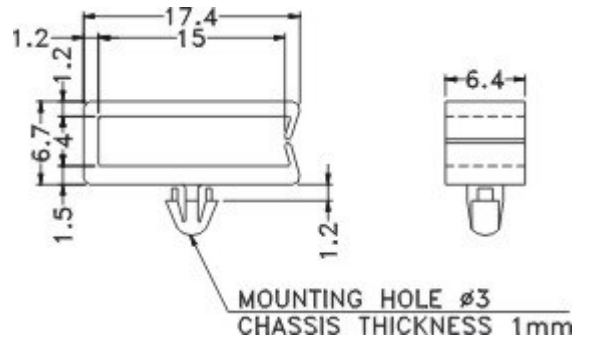

| PARTNO | PACKAGE |
|--------|---------|
| MIS-5 | 2000 |

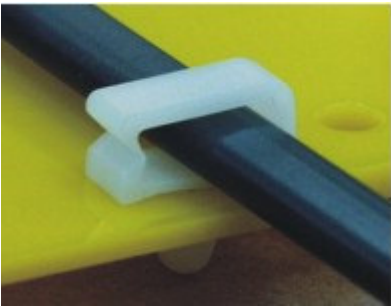

CABLE CLIP

MIS-3

MATERIAL: NYLON 66 (UL)
 FLAME CLASS: 94V-2
 COLOR: NATURAL
 UNIT: mm

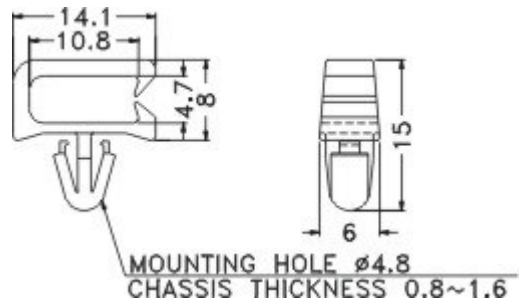

| PARTNO | PACKAGE |
|--------|---------|
| MIS-3 | 2000 |



CABLE CLIP

MIS-2

MATERIAL: NYLON 66 (UL)
 FLAME CLASS: 94V-2
 COLOR: NATURAL
 UNIT: mm

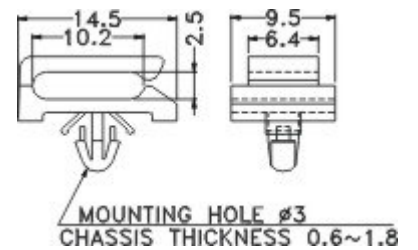

| PARTNO | PACKAGE |
|--------|---------|
| MIS-2 | 2000 |

CABLE CLIP

CHD-18

MATERIAL: NYLON 66 (UL)
 FLAME CLASS: 94V-2
 COLOR: NATURAL
 UNIT: mm

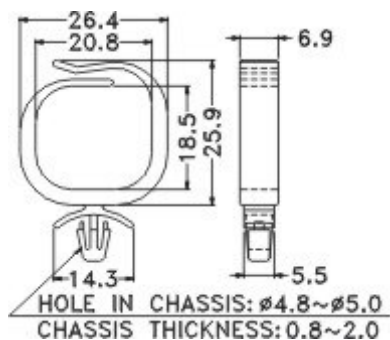

| PARTNO | PACKAGE |
|--------|---------|
| CHD-18 | 250 |

WIRE SADDLE

WCL-1

MATERIAL: NYLON 66 (UL)
 FLAME CLASS: 94V-2
 COLOR: NATURAL
 UNIT: mm

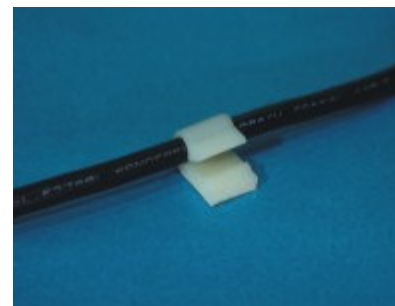
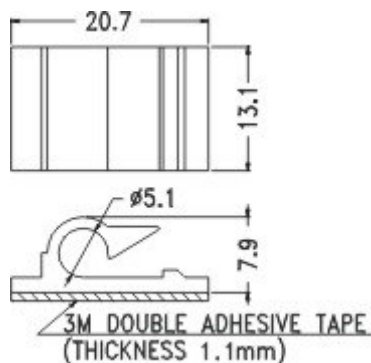

| PARTNO | PACKAGE |
|--------|---------|
| WCL-1 | 500 |

WIRE SADDLE

WC-4

MATERIAL: NYLON 66 (UL)
 FLAME CLASS: 94V-2
 COLOR: NATURAL
 UNIT: mm



| PARTNO | PACKAGE |
|--------|---------|
| WC-4 | 1000 |

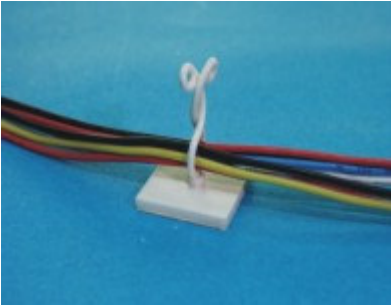

| PARTNO | PACKAGE |
|--------|---------|
| KLS-1 | 250 |

CABLE HOLDER TWISTER

KLS-1

MATERIAL: NYLON 66 (UL)
 FLAME CLASS: 94V-2
 COLOR: NATURAL/GRAY
 UNIT: mm

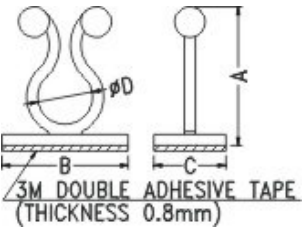
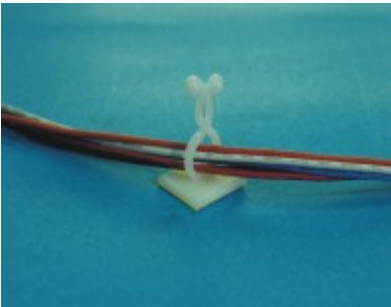
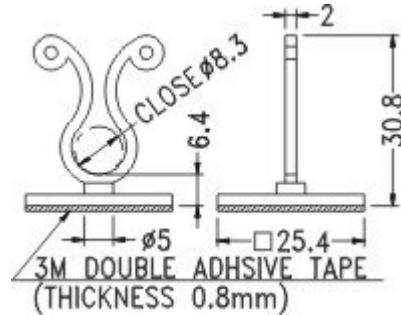

CABLE HOLDER TWISTER

KL

MATERIAL: NYLON 66 (UL)
 FLAME CLASS: 94V-2
 COLOR: NATURAL/GRAY
 UNIT: mm

| PART NO | A | B | C | D | CLOSE D | PACKAGE |
|---------|------|------|------|------|---------|---------|
| KL-1 | 32.3 | 20.0 | 20.0 | 15.0 | 13.8 | 250 |
| KL-2 | 26.1 | 20.0 | 14.0 | 9.2 | 8.5 | 500 |
| KL-2L | 28.0 | 25.0 | 13.0 | 9.4 | 8.2 | |
| KL-3 | 28.1 | 21.0 | 19.0 | 11.1 | 10.0 | |
| KL-5 | 55.8 | 38.0 | 20.0 | 36.0 | 34.0 | 100 |
| KL-6 | 27.6 | 10.0 | 19.8 | 6.6 | 5.8 | 100 |
| KL-7 | 21.9 | 20.0 | 13.0 | 8.5 | 7.2 | 500 |
| KL-16 | 37.1 | 25.0 | 13.0 | 18.0 | 17.0 | 250 |
| KL-19 | 39.2 | 25.0 | 13.0 | 21.0 | 20.0 | 250 |
| KL-22 | 41.3 | 28.0 | 15.0 | 24.0 | 23.0 | 250 |

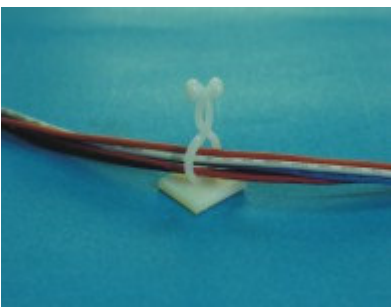

| PARTNO | PACKAGE |
|--------|---------|
| KL-14 | 500 |

CABLE HOLDER TWISTER

KL-14

MATERIAL: NYLON 66 (UL)
 FLAME CLASS: 94V-2
 COLOR: NATURAL/GRAY
 UNIT: mm

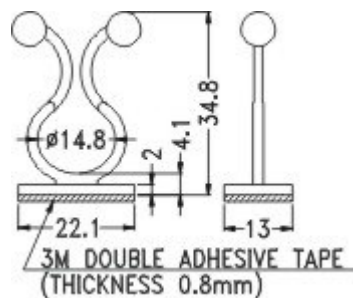

CABLE HOLDER TWISTER

KL-11

MATERIAL: NYLON 66 (UL)
 FLAME CLASS: 94V-2
 COLOR: NATURAL/GRAY
 UNIT: mm

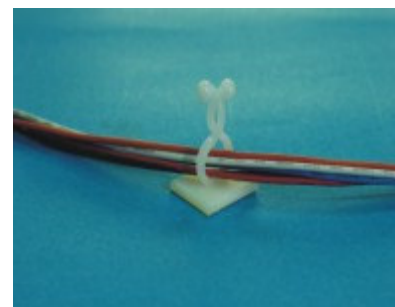
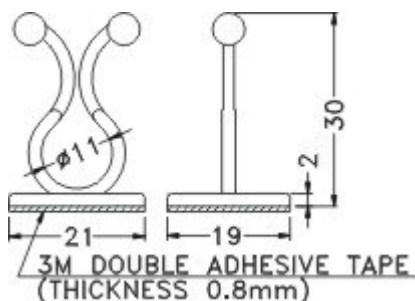

| PARTNO | PACKAGE |
|--------|---------|
| KL-11 | 500 |

CABLE HOLDER TWISTER

KLF-11

MATERIAL: NYLON 66 (UL)
 FLAME CLASS: 94V-2
 COLOR: NATURAL/GRAY
 UNIT: mm

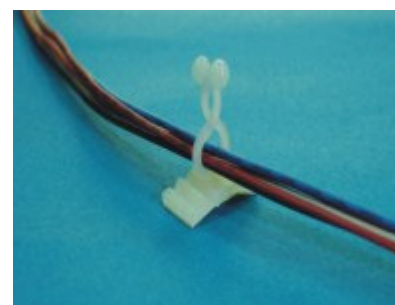
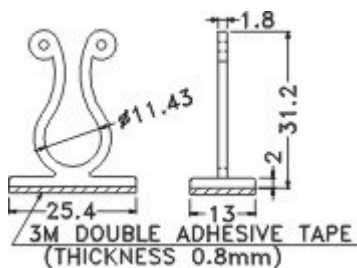

| PARTNO | PACKAGE |
|--------|---------|
| KLF-11 | 500 |

CABLE HOLDER TWISTER

KLB-1

MATERIAL: NYLON 66 (UL)
 FLAME CLASS: 94V-2
 COLOR: NATURAL/GRAY
 UNIT: mm

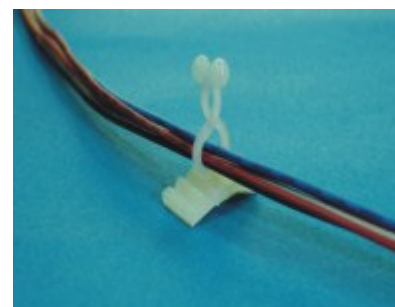
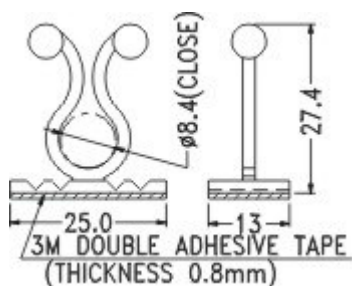

| PARTNO | PACKAGE |
|--------|---------|
| KLB-1 | 500 |



CABLE HOLDER TWISTER

THH-8

MATERIAL: NYLON 66 (UL)
 FLAME CLASS: 94V-2
 COLOR: NATURAL
 UNIT: mm

| PARTNO | PACKAGE |
|--------|---------|
| THH-8 | 500 |

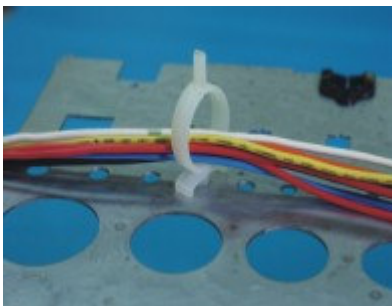
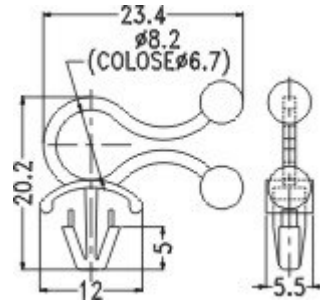

CABLE HOLDER TWISTER

SLC-17

MATERIAL: NYLON 66 (UL)
 FLAME CLASS: 94V-2
 COLOR: NATURAL
 UNIT: mm

| PARTNO | PACKAGE |
|--------|---------|
| SLC-17 | 500 |

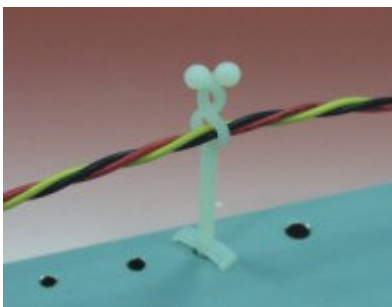
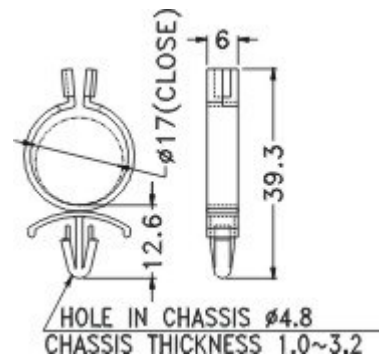

CABLE HOLDER TWISTER

THA

MATERIAL: NYLON 66 (UL)
 FLAME CLASS: 94V-2
 COLOR: NATURAL
 UNIT: mm

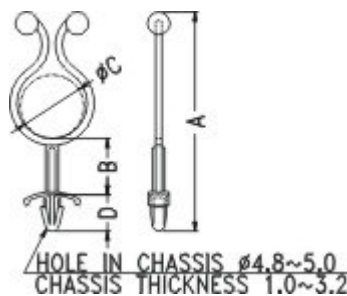

| PARTNO | A | B | C | D | CLOSE C | PACKAGE |
|--------|------|------|------|------|---------|---------|
| THA-1 | 33.8 | 3.1 | 7.1 | 10.6 | 6.1 | 1000 |
| THA-2 | 51.0 | 20.0 | 7.1 | 10.6 | 6.1 | 500 |
| THA-3 | 66.0 | 35.3 | 7.1 | 10.6 | 6.1 | |
| THA-4 | 39.6 | 2.8 | 10.8 | 10.6 | 9.8 | 1000 |
| THA-5 | 56.8 | 20.0 | 10.8 | 10.6 | 9.8 | 500 |
| THA-6 | 71.5 | 35.2 | 10.8 | 10.6 | 9.8 | |
| THA-7 | 42.0 | 3.0 | 15.0 | 10.6 | 13.8 | 1000 |
| THA-8 | 59.3 | 20.4 | 15.0 | 10.6 | 13.8 | |
| THA-9 | 74.7 | 35.8 | 15.0 | 10.6 | 13.8 | |
| THA-10 | 63.5 | 16.2 | 20.0 | 10.6 | 18.4 | |
| THA-11 | 56.8 | 3.0 | 24.3 | 9.8 | 22.3 | |
| THA-12 | 53.1 | 15.3 | 11.0 | 10.6 | 9.7 | 500 |
| THA-14 | 55.3 | 5.0 | 20.3 | 10.6 | 18.7 | |
| THA-15 | 43.8 | 10.5 | 8.0 | 10.6 | 6.8 | |
| THA-16 | 34.7 | 5.6 | 8.8 | 10.0 | 7.0 | |

CABLE HOLDER TWISTER

THC

MATERIAL: NYLON 66 (UL)
 FLAME CLASS: 94V-2
 COLOR: NATURAL
 UNIT: mm

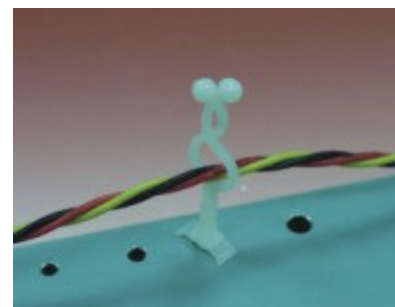
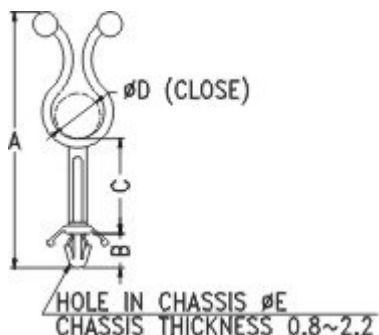

| PART NO | A | B | C | D | E | CLOSE | PACKAGE |
|---------|------|-----|------|------|-----|-------|---------|
| THC-1 | 56.5 | 7.5 | 21.0 | 11.8 | 4.8 | 10.4 | 500 |
| THC-2 | 59.8 | 7.5 | 34.0 | 5.6 | 4.8 | 5.0 | |
| THC-3 | 37.7 | 7.5 | 4.5 | 12.0 | 4.8 | 10.4 | 1000 |
| THC-1S | 26.7 | 5.5 | 3.0 | 8.8 | 4.0 | 7.2 | |
| THC-4 | 78.1 | 7.9 | 43.5 | 11.5 | 4.8 | 10.1 | 250 |

CABLE HOLDER TWISTER

WKL

MATERIAL: NYLON 66 (UL)
 FLAME CLASS: 94V-2
 COLOR: NATURAL
 UNIT: mm

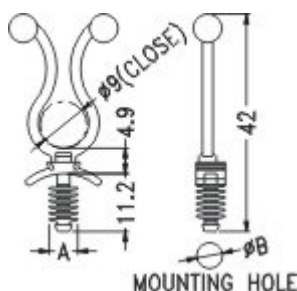

| PART NO | A | B | PACKAGE |
|---------|-----|-----|---------|
| WKL-10 | 5.5 | 5.0 | 500 |
| WKL-10A | 5.0 | 4.5 | |

WIRE CLAMP

OCC

MATERIAL: NYLON 66 (UL)
 FLAME CLASS: 94V-2
 COLOR: NATURAL
 UNIT: mm

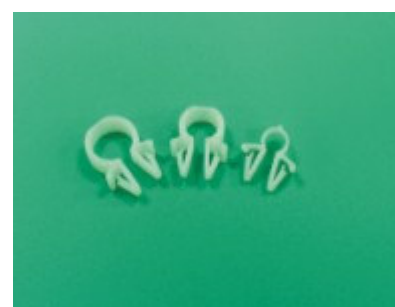
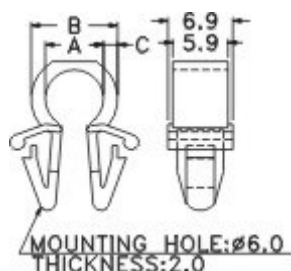

| PART NO | A | B | C | PACKAGE |
|---------|------|------|-----|---------|
| OCC-6 | 6.2 | 9.2 | 1.5 | 500 |
| OCC-8 | 8.2 | 11.2 | 1.5 | |
| OCC-10 | 10.2 | 13.2 | 1.5 | |



WIRE CLAMP

OCC-5

MATERIAL: NYLON 66 (UL)
 FLAME CLASS: 94V-2
 COLOR: NATURAL
 UNIT: mm

| PART NO | PACKAGE |
|---------|---------|
| OCC-5 | 1000 |

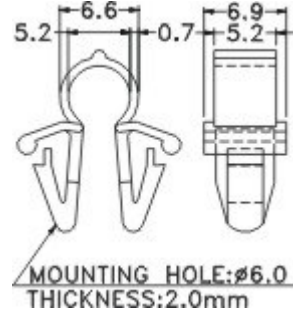

WIRE SADDLE

CHE-2

MATERIAL: NYLON 66 (UL)
 FLAME CLASS: 94V-2
 COLOR: NATURAL/BLACK
 UNIT: mm

| PART NO | PACKAGE |
|---------|---------|
| CHE-2 | 100 |

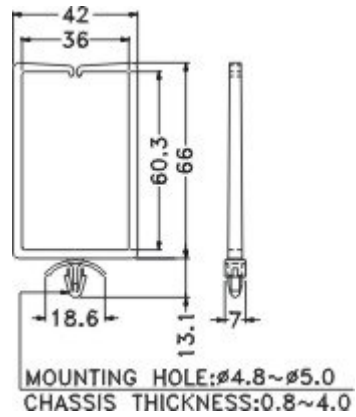

WIRE SADDLE

CHE-1

MATERIAL: NYLON 66 (UL)
 FLAME CLASS: 94V-2
 COLOR: NATURAL
 UNIT: mm

| PART NO | PACKAGE |
|---------|---------|
| CHE-1 | 500 |

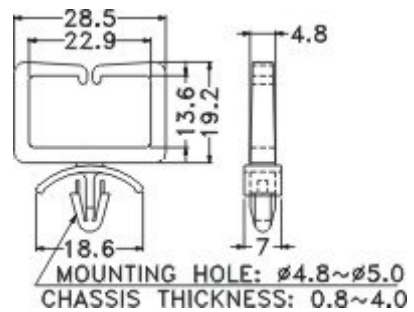

WIRE SADDLE

CHR-11

MATERIAL: NYLON 66 (UL)
 FLAME CLASS: 94V-2
 COLOR: NATURAL/BLACK
 UNIT: mm

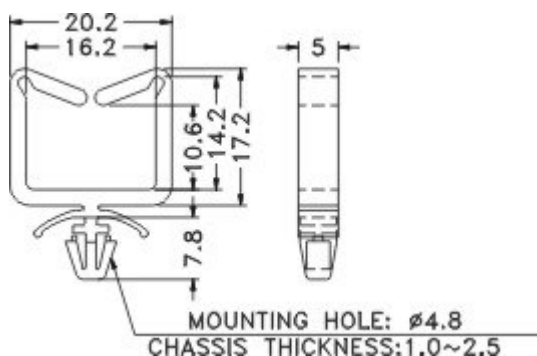

| PART NO | PACKAGE |
|---------|---------|
| CHR-11 | 100 |

WIRE SADDLE

CHP

MATERIAL: NYLON 66 (UL)
 FLAME CLASS: 94V-2
 COLOR: NATURAL
 UNIT: mm

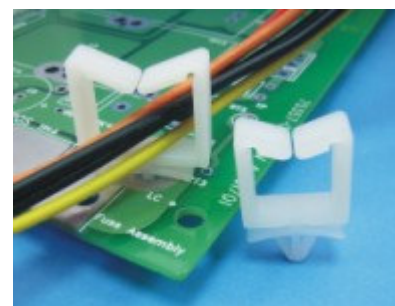
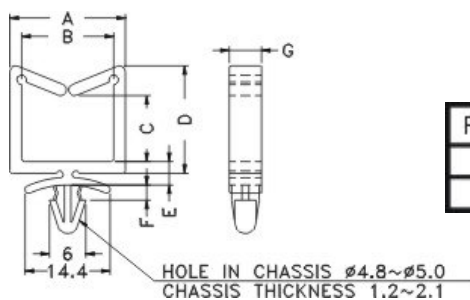

| PART NO. | A | B | C | D | E | F | G | PACKAGE |
|----------|------|------|------|------|-----|-----|-----|---------|
| CHP-1 | 19.7 | 15.7 | 11.3 | 18.2 | 4.1 | 2.3 | 5.5 | 500 |
| CHP-2 | 15.0 | 11.0 | 10.9 | 17.0 | 3.9 | | 5.4 | |

TUBE CLAMP

SMAP-11

MATERIAL: P.O.M (UL)
 FLAME CLASS: 94HB
 COLOR: NATURAL
 UNIT: mm

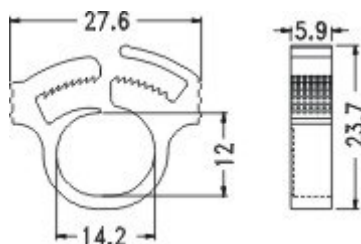

| PARTNO | PACKAGE |
|---------|---------|
| SMAP-11 | 250 |

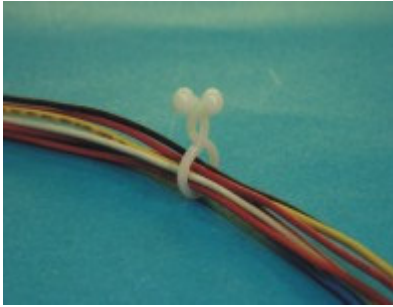

TWISTER

TL

MATERIAL: NYLON 66 (UL)
 FLAME CLASS: 94V-2
 COLOR: NATURAL
 UNIT: mm

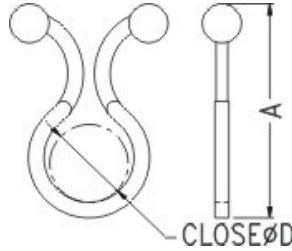

| PART NO | A | D | CLOSE D | PACKAGE |
|---------|------|------|---------|---------|
| TL-1 | 17.8 | 5.1 | 4.0 | 1000 |
| TL-2 | 23.8 | 8.3 | 7.3 | |
| TL-3A | 28.0 | 11.5 | 10.0 | |
| TL-4 | 30.4 | 15.4 | 13.8 | |
| TL-5 | 35.0 | 18.8 | 17.2 | |
| TL-6 | 41.4 | 25.8 | 24.2 | 500 |
| TL-7 | 42.0 | 22.0 | 19.5 | |
| ★ TL-8 | 16.5 | 5.6 | 5.0 | |
| ★ TL-13 | 32.5 | 13.2 | 11.5 | |
| ★ TL-28 | 55.5 | 29.0 | 26.8 | |

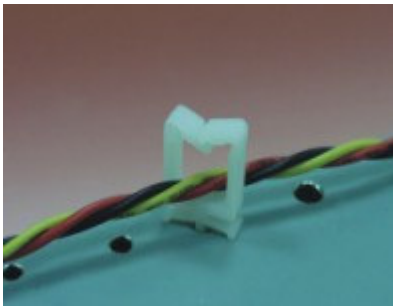

WIRE SADDLE

CH

MATERIAL: NYLON 66 (UL)
 FLAME CLASS: 94V-2
 COLOR: NATURAL
 UNIT: mm

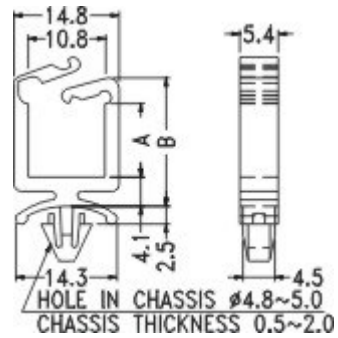

| PART NO. | A | B | PACKAGE |
|----------|------|------|---------|
| CH-10 | 10.3 | 18.0 | 500 |
| CH-19 | 19.6 | 27.2 | |



WIRE CLAMP

FWU

MATERIAL: NYLON 66 (UL)
 FLAME CLASS: 94V-2
 COLOR: NATURAL
 UNIT: mm

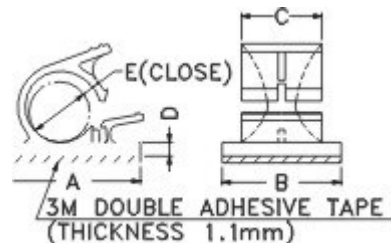

| PART NO. | A | B | C | D | E | PACKAGE |
|----------|------|------|------|-----|------|---------|
| FWU-1 | 13.0 | 10.0 | 6.8 | 2.0 | 4.0 | 1000 |
| FWU-2 | 15.0 | 13.0 | 9.0 | 2.0 | 6.0 | |
| FWU-3 | 21.6 | 19.0 | 12.8 | 2.2 | 9.0 | 500 |
| FWU-4 | 25.0 | 20.0 | 13.2 | 2.2 | 11.0 | 250 |
| FWU-5 | 32.0 | 25.4 | 16.0 | 2.1 | 13.4 | |
| FWU-6 | 35.8 | 24.8 | 16.8 | 2.7 | 18.0 | |

WIRE CLAMP

FWS

MATERIAL: NYLON 66 (UL)
 FLAME CLASS: 94V-2
 COLOR: NATURAL
 UNIT: mm

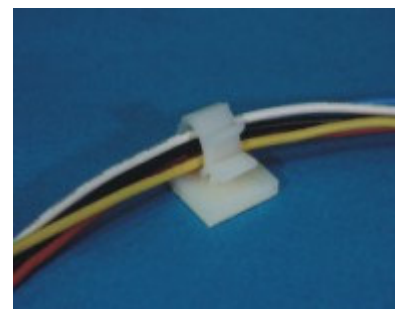
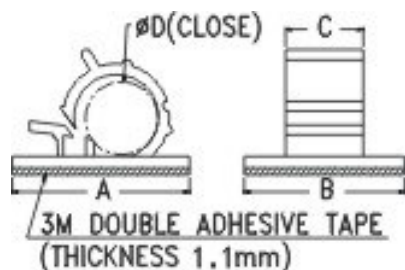

| PARTNO | A | B | C | D | PACKAGE |
|--------|------|------|------|------|---------|
| FWS-1 | 21.0 | 19.0 | 9.2 | 8.2 | 500 |
| FWS-2 | 25.0 | 20.0 | 12.0 | 9.0 | 250 |
| FWS-3 | 25.0 | 19.7 | 12.1 | 10.6 | |
| FWS-4 | 29.0 | 20.0 | 14.0 | 12.6 | |

DOUBLE TWISTER

2L-8

MATERIAL: NYLON 66 (UL)
 FLAME CLASS: 94V-2
 COLOR: NATURAL
 UNIT: mm

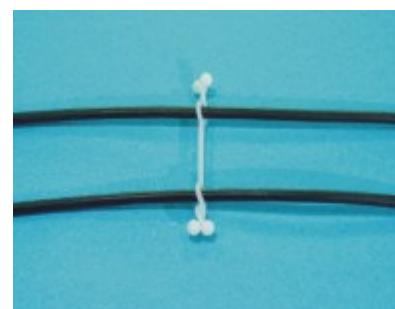
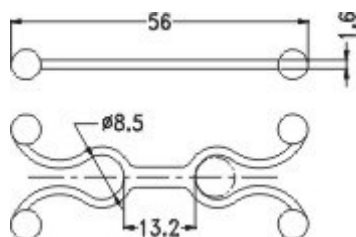

| PARTNO | PACKAGE |
|--------|---------|
| 2L-8 | 500 |

DOUBLE TWISTER

2L-7

MATERIAL: NYLON 66 (UL)
 FLAME CLASS: 94V-2
 COLOR: NATURAL
 UNIT: mm

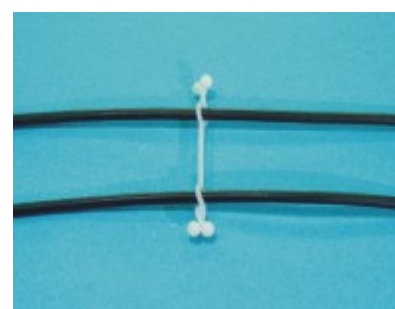
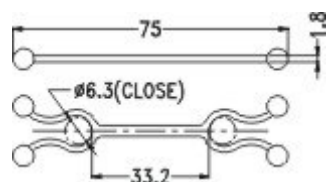

| PARTNO | PACKAGE |
|--------|---------|
| 2L-7 | 500 |



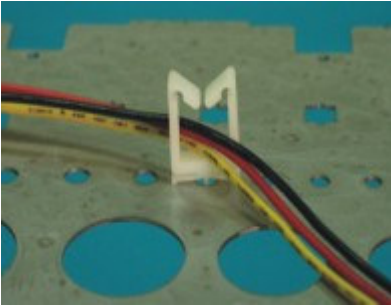

WIRE SADDLE

CHA

MATERIAL: NYLON 66 (UL)
 FLAME CLASS: 94V-2
 COLOR: NATURAL
 UNIT: mm

| PARTNO | A | B | PACKAGE |
|--------|------|------|---------|
| CHA-1 | 12.0 | 5.0 | 1000 |
| CHA-2 | 17.0 | 10.0 | 500 |
| CHA-3 | 26.0 | 19.0 | |
| CHA-4 | 34.0 | 27.0 | |

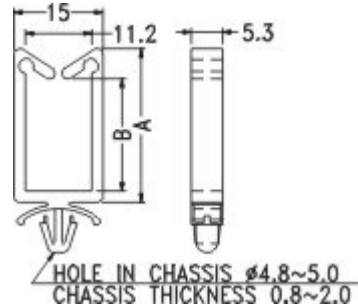

WIRE SADDLE

MWSL-6

MATERIAL: NYLON 66 (UL)
 FLAME CLASS: 94V-2
 COLOR: NATURAL
 UNIT: mm

| PARTNO | PACKAGE |
|--------|---------|
| MWSL-6 | 1000 |

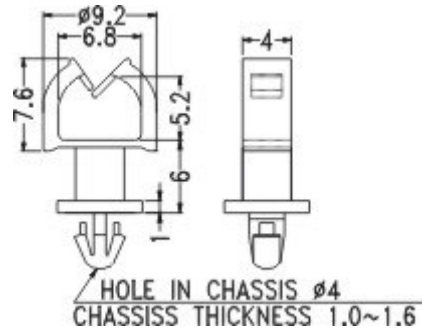

WIRE SADDLE

MWC-6

MATERIAL: NYLON 66 (UL)
 FLAME CLASS: 94V-2
 COLOR: NATURAL
 UNIT: mm

| PARTNO | PACKAGE |
|--------|---------|
| MWC-6 | 2000 |

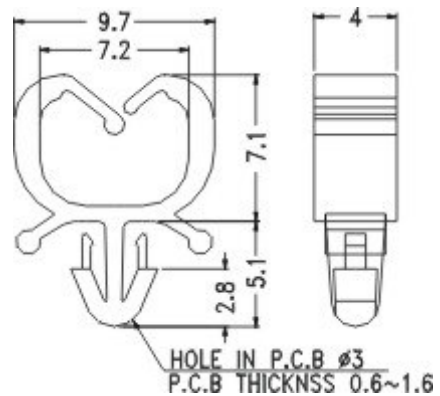

WIRE SADDLE

MWC-10

MATERIAL:NYLON 66 (UL)
 FLAME CLASS:94V-2
 COLOR:NATURAL
 UNIT:mm

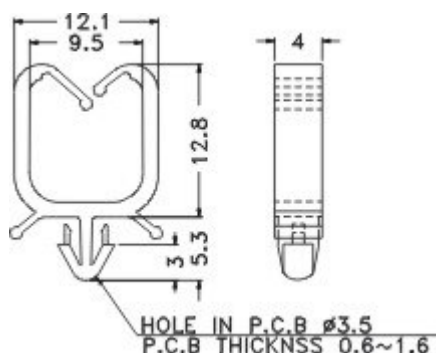

| PARTNO | PACKAGE |
|--------|---------|
| MWC-10 | 2000 |

WIRE SADDLE

MWS-17

MATERIAL:NYLON 66 (UL)
 FLAME CLASS:94V-2
 COLOR:NATURAL
 UNIT:mm

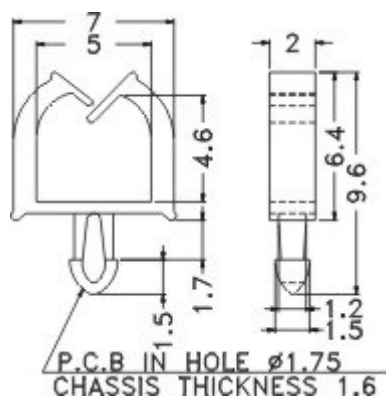

| PARTNO | PACKAGE |
|--------|---------|
| MWS-17 | 2000 |

WIRE SADDLE

MWS-16

MATERIAL:NYLON 66 (UL)
 FLAME CLASS:94V-2
 COLOR:NATURAL
 UNIT:mm

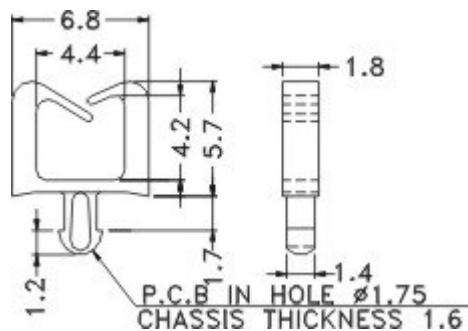

| PARTNO | PACKAGE |
|--------|---------|
| MWS-16 | 2000 |



WIRE SADDLE

MWS-8

MATERIAL: NYLON 66 (UL)
 FLAME CLASS: 94V-2
 COLOR: NATURAL
 UNIT: mm

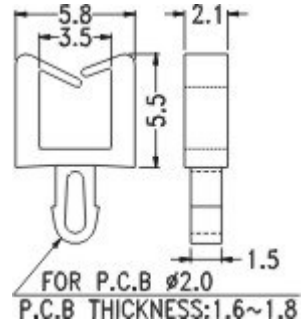

| PARTNO | PACKAGE |
|--------|---------|
| MWS-8 | 2000 |

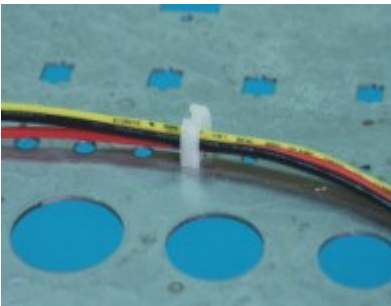

WIRE SADDLE

MWS

MATERIAL: NYLON 66 (UL)
 FLAME CLASS: 94V-2
 COLOR: NATURAL
 UNIT: mm

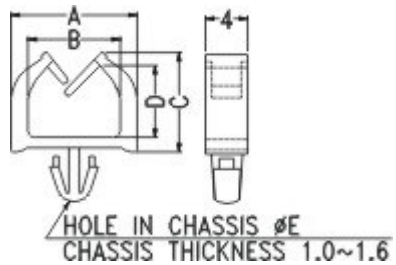

| PARTNO | A | B | C | D | E | PACKAGE |
|--------|------|-----|------|-----|-----|---------|
| MWS-6 | 12.0 | 8.8 | 11.5 | 8.5 | 3.5 | 1000 |
| MWS-7 | 9.2 | 6.8 | 7.6 | 5.0 | 3.0 | 2000 |

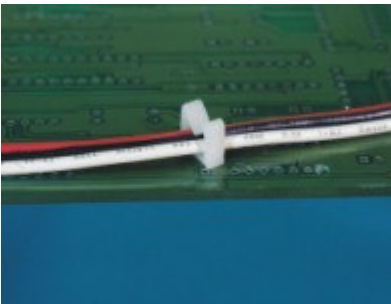

WIRE SADDLE

MWS-1

MATERIAL: NYLON 66 (UL)
 FLAME CLASS: 94V-2
 COLOR: NATURAL
 UNIT: mm

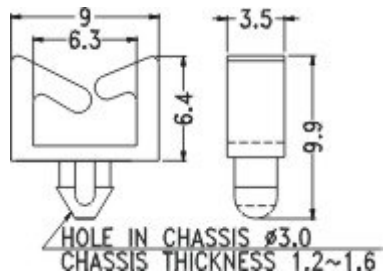

| PARTNO | PACKAGE |
|--------|---------|
| MWS-1 | 1000 |

WIRE SADDLE

CH-1

MATERIAL: NYLON 66 (UL)
 FLAME CLASS: 94V-2
 COLOR: NATURAL
 UNIT: mm

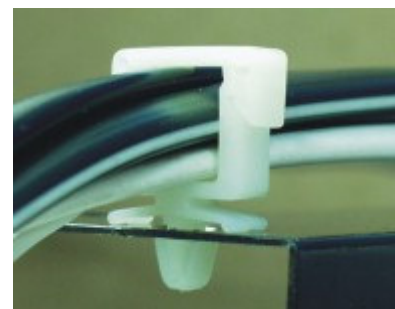
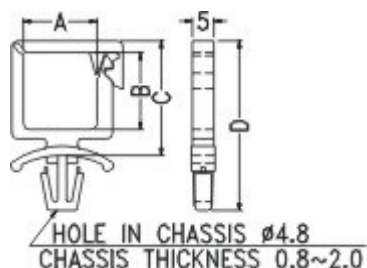

| PARTNO | A | B | C | D | PACKAGE |
|--------|------|------|------|------|---------|
| CH-1 | 11.0 | 11.2 | 16.6 | 24.0 | 500 |

WIRE SADDLE

MWS-4

MATERIAL: NYLON 66 (UL)
 FLAME CLASS: 94V-2
 COLOR: NATURAL
 UNIT: mm

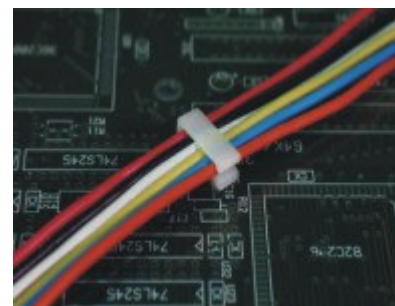
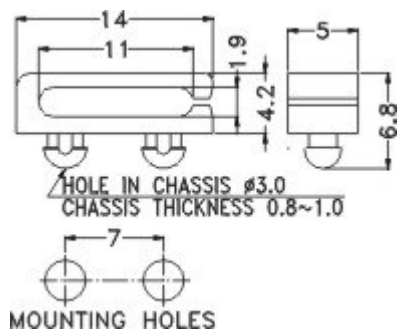

| PARTNO | PACKAGE |
|--------|---------|
| MWS-4 | 2000 |

OPEN-CLOSE WIRE CLAMP

FWT-25

MATERIAL: NYLON 66 (UL)
 FLAME CLASS: 94V-2
 COLOR: NATURAL
 UNIT: mm

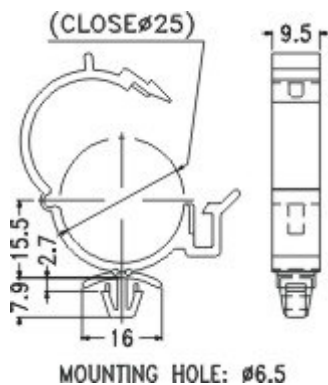

| PARTNO | PACKAGE |
|--------|---------|
| FWT-25 | 1000 |

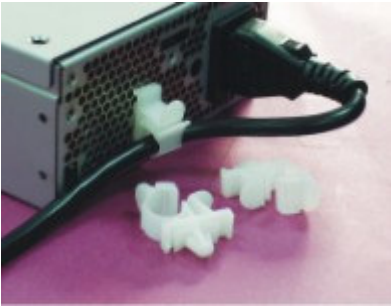

| PARTNO | PACKAGE |
|--------|---------|
| AWK-10 | 2000 |

OPEN-CLOSE WIRE CLAMP

AWK-10

MATERIAL: NYLON 66 (UL)
 FLAME CLASS: 94V-2
 COLOR: NATURAL
 UNIT: mm

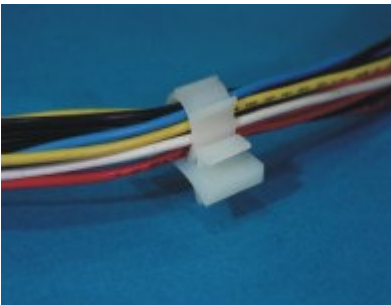
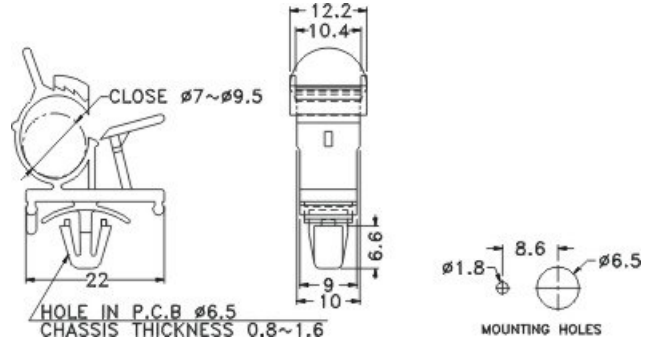

| PARTNO | PACKAGE |
|--------|---------|
| WL-1 | 500 |

OPEN-CLOSE WIRE CLAMP

WL-1

MATERIAL: NYLON 66 (UL)
 FLAME CLASS: 94V-2
 COLOR: NATURAL
 UNIT: mm

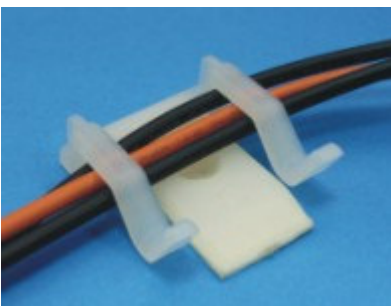
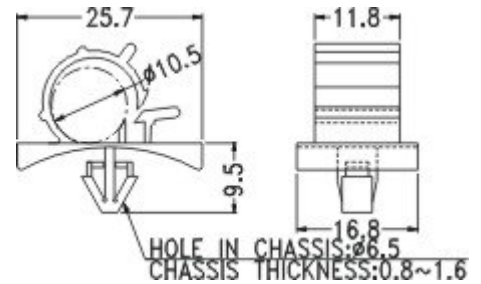

| PARTNO | PACKAGE |
|--------|---------|
| FCP-25 | 500 |

WIRE CLAMP

FCP-25

MATERIAL: NYLON 66 (UL)
 FLAME CLASS: 94V-2
 COLOR: NATURAL
 UNIT: mm

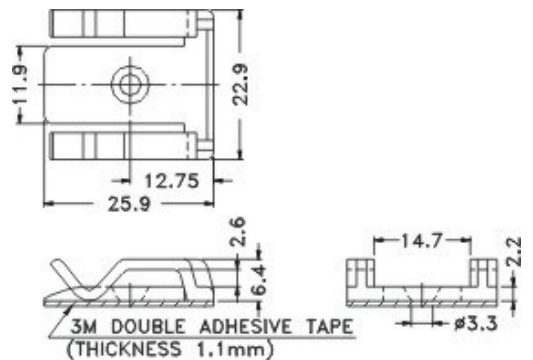

WIRE CLIP

FCP-22

MATERIAL: NYLON 66 (UL)
 FLAME CLASS: 94V-2
 COLOR: NATURAL
 UNIT: mm

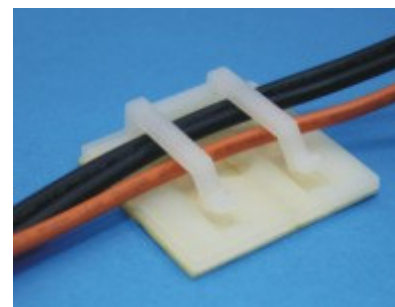

| PARTNO | PACKAGE |
|--------|---------|
| FCP-22 | 500 |

WIRE CLIP

WCS-3

MATERIAL: NYLON 66 (UL)
 FLAME CLASS: 94V-2
 COLOR: NATURAL
 UNIT: mm

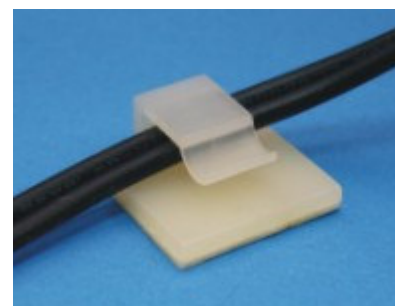
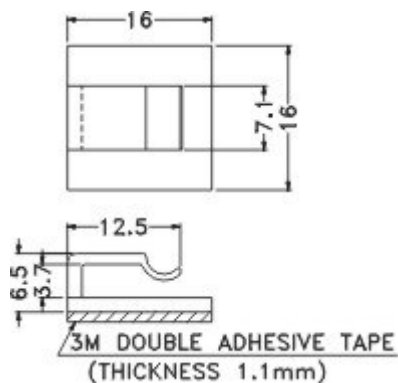

| PARTNO | PACKAGE |
|--------|---------|
| WCS-3 | 500 |

WIRE CLIP

WCS-2

MATERIAL: NYLON 66 (UL)
 FLAME CLASS: 94V-2
 COLOR: NATURA/BLACK
 UNIT: mm

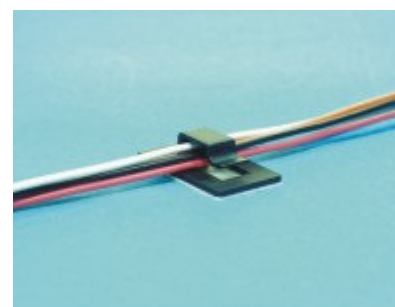
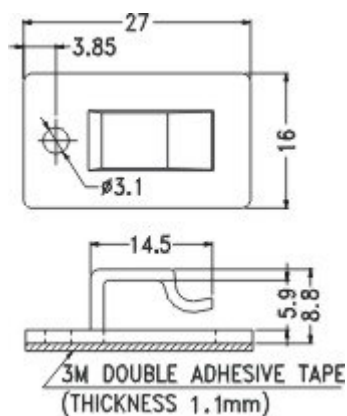

| PARTNO | PACKAGE |
|--------|---------|
| WCS-2 | 500 |

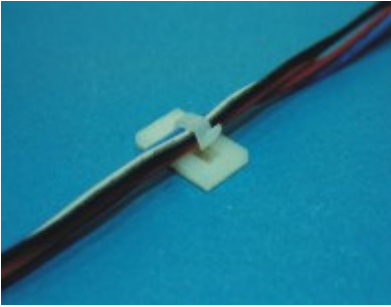

WIRE CLIP

WCS-1

MATERIAL: NYLON 66 (UL)
 FLAME CLASS: 94V-2
 COLOR: NATURAL/BLACK
 UNIT: mm



| PARTNO | PACKAGE |
|--------|---------|
| WCS-1 | 500 |



WIRE SADDLE

WLL-3

MATERIAL: NYLON 66 (UL)
 FLAME CLASS: 94V-2
 COLOR: NATURAL
 UNIT: mm

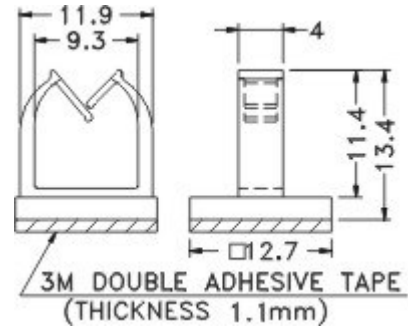

| PARTNO | PACKAGE |
|--------|---------|
| WLL-3 | 1000 |



WIRE SADDLE

WCC-3

MATERIAL: NYLON 66 (UL)
 FLAME CLASS: 94V-2
 COLOR: NATURAL
 UNIT: mm

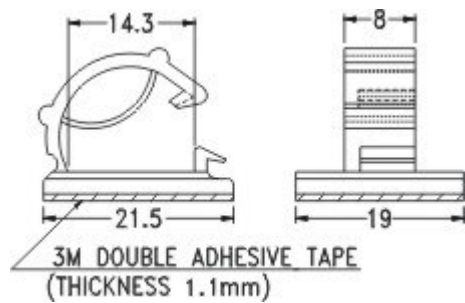

| PARTNO | PACKAGE |
|--------|---------|
| WCC-3 | 500 |

WIRE CLAMP

WCC

MATERIAL: NYLON 66 (UL)
 FLAME CLASS: 94V-2
 COLOR: NATURAL
 UNIT: mm

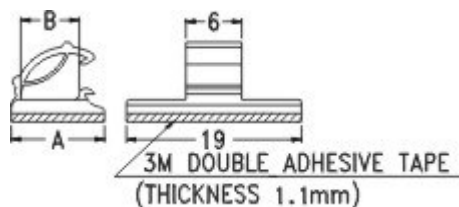

| PARTNO | A | B | PACKAGE |
|--------|------|------|---------|
| WCC-1 | 10.0 | 6.3 | 1000 |
| WCC-2 | 14.0 | 10.5 | 500 |

WIRE SADDLE

CHM-10

MATERIAL: NYLON 66 (UL)
 FLAME CLASS: 94V-2
 COLOR: NATURAL
 UNIT: mm

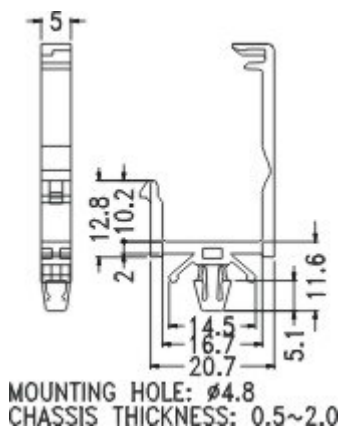

| PARTNO | PACKAGE |
|--------|---------|
| CHM-10 | 1000 |

WIRE SADDLE

CHL-3

MATERIAL: NYLON 66 (UL)
 FLAME CLASS: 94V-2
 COLOR: NATURAL
 UNIT: mm

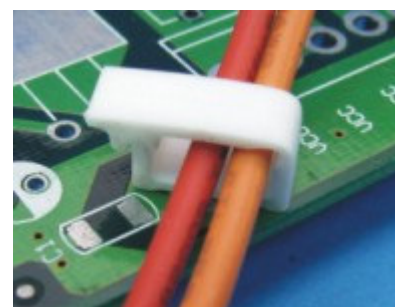
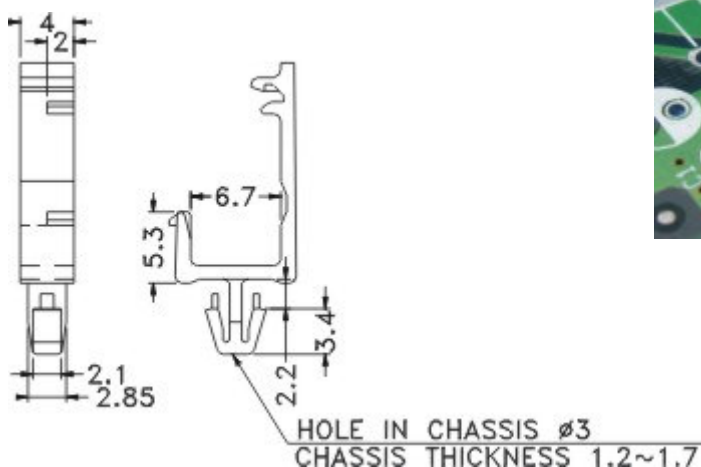

| PARTNO | PACKAGE |
|--------|---------|
| CHL-3 | 1000 |

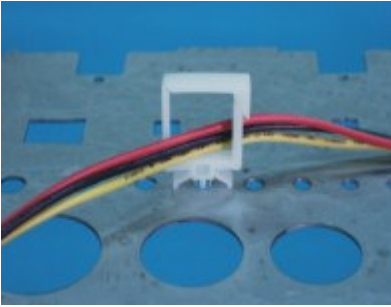

WIRE SADDLE

CHH

MATERIAL: NYLON 66 (UL)
 FLAME CLASS: 94V-2
 COLOR: NATURAL
 UNIT: mm

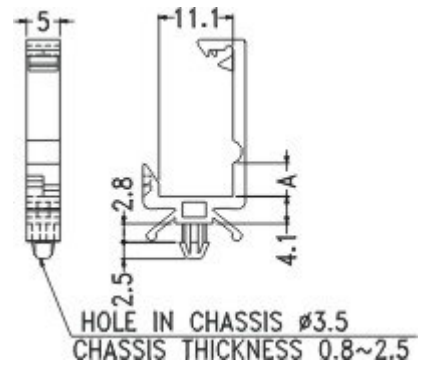

| PART NO. | A | PACKAGE |
|----------|------|---------|
| CHH-1 | 4.9 | 500 |
| CHH-2 | 10.1 | |

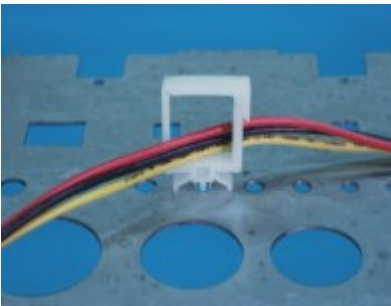

WIRE SADDLE

CHC

MATERIAL: NYLON 66 (UL)
 FLAME CLASS: 94V-2
 COLOR: NATURAL
 UNIT: mm

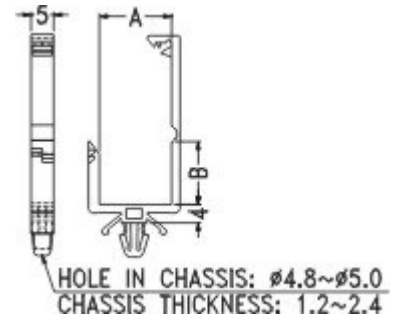

| PART NO | A | B | PACKAGE |
|---------|------|------|---------|
| CHC-1 | 16.0 | 14.0 | 500 |
| CHC-2 | 11.1 | 10.2 | |
| CHC-3 | 11.1 | 5.0 | |



WIRE SADDLE

CHJ-3

MATERIAL: NYLON 66 (UL)
 FLAME CLASS: 94V-2
 COLOR: NATURAL
 UNIT: mm

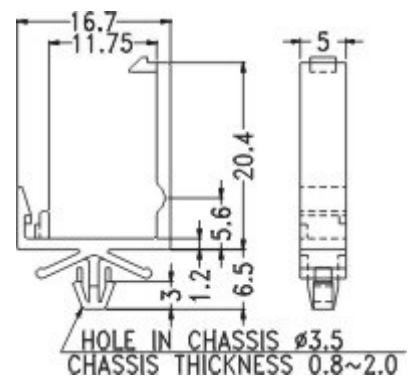

| PARTNO | PACKAGE |
|--------|---------|
| CHJ-3 | 1000 |

WIRE SADDLE

CHI-6

MATERIAL: NYLON 66 (UL)
 FLAME CLASS: 94V-2
 COLOR: NATURAL
 UNIT: mm

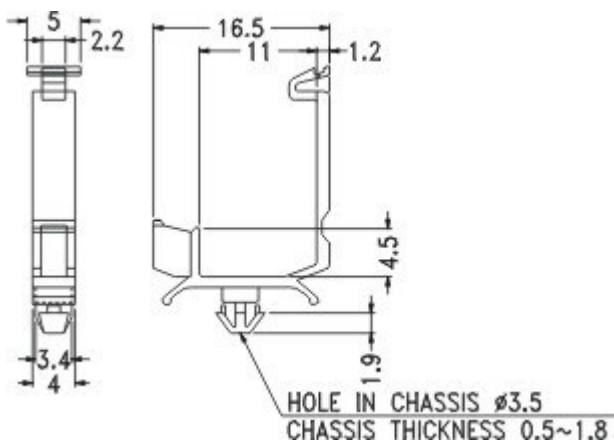

| PARTNO | PACKAGE |
|--------|---------|
| CHI-6 | 1000 |

WIRE SADDLE

CHI-3

MATERIAL: NYLON 66 (UL)
 FLAME CLASS: 94V-2
 COLOR: NATURAL
 UNIT: mm

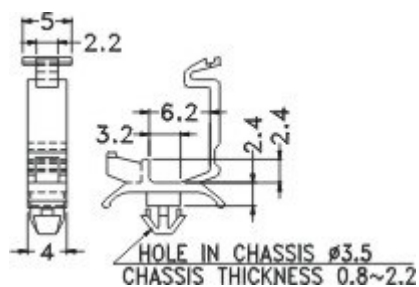

| PARTNO | PACKAGE |
|--------|---------|
| CHI-3 | 1000 |

WIRE SADDLE

CHK-12

MATERIAL: NYLON 66 (UL)
 FLAME CLASS: 94V-2
 COLOR: NATURAL
 UNIT: mm

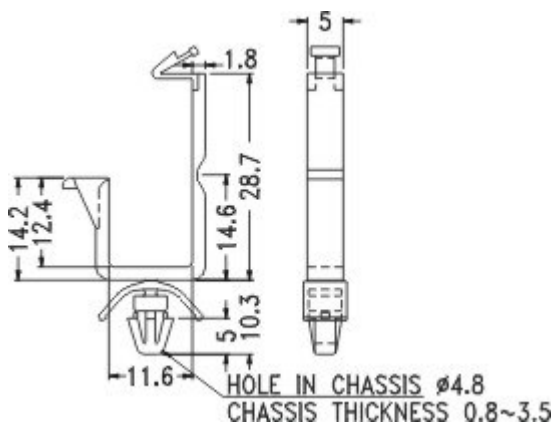

| PARTNO | PACKAGE |
|--------|---------|
| CHK-12 | 1000 |



WIRE SADDLE

CHK-6

MATERIAL: NYLON 66 (UL)
 FLAME CLASS: 94V-2
 COLOR: NATURAL
 UNIT: mm

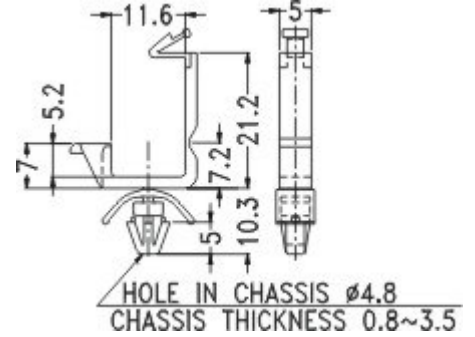

| PARTNO | PACKAGE |
|--------|---------|
| CHK-6 | 1000 |



WIRE SADDLE

CH-9

MATERIAL: NYLON 66 (UL)
 FLAME CLASS: 94V-2
 COLOR: NATURAL
 UNIT: mm

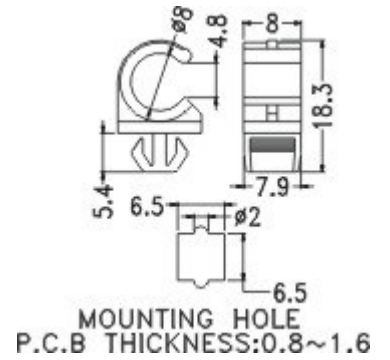

| PARTNO | PACKAGE |
|--------|---------|
| CH-9 | 1000 |

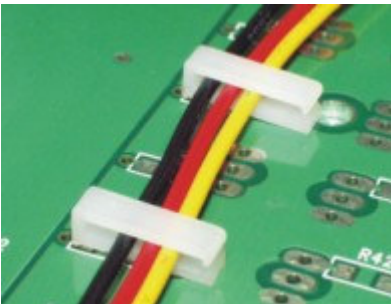

WIRE SADDLE

MIS-4

MATERIAL: NYLON 66 (UL)
 FLAME CLASS: 94V-2
 COLOR: NATURAL
 UNIT: mm

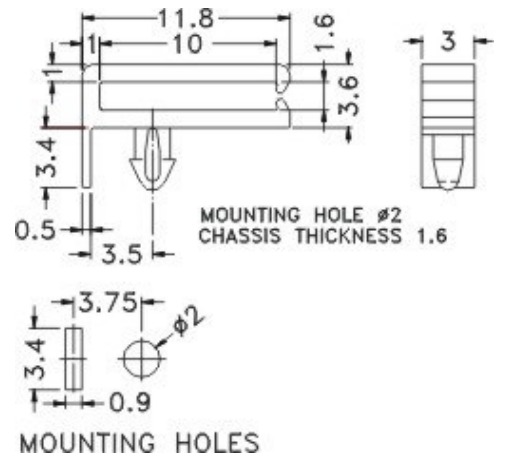

| PARTNO | PACKAGE |
|--------|---------|
| MIS-4 | 1000 |

WIRE SADDLE

WSS-2

MATERIAL: NYLON 66 (UL)
 FLAME CLASS: 94V-2
 COLOR: NATURAL
 UNIT: mm

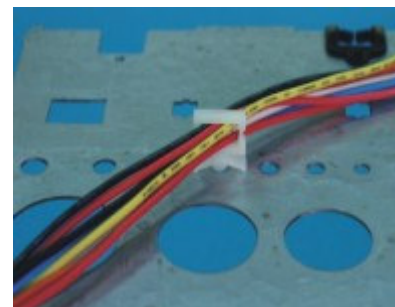
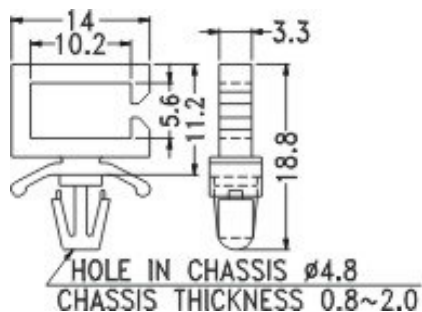

| PARTNO | PACKAGE |
|--------|---------|
| WSS-2 | 1000 |

WIRE SADDLE

WAS-1

MATERIAL: NYLON 66 (UL)
 FLAME CLASS: 94V-2
 COLOR: NATURAL
 UNIT: mm

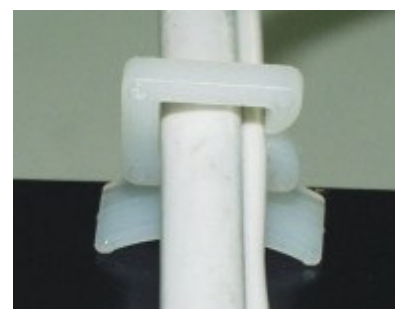
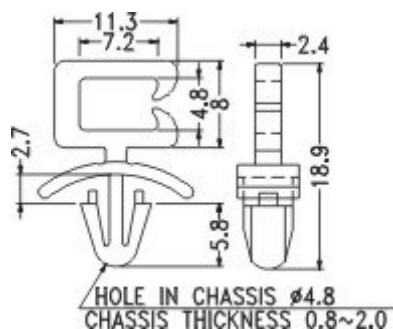

| PARTNO | PACKAGE |
|--------|---------|
| WAS-1 | 1000 |

WIRE SADDLE

MWS-9

MATERIAL: NYLON 66 (UL)
 FLAME CLASS: 94V-2
 COLOR: NATURAL
 UNIT: mm

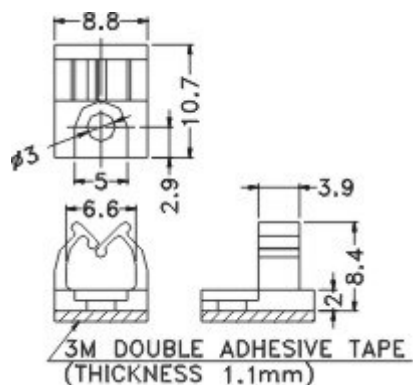

| PARTNO | PACKAGE |
|--------|---------|
| MWS-9 | 2000 |

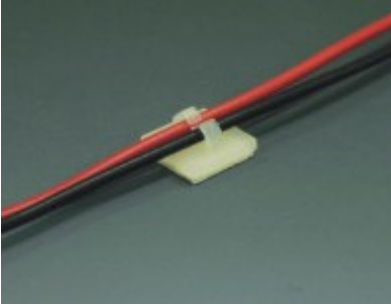

| PARTNO | PACKAGE |
|--------|---------|
| WLL-2 | 1000 |

WIRE SADDLE

WLL-2

MATERIAL: NYLON 66 (UL)
 FLAME CLASS: 94V-2
 COLOR: NATURAL
 UNIT: mm

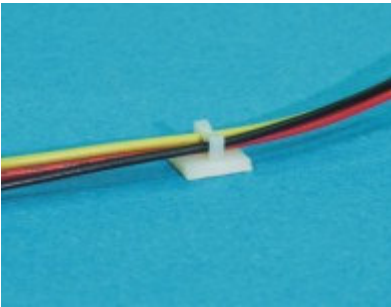
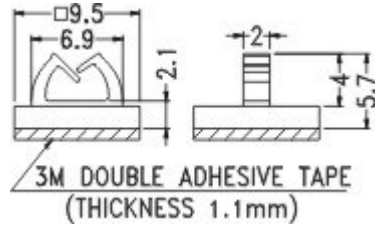

| PARTNO | PACKAGE |
|--------|---------|
| WLL-1 | 1000 |

WIRE SADDLE

WLL-1

MATERIAL: NYLON 66 (UL)
 FLAME CLASS: 94V-2
 COLOR: NATURAL
 UNIT: mm

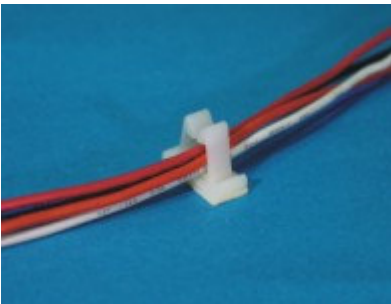
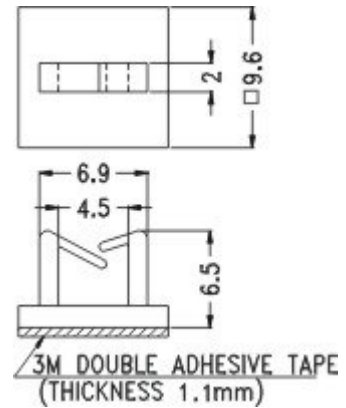

| PARTNO | PACKAGE |
|--------|---------|
| WT-2 | 1000 |

WIRE SADDLE

WT-2

MATERIAL: NYLON 66 (UL)
 FLAME CLASS: 94V-2
 COLOR: NATURAL
 UNIT: mm

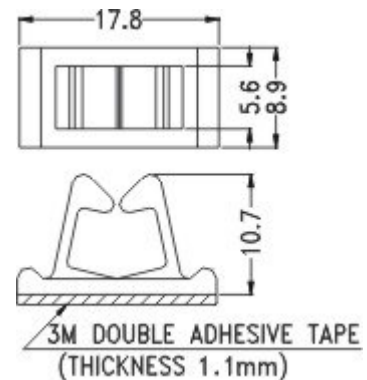

WIRE SADDLE

WT-1

MATERIAL: NYLON 66 (UL)
 FLAME CLASS: 94V-2
 COLOR: NATURAL
 UNIT: mm

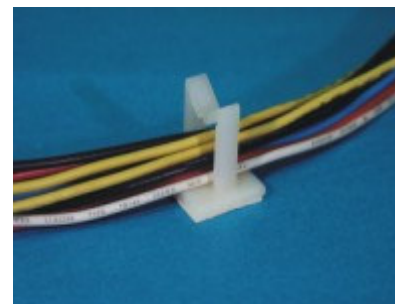
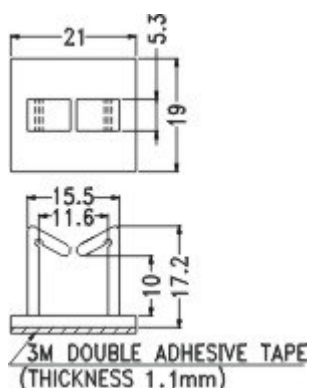

| PARTNO | PACKAGE |
|--------|---------|
| WT-1 | 500 |

WIRE SADDLE

WSK-1

MATERIAL: NYLON 66 (UL)
 FLAME CLASS: 94V-2
 COLOR: WHITE
 UNIT: mm

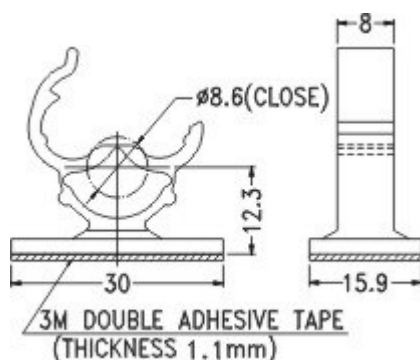

| PARTNO | PACKAGE |
|--------|---------|
| WSK-1 | 1000 |

WIRE SADDLE

MWS-2D

MATERIAL: NYLON 66 (UL)
 FLAME CLASS: 94V-2
 COLOR: BLACK/NATURAL
 UNIT: mm

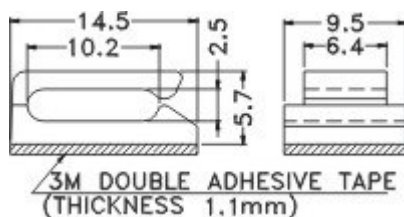

| PARTNO | PACKAGE |
|--------|---------|
| MWS-2D | 1000 |

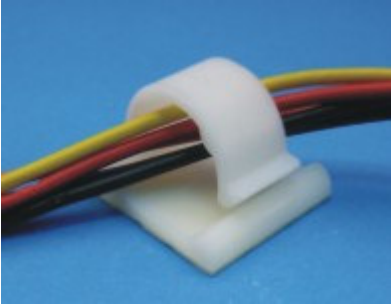

WIRE SADDLE

WCL-10

MATERIAL: NYLON 66 (UL)
 FLAME CLASS: 94V-2
 COLOR: NATURAL
 UNIT: mm

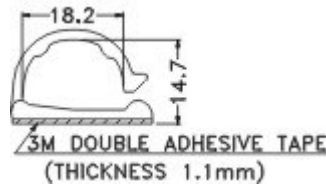
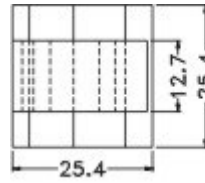

| PARTNO | PACKAGE |
|--------|---------|
| WCL-10 | 500 |

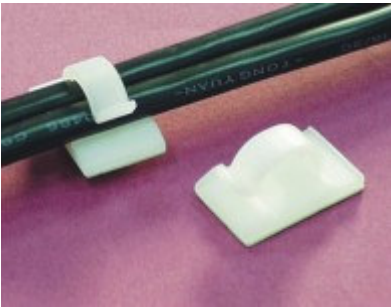

WIRE SADDLE

WCL

MATERIAL: NYLON 66 (UL)
 FLAME CLASS: 94V-2
 COLOR: NATURAL
 UNIT: mm

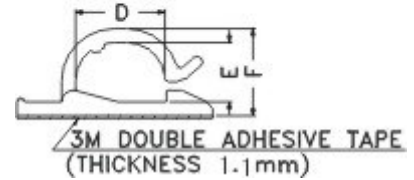
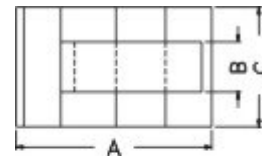

| PART NO. | A | B | C | D | E | F | PACKAGE |
|----------|------|------|------|------|-----|------|---------|
| WCL-8 | 25.4 | 6.5 | 15.5 | 11.6 | 7.8 | 11.3 | 500 |
| WCL-9 | 25.2 | 12.7 | 25.2 | | 7.6 | 11.0 | |

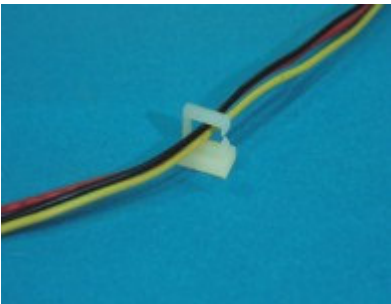

WIRE SADDLE

WSS-1

MATERIAL: NYLON 66 (UL)
 FLAME CLASS: 94V-2
 COLOR: NATURAL
 UNIT: mm

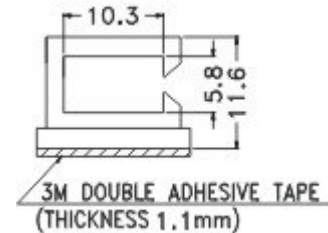
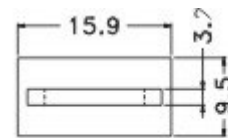

| PARTNO | PACKAGE |
|--------|---------|
| WSS-1 | 1000 |

WIRE SADDLE

WPEM

MATERIAL: NYLON 66 (UL)
 FLAME CLASS: 94V-2
 COLOR: NATURAL
 UNIT: mm

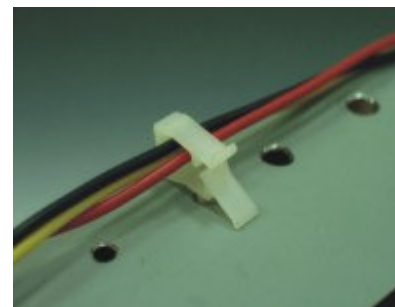
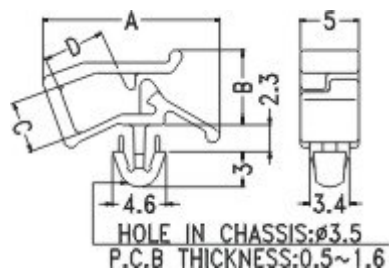

| PART NO. | A | B | C | D | PACKAGE |
|----------|------|-----|-----|-----|---------|
| WPEM-1 | 20.3 | 8.5 | 6.2 | 7.2 | 1000 |
| WPEM-1S | 15.2 | 6.4 | 4.3 | 5.3 | |

WIRE SADDLE

WPEG-1

MATERIAL: NYLON 66 (UL)
 FLAME CLASS: 94V-2
 COLOR: NATURAL/GRAY
 UNIT: mm

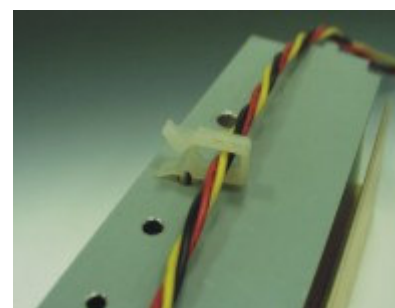
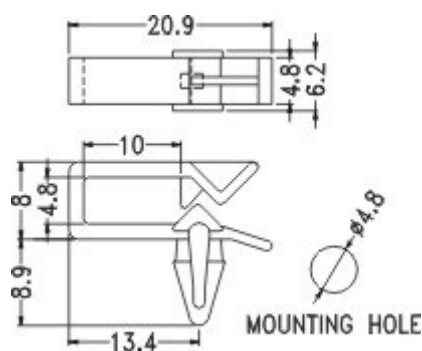

| PARTNO | PACKAGE |
|--------|---------|
| WPEG-1 | 1000 |

WIRE SADDLE

WTL

MATERIAL: NYLON 66 (UL)
 FLAME CLASS: 94V-2
 COLOR: NATURAL
 UNIT: mm

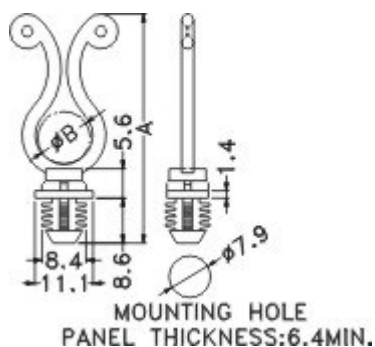

| PART NO | A | B | B(CLOSE) | PACKAGE |
|---------|------|------|----------|---------|
| WTL-11 | 43.7 | 11.0 | 10.0 | 500 |
| WTL-19 | 52.6 | 19.0 | 18.0 | |



WIRE SADDLE

THG-12

MATERIAL: NYLON 66 (UL)
 FLAME CLASS: 94V-2/94-0
 COLOR: NATURAL
 UNIT: mm

| PARTNO | PACKAGE |
|--------|---------|
| THG-12 | 500 |

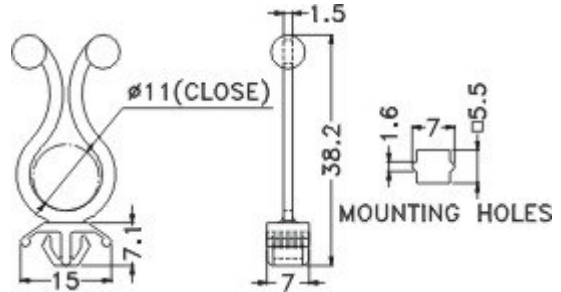

WIRE SADDLE

WCL-3

MATERIAL: NYLON 66 (UL)
 FLAME CLASS: 94V-2
 COLOR: NATURAL
 UNIT: mm

| PARTNO | PACKAGE |
|--------|---------|
| WCL-3 | 500 |

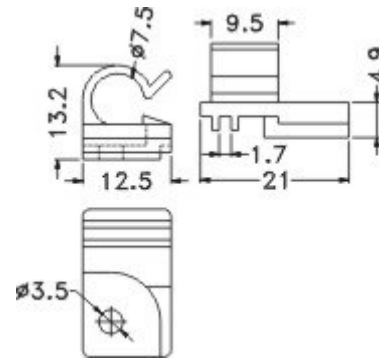

WIRE SADDLE

3WC-4

MATERIAL: NYLON 66 (UL)
 FLAME CLASS: 94V-2
 COLOR: BLACK
 UNIT: mm

| PARTNO | PACKAGE |
|--------|---------|
| 3WC-4 | 1000 |

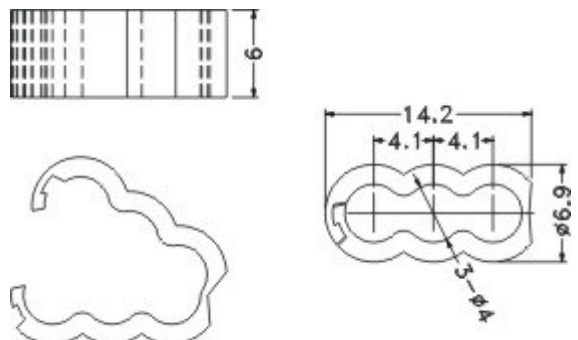

UNIT FOLDED VIEW

WIRE SADDLE

CD-3.4

MATERIAL: NYLON 66 (UL)
 FLAME CLASS: 94V-2
 COLOR: BLACK
 UNIT: mm

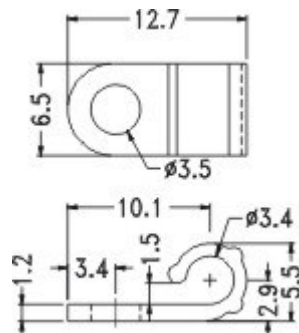

| PARTNO | PACKAGE |
|--------|---------|
| CD-3.4 | 500 |

WIRE SADDLE

WCL-2

MATERIAL: NYLON 66 (UL)
 FLAME CLASS: 94V-2
 COLOR: NATURAL
 UNIT: mm

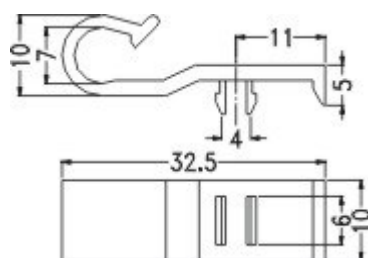

| PARTNO | PACKAGE |
|--------|---------|
| WCL-2 | 500 |

WIRE SADDLE

W2LK-1

MATERIAL: NYLON 66 (UL)
 FLAME CLASS: 94V-2
 COLOR: NATURAL
 UNIT: mm

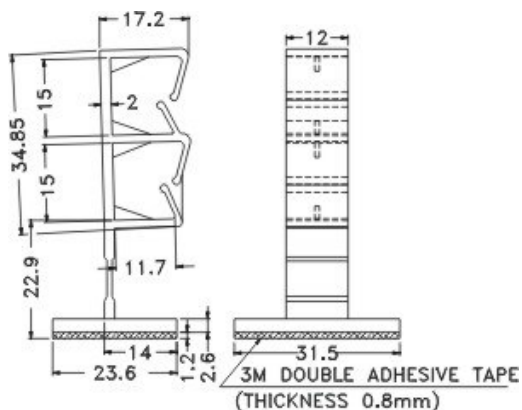

| PARTNO | PACKAGE |
|--------|---------|
| W2LK-1 | 50 |

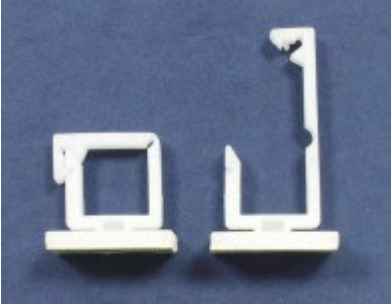

WIRE SADDLE

WLN-3

MATERIAL: NYLON 66 (UL)
 FLAME CLASS: 94V-2
 COLOR: NATURAL
 UNIT: mm

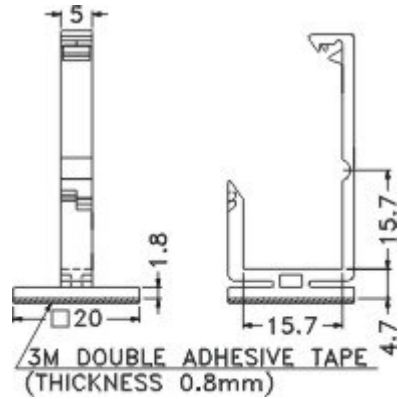

| PARTNO | PACKAGE |
|--------|---------|
| WLN-3 | 500 |

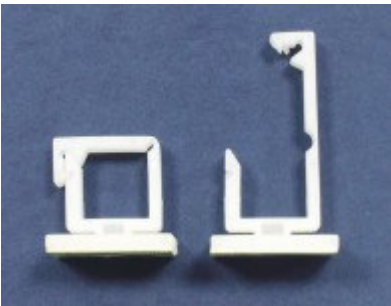

WIRE SADDLE

WLN-2

MATERIAL: NYLON 66 (UL)
 FLAME CLASS: 94V-2
 COLOR: NATURAL
 UNIT: mm

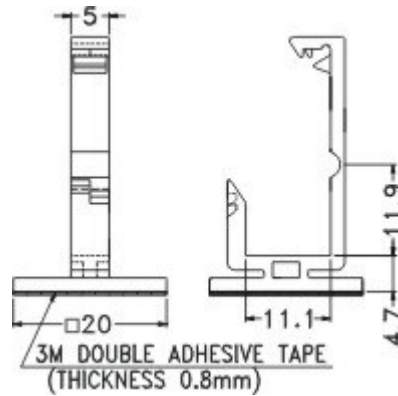

| PARTNO | PACKAGE |
|--------|---------|
| WLN-2 | 500 |

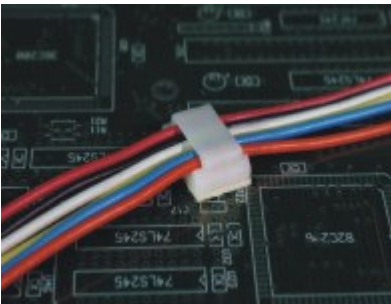

WIRE SADDLE

MWS

MATERIAL: NYLON 66 (UL)
 FLAME CLASS: 94V-2
 COLOR: NATURAL
 UNIT: mm

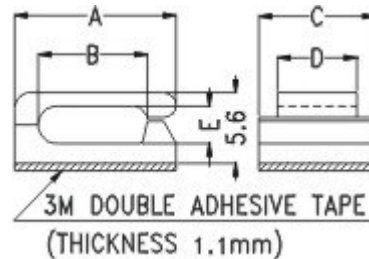

| PARTNO | A | B | C | D | E | PACKAGE |
|--------|------|------|------|-----|-----|---------|
| MWS-2 | 13.0 | 8.5 | 9.2 | 6.3 | 3.0 | 1000 |
| MWS-3 | 16.0 | 11.5 | 13.0 | 9.0 | 2.9 | |

WIRE SADDLE

WSB-1

MATERIAL: NYLON 66 (UL)
 FLAME CLASS: 94V-2
 COLOR: NATURAL
 UNIT: mm

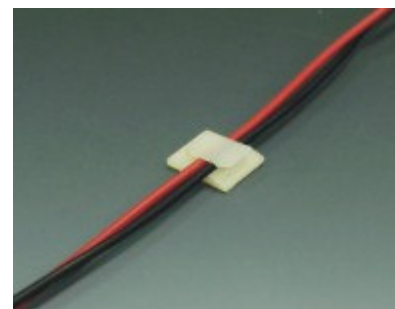
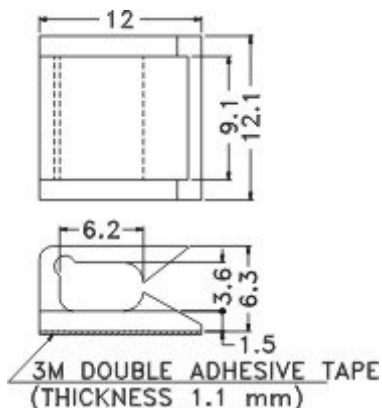

| PARTNO | PACKAGE |
|--------|---------|
| WSB-1 | 1000 |

WIRE SADDLE

WCLA-1

MATERIAL: NYLON 66 (UL)
 FLAME CLASS: 94V-2
 COLOR: NATURAL
 UNIT: mm

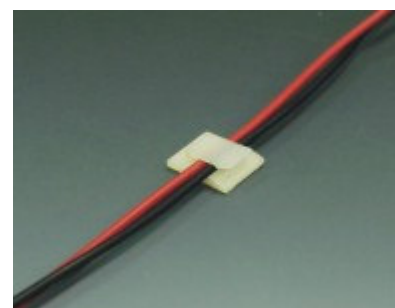
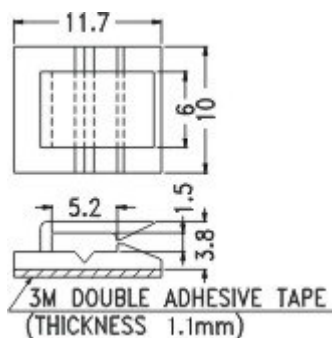

| PARTNO | PACKAGE |
|--------|---------|
| WCLA-1 | 1000 |

WIRE SADDLE

WCL

MATERIAL: NYLON 66 (UL)
 FLAME CLASS: 94V-2
 COLOR: NATURAL / BLACK
 UNIT: mm

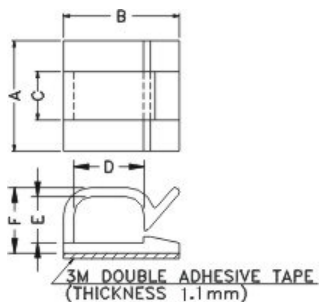

| PART NO. | A | B | C | D | E | F | PACKAGE |
|----------|------|------|-----|------|-----|------|---------|
| WCL-4 | 16.0 | 14.4 | 7.1 | 8.2 | 5.2 | 8.0 | 1000 |
| WCL-5 | 16.0 | 16.8 | 7.0 | 10.2 | 6.7 | 9.5 | 500 |
| WCL-6 | 19.0 | 19.0 | 9.7 | 12.5 | 8.1 | 11.0 | |
| WCL-7 | 19.0 | 20.8 | 9.0 | 13.6 | 8.2 | 11.3 | |

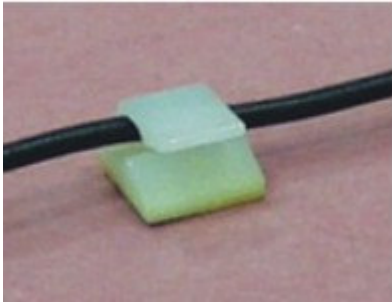

WIRE SADDLE

WC-6

MATERIAL: NYLON 66 (UL)
 FLAME CLASS: 94V-2
 COLOR: NATURAL
 UNIT: mm

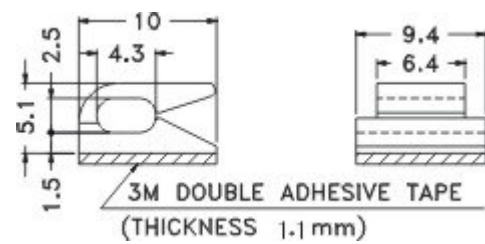

| PARTNO | PACKAGE |
|--------|---------|
| WC-6 | 1000 |



WIRE SADDLE

WC-5

MATERIAL: NYLON 66 (UL)
 FLAME CLASS: 94V-2
 COLOR: NATURAL / BLACK
 UNIT: mm

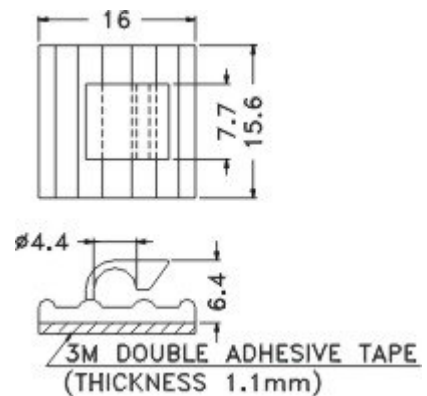

| PARTNO | PACKAGE |
|--------|---------|
| WC-5 | 1000 |